

PLAN

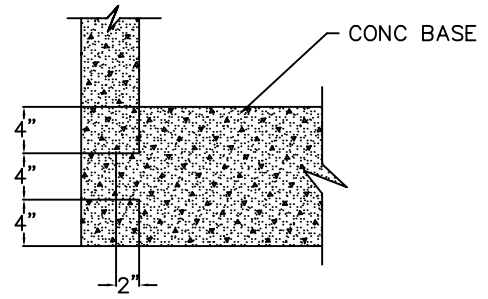

DETAIL "A"

WEEP HOLE
14-2 1/4" SQUARE OR 2 3/8" ROUND
HOLES, EQUALLY SPACED OR
APPROVED EQUAL.

STANDARD MANHOLE
FRAME AND COVER

GRADE RINGS
MINIMUM 3"
MAXIMUM 12"

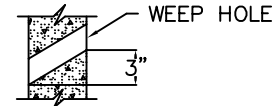

DETAIL "B"

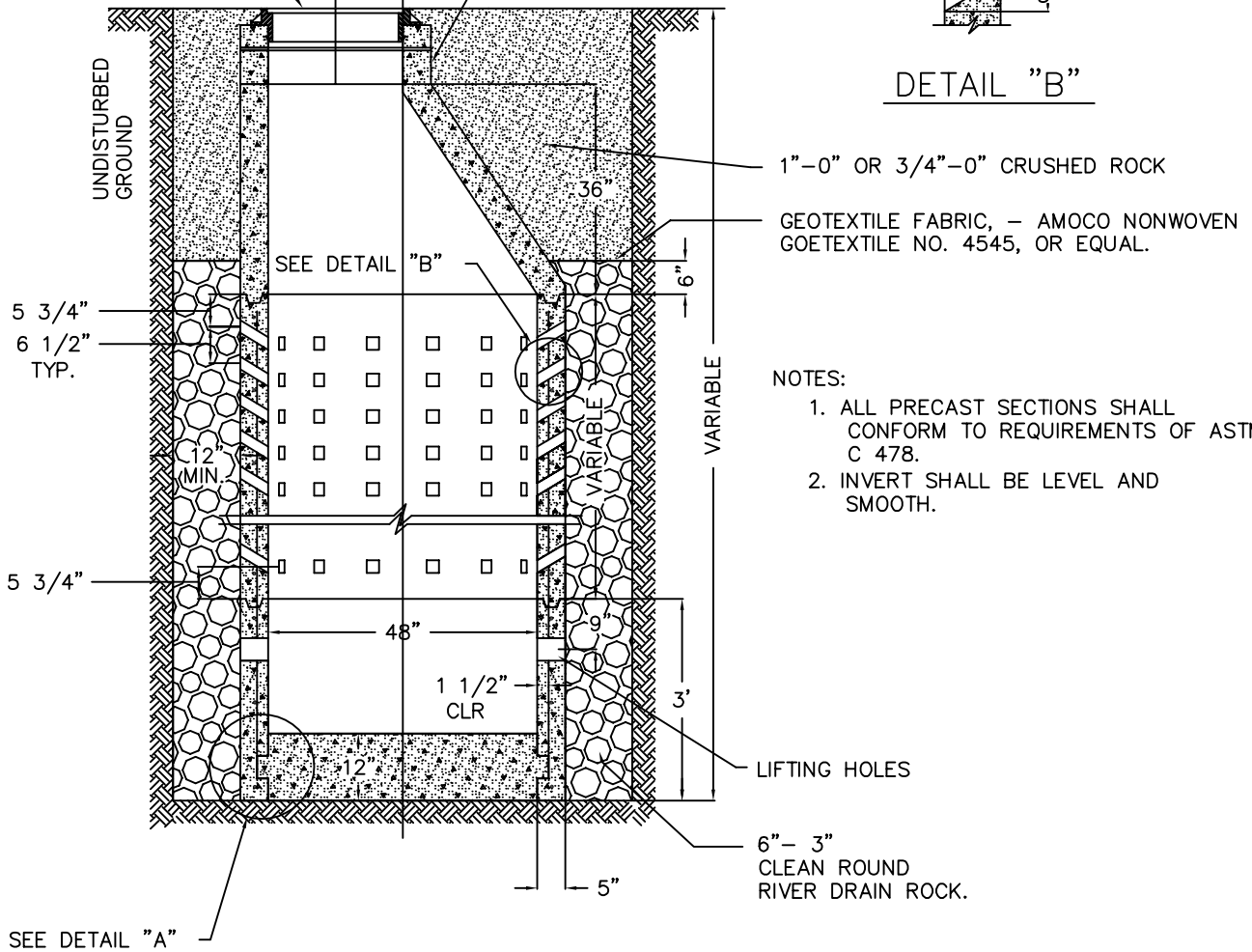

SECTION A-A

NOTES:

1. ALL PRECAST SECTIONS SHALL CONFORM TO REQUIREMENTS OF ASTM C 478.
2. INVERT SHALL BE LEVEL AND SMOOTH.

NOTE:

1. USE OF DRYWELL IS ONLY PERMITTED ON PRIVATELY OWNED AND MAINTAINED FACILITIES.
2. RUNOFF FROM PUBLIC R-O-W IS NOT PERMITTED TO DRAIN TO DRYWELLS.
3. DRYWELL MUST BE REGISTERED AND/OR PERMITTED BY THE STATE OF OREGON AS AN UNDERGROUND INJECTION CONTROL DEVICE.