



Procurement Division
Public Services Building
2051 Kaen Road
Oregon City, OR 97045
(503) 742-5444 (Office)

REQUEST FOR QUOTES (RFQ) #2018-128

Issue Date: December 31, 2018

Project Name:	CBX Wilsonville School District Rosemont Extension		
Quote Due Date/Time:	January 30, 2019, 2:00 PM		
Procurement Analyst:	Ryan Rice	Phone:	503-742-5446
		Email:	rrice@clackamas.us

**SUBMIT QUOTES VIA EMAIL TO PROCUREMENT@CLACKAMAS.US
OR MAIL/HAND DELIVERY TO THE ABOVE ADDRESS**

**PLEASE NOTE: EMAIL SUBMISSIONS SHOULD HAVE
“2018-128 CBX ROSEMONT EXTENSION” IN THE SUBJECT LINE**

1. ANNOUNCEMENT AND SPECIAL INFORMATION

Quoters are required to read, understand, and comply with all information contained within this Request for Quotes (“RFQ”). All quotes are binding upon Quoter for sixty (60) days from the Quote Due Date/Time. Quotes received after the Quote Due Date/Time may not be considered. If authorized in the RFQ and resulting contract, travel and other expense reimbursement will only be reimbursed in accordance with the Clackamas County Travel Reimbursement Policy in effect at the time the expense is incurred. The Policy may be found at www.clackamas.us/bids/terms.html.

It will be the responsibility of potential Quoters to refer daily to the Bids and Contract Information Page (www.clackamas.us/bids/index.html) to check for any available addenda, response to clarifying questions, cancellations or other information pertaining to this RFQ.

All questions regarding this RFQ are to be directed to the Procurement Analyst named above. Quoters may not communicate with County employees or representatives about the RFQ during the procurement process until the Procurement office has notified Quoters of the selected Quoter. Communication in violation of this restriction may result in rejection of a Quoter.

2. SCOPE

The purpose of this RFQ is to close a loop within the current CBX network by extending fiber from Stafford and Rosemont to Trillium Creek Primary in West Linn-Wilsonville School District.

Project Description:

From existing aerial splice case near round-about at Stafford Road and Rosemont Road, overlash existing cable with the 96ct east down Rosemont. After the strand and lash section, continue down Rosemont with ADSS attachments. At PGE Pole #3942, mid-sheath existing FO96 ADSS cable, place FOSC450D case.

Project Location:

Rosemont Road, West Linn, OR

Splicing Requirements:

- Existing aerial splice case FOSC450D: 48x splices
- New aerial splice case FOSC450D (midsheath): 48x splices

Material Requirements:

- Fiber Optic Cable: 96ct Singlemode, ADSS – CBX provided
- Splice Case: FOSC450D – contractor provided
- Conduit: N/A
- Vaults: N/A
- Risers: first 10ft from ground should be galvanized pipe
- Strand: 5/16” downguys, fiber is ADSS
- Premise Terminations: N/A
- Place any required down guys and overhead guys per NESC

General Requirements:

1. All material and equipment needed to complete this project will be supplied by the contractor.
2. All utility make-ready costs will be the responsibility of Clackamas CBX.
3. City and ODOT permit will be provided by CBX.
4. Contractor will be responsible for developing an approved traffic control plan. **All flagging costs need to be included in the quote.**
5. All fiber cables need to be labeled in every splice case and vault for future reference. CBX will provide the fiber tags.
6. All disturbed areas shall be restored to an in-kind or better condition.
7. Place locate wire in all conduit that fiber is placed in.
8. CBX is not responsible for extra costs due to Subcontractors’ failure to review complete plans, drawings and specifications.
9. Quotes in excess of \$50,000.00, performance and payment bonds will be a required part of the final Contract.
10. Should quotes exceed \$100,000.00 a bid bond shall accompany vendor quote.

Key Dates:

Commencement Date: Upon Issuance of Notice to Proceed (“NTP”)

Substantial Completion: April 1, 2019

Final Completion: May 31, 2019

Engineers Estimate: \$80,000.00

The following items are included and incorporated within this RFQ:

- CLACKAMAS COUNTY CBX FIBER-ROSEMONT RD CONSTRUCTION DRAWINGS: STAFFORD TO BAY MEADOWS WEST LINN, OR SHEETS 1-28.

Prevailing Wage:

Prevailing Wage Rates requirements apply to this project because the maximum compensation for all owner-contracted work is more than \$50,000. The selected contractor and all subcontractors shall comply with the provision of ORS 279C.800 through 279C.870, relative to the Prevailing Wage Rates and the required public works bond.

PREVAILING WAGE RATES for Public Works Contracts in Oregon, January 1, 2019, which can be downloaded at the following web address:

http://www.oregon.gov/boli/WHD/PWR/Pages/pwr_state.aspx.

The Work will take place in Clackamas County, Oregon.

3. Sample Contract

Submission of a Quote in response to this RFQ indicates Quoter’s willingness to enter into a contract containing substantially the same terms of the **Public Improvement** contract, which can be found at: <http://www.clackamas.us/bids/terms.html>.

No action or response to the sample contract is required under this RFQ.

4. Quote

Quotes should be short and concise with the following information:

- A. Lump Sum price to complete the project presented on company letterhead;
- B. Estimated time to complete the project;
- C. Bid Bond (Should quote be in excess of \$100,000.00);
- D. Clackamas County Certifications Form; and
- E. Any additional information that Clackamas County should take into consideration for the project or qualifications.

5. Evaluation

The quote received from the lowest responsive responsible Quoter will be awarded a contract. The "lowest responsive responsible Quoter" is the lowest Quoter who has substantially complied with all requirements of the Request for Quote and who can be expected to deliver promptly and perform reliably in the determination of Clackamas County.

CLACKAMAS COUNTY CERTIFICATIONS
RFQ #2018-128

Each Quoter must read, complete and submit a copy of this Clackamas County Certification with their Quote. Failure to do so may result in rejection of Quote. By signature on this Certification the undersigned certifies that they are authorized to act on behalf of the Quoter and that under penalty of perjury the undersigned will comply with the following:

SECTION I. OREGON TAX LAWS

As required in ORS 279B.110(2)(3), the undersigned hereby certifies that, to the best of the undersigned's knowledge, the Quoter is not in violation of any Oregon Tax Laws. For purposes of this certification, "Oregon Tax Laws" means a state tax imposed by ORS 320.005 to 320.150 and 403.200 to 403.250 and ORS chapters 118, 314, 316, 317, 318, 321, 323, and elderly rental assistance program under ORS 310.630 to 310.706, and local taxes administered by the Department of Revenue under ORS 305.620, all as applicable. If a contract is executed, this information will be reported to the Internal Revenue Service. Information not matching IRS records could subject Quoter to 28% backup withholding.

SECTION II. NON-DISCRIMINATION

The undersigned hereby certifies that the Quoter has not and will not discriminate in its employment practices with regard to race, creed, age, religious affiliation, sex, disability, sexual orientation, national origin, or any other protected class. Nor has Quoter or will Quoter discriminate against a subcontractor in the awarding of a subcontract because the subcontractor is a disadvantaged business enterprise, a minority-owned business, a woman-owned business, a business that a service-disabled veteran owns or an emergency small business that is certified under ORS 200.055.

SECTION III. CONFLICT OF INTEREST

The undersigned hereby certifies that no elected official, officer, agency or employee of Clackamas County is personally interested, directly or indirectly, in any resulting contract from this RFQ, or the compensation to be paid under such contract, and that no representation, statements (oral or in writing), of the County, its Commissioners, officers, agents, or employees had induced Quoter to submit this Quote. In addition, the undersigned hereby certifies that this proposal is made without connection with any person, firm, or corporation submitting a quote for the same material, and is in all respects fair and without collusion or fraud.

SECTION IV. COMPLIANCE WITH SOLICITATION

The undersigned further agrees and certifies that they:

1. Have read, understand and agree to be bound by and comply with all requirements, instructions, specifications, terms and conditions of the RFQ (including any attachments); and
2. Are an authorized representative of the Quoter, that the information provided is true and accurate, and that providing incorrect or incomplete information may be cause for rejection of the Quote or contract termination; and
3. Will furnish the designated item(s) and/or service(s) in accordance with the RFQ and Quote; and
4. Will use recyclable products to the maximum extent economically feasible in the performance of the contract work set forth in this RFQ.

Firm Name: _____ Date: _____

Signature: _____ Title: _____

Name: _____ Telephone: _____

Email: _____ OR CCB # (if applicable): _____

Business Designation (check one):

☐ Corporation ☐ Partnership ☐ Sole Proprietorship ☐ Non-Profit ☐ Limited Liability Company

☐ Resident Quoter, as defined in ORS 279A.120

☐ Non-Resident Quote. Resident State: _____

Oregon Business Registry Number: _____

CLACKAMAS COUNTY INSTRUCTIONS TO QUOTERS

Quotes are subject to the applicable provisions and requirements of the Clackamas County Local Contract Review Board Rule C-047-0270 (Intermediate Procurements) and Oregon Revised Statutes.

QUOTE PREPARATION

1. **QUOTE FORMAT:** Quotes must be submitted as indicated in the RFQ.
2. **CONFORMANCE TO RFQ REQUIREMENTS:** Quotes must conform to the requirements of the RFQ. Unless otherwise specified, all items quoted are to be new, unused and not remanufactured in any way. Any requested attachments must be submitted with the quote and in the required format. Quote prices must be for the unit indicated on the quote. Failure to comply with all requirements may result in quote rejection.
3. **ADDENDA:** Only documents issued as addenda by Clackamas County serve to change the RFQ in any way. No other directions received by the Quoter, written or verbal, serve to change the RFQ document. NOTE: IF YOU HAVE RECEIVED A COPY OF THE RFQ, YOU SHOULD CONSULT THE CLACKAMAS COUNTY BIDS AND CONTRACT INFORMATION WEBSITE (www.clackamas.us/bids/index.html) TO ENSURE THAT YOU HAVE NOT MISSED ANY ADDENDA OR ANNOUNCEMENTS. QUOTERS ARE NOT REQUIRED TO RETURN ADDENDUMS WITH THEIR QUOTE. HOWEVER, QUOTERS ARE RESPONSIBLE TO MAKE THEMSELVES AWARE OF, OBTAIN AND INCORPORATE ANY CHANGES MADE IN ANY ADDENDA ISSUED, AND TO INCORPORATE ANY CHANGES MADE BY ADDENDUM INTO THEIR FINAL QUOTE. FAILURE TO DO SO MAY, IN EFFECT, MAKE THE QUOTER'S QUOTE NON-RESPONSIVE, WHICH MAY CAUSE THE QUOTE TO BE REJECTED.
4. **USE of BRAND or TRADE NAMES:** Any brand or trade names used by Clackamas County in the specifications are for the purpose of describing and establishing the standard of quality, performance and characteristics desired and are not intended to limit or restrict competition. Quoters may submit quotes for substantially equivalent products to those designated unless the RFQ provides that a specific brand is necessary because of compatibility requirements, etc. All such brand substitutions shall be subject to approval by Clackamas County.
5. **PRODUCT IDENTIFICATION:** Quoters must clearly identify all products quoted. Brand name and model or number must be shown. Clackamas County reserves the right to reject any quote when the product information submitted with the quote is incomplete.
6. **FOB DESTINATION:** Unless specifically allowed in the RFQ, ***QUOTE PRICE MUST BE F.O.B. DESTINATION with all transportation and handling charges included in the Quote.***
7. **DELIVERY:** Delivery time must be shown in number of calendar days after receipt of purchase order.
8. **EXCEPTIONS:** Any deviation from quote specifications, or the form of sample contract referenced in this RFQ, may result in quote rejection at County's sole discretion.
9. **SIGNATURE ON QUOTE:** Quotes must be signed by an authorized representative of the Quoter. Signature on a quote certifies that the quote is made without connection with any person, firm or corporation making a quote for the same goods and/or services and is in all respects fair and without collusion or fraud. Signature on a quote also certifies that the Quoter has read and fully understands all quote specifications, and the sample contract referenced in this RFQ (including insurance requirements). No consideration will be given to any claim resulting from quoting without comprehending all requirements of the RFQ.
10. **QUOTE MODIFICATION:** Quotes, once submitted, may be modified in writing before the time and date set for quote closing. Any modifications should be signed by an authorized representative, and state that the new document supersedes or modifies the prior quote. Quoters may not modify quotes after quote closing time.
11. **QUOTE WITHDRAWALS:** Quotes may be withdrawn by request in writing signed by an authorized representative and received by Clackamas County prior to the Quote Due Date/Time. Quotes may also be withdrawn in person before the Quote Due Date/Time upon presentation of appropriate identification.

- 12. QUOTE SUBMISSION:** Quotes may be submitted by returning to Clackamas County Procurement Division in the location designated in the introduction of the RFQ; however, no oral or telephone quotes will be accepted. Envelopes, or e-mails containing Quotes should contain the RFQ Number and RFQ Title.

QUOTE EVALUATION AND AWARD

- 1. PRIOR ACCEPTANCE OF DEFECTIVE PROPOSALS:** Due to limited resources, Clackamas County generally will not completely review or analyze quotes which fail to comply with the requirements of the RFQ or which clearly are not the best quotes, nor will Clackamas County generally investigate the references or qualifications of those who submit such quotes. Therefore, neither the return of a quote, nor acknowledgment that the selection is complete shall operate as a representation by Clackamas County that an unsuccessful quote was complete, sufficient, or lawful in any respect.
- 2. DELIVERY:** Significant delays in delivery may be considered in determining award if early delivery is required.
- 3. CASH DISCOUNTS:** Cash discounts will not be considered for award purposes unless stated in the RFQ.
- 4. PAYMENT:** Quotes which require payment in less than 30 days after receipt of invoice or delivery of goods, whichever is later, may be rejected.
- 5. INVESTIGATION OF REFERENCES:** Clackamas County reserves the right to investigate references and or the past performance of any Quoter with respect to its successful performance of similar services, compliance with specifications and contractual obligations, and its lawful payment of suppliers, sub-contractors, and workers. Clackamas County may postpone the award or execution of the contract after the announcement of the apparent successful Quoter in order to complete its investigation. Clackamas County reserves the right to reject any quote or to reject all quotes at any time prior to Clackamas County's execution of a contract if it is determined to be in the best interest of Clackamas County to do so.
- 6. METHOD OF AWARD:** Clackamas County reserves the right to make the award by item, groups of items or entire quote, whichever is in the best interest of Clackamas County.
- 7. QUOTE REJECTION:** Clackamas County reserves the right to reject any and all quotes.
- 8. QUOTE RESULTS:** Quoters who submit a quote will be notified of the RFQ results. Awarded quote files are public records and available for review by submitting a public records request or by appointment.



**CLACKAMAS COUNTY
PUBLIC IMPROVEMENT CONTRACT**

BID BOND

Project Name: #2018-128 CBX Wilsonville School District Rosemont Extension

We, _____, as "Principal,"
(Name of Principal)

and _____, an _____ Corporation,
(Name of Surety)

authorized to transact Surety business in Oregon, as "Surety," hereby jointly and severally bind ourselves, our respective heirs, executors, administrators, successors and assigns to pay unto Clackamas County ("Obligee") the sum of (\$_____)

_____ dollars.

WHEREAS, the condition of the obligation of this bond is that Principal has submitted its proposal or bid to an agency of the Obligee in response to Obligee's procurement document (No. _____) for the project identified above which proposal or bid is made a part of this bond by reference, and Principal is required to furnish bid security in an amount equal to ten (10%) percent of the total amount of the bid pursuant to the procurement document.

NOW, THEREFORE, if the Obligee shall accept the bid of the Principal and the Principal shall enter into a Contract with the Obligee in accordance with the terms of such bid, and give such bond or bonds as may be specified in the bidding or Contract Documents with good and sufficient surety for the faithful performance of such Contract and for the prompt payment of labor and material furnished in the prosecution thereof, or in the event of the failure of the Principal to enter such Contract and give such bond or bonds, if the Principal shall pay to the Obligee the difference not to exceed the penalty hereof between the amount specified in said bid and such larger amount for which the Obligee may in good faith contract with another party to perform the Work covered by said bid, then this obligation shall be null and void, otherwise to remain in full force and effect.

IN WITNESS WHEREOF, we have caused this instrument to be executed and sealed by our duly authorized legal representatives this _____ day of _____, 20____.

Principal: _____ Surety: _____

By: _____
Signature

By: Attorney-In-Fact

Official Capacity

Name

Attest: _____
Corporation Secretary

Address

City State Zip

Phone Fax

CLACKAMAS COUNTY CBX FIBER- ROSEMONT RD

SW STAFFORD RD TO BAY MEADOWS DR
WEST LINN, OR

CONTACTS

DUKE DEXTER
CBX PROGRAM MANAGER
121 LIBRARY CT
OREGON CITY, OR 97405
PH: 503-722-6663
DDexter@co.clackamas.or.us

SHEET INDEX

No.	DESCRIPTION
1	COVER
2	STANDARD LEGEND
3	GENERAL NOTES AND TYPICAL TRENCH DETAILS
4-28	PLAN - ROSEMONT RD

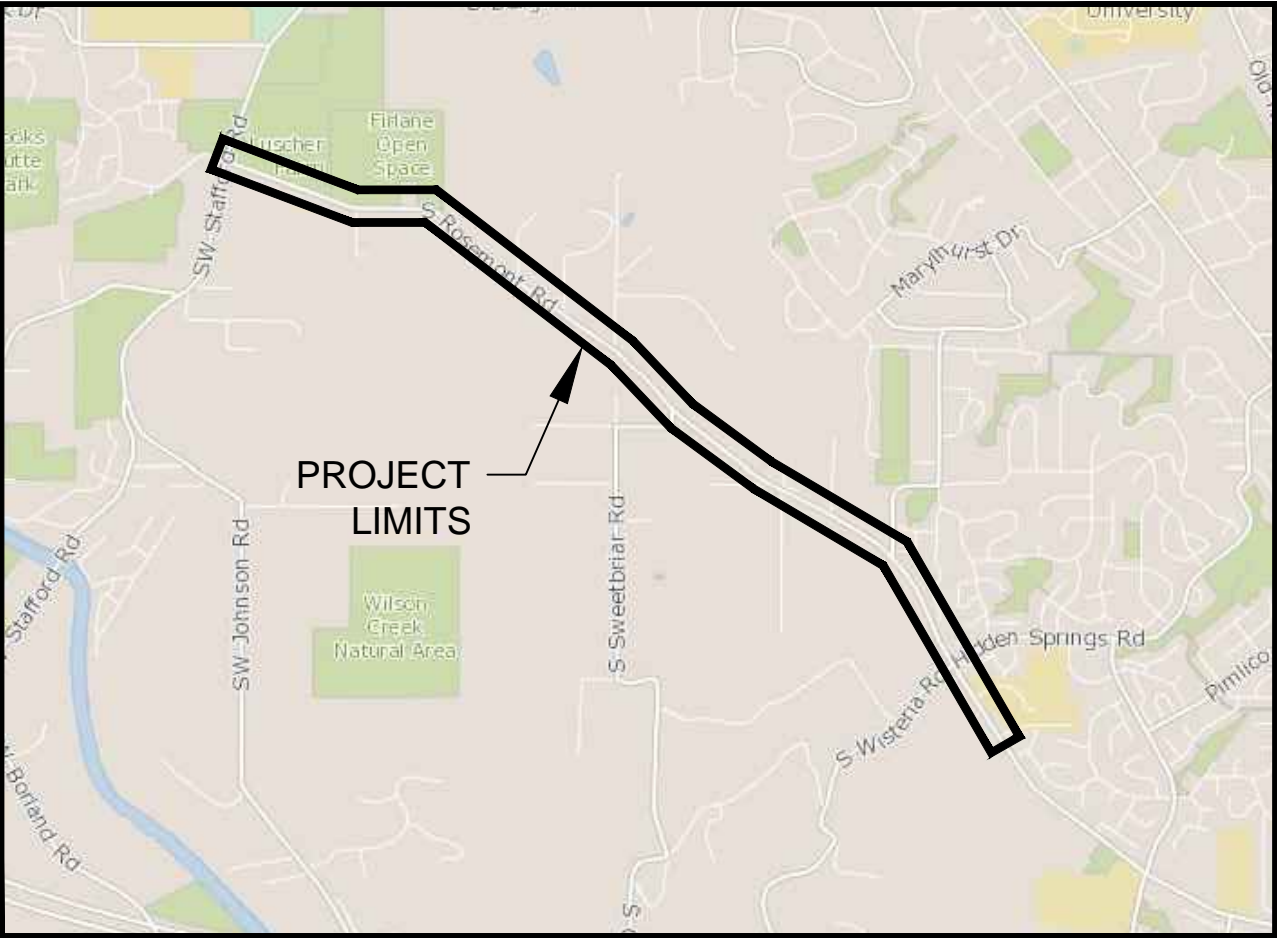

VICINITY MAP



6611 NE CHESTNUT ST
HILLSBORO, OR
PH: 503.730.1919
FAX: 503.640.0499
topcomllc.com

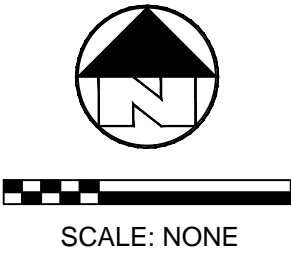

TWN: 2S
SEC:
RNG: 1E
DSNR: SL
FLDR: SL
DRWN: TAP
DATE: 12-1-18

DIAL **811**
CALL LOCATE
BEFORE YOU
DIG

OR-CLCK-242

SHT 1
OF 28

TYPICAL LINE TYPES

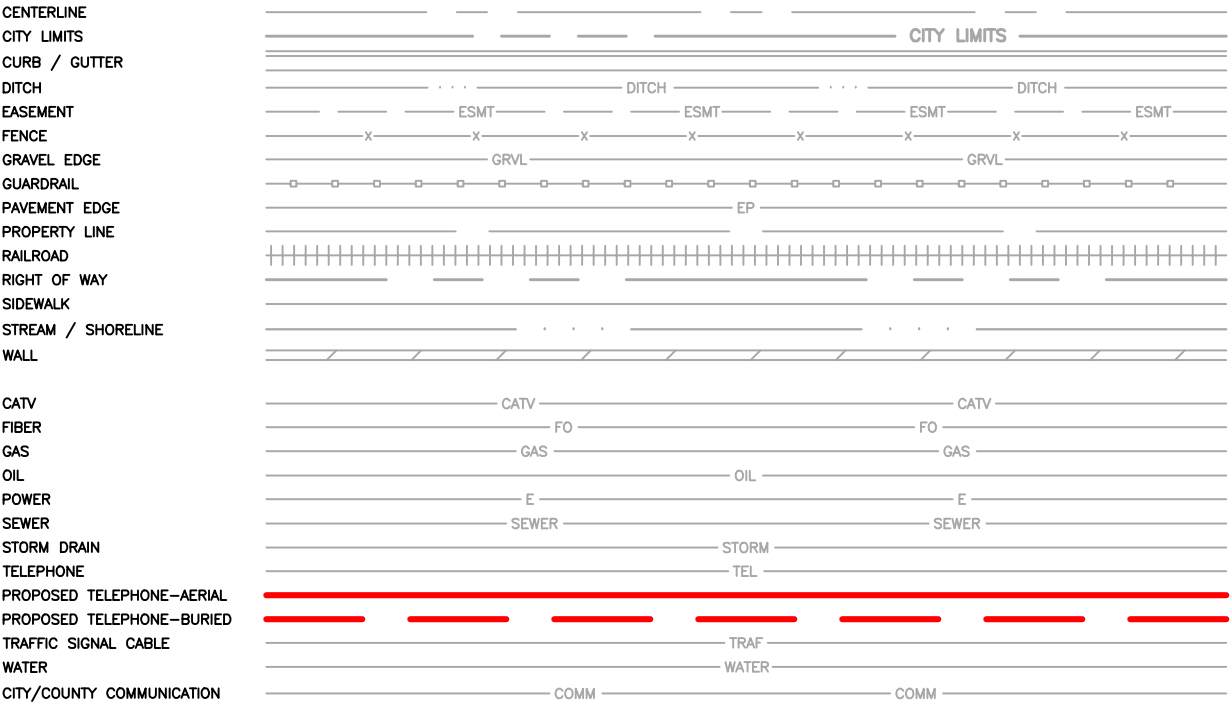

STANDARD ABBREVIATIONS

CABLE ARM ATTACHMENT LOCATION:			
TF	TOP FIELD SIDE	ANC	ANCHOR
TS	TOP STREET SIDE	ARM	CABLE ARM
TIP	TOP INSIDE POSITION	X-ARM	CROSS ARM
TIS	TOP INSIDE STREET SIDE	DG	DOWN GUY
TMP	TOP MIDDLE POSITION	DGA	DOUBLE GUARD ARM
TOP	TOP OUTSIDE POSITION	FGA	FIBER GLASS ARM
TOS	TOP OUTSIDE STREET SIDE	FS	FIELD SIDE
BF	BOTTOM FIELD SIDE	GA	GUARD ARM
BS	BOTTOM STREET SIDE	HOA	HEIGHT OF ATTACHMENT
BIP	BOTTOM INSIDE POSITION	POA	POINT OF ATTACHMENT
BIS	BOTTOM INSIDE STREET SIDE	OHG	OVERHEAD GUY
BMP	BOTTOM MIDDLE POSITION	RS	ROAD SIDE
BOP	BOTTOM OUTSIDE POSITION	SLAN	LIGHT OR POWER COMPANY INVENTORY NUMBER
BOS	BOTTOM OUTSIDE STREET SIDE	SWA	SIDEWALK ANCHOR AND GUY
		PUPI	PUPI ARM
PL	PLACE	TERM	TERMINAL
EX	EXISTING	TRANS	TRANSFORMER
(#)	NUMBER OF ITEMS	TAPE & SHAPE	REQUEST FOR POWER COMPANY TO CLEAN UP SECONDARY POWER CABLES AND/OR TOP OF RISER CABLES SO PROPOSED CABLE CAN BE ATTACHED WITHOUT VIOLATING THE 40" RULE

STANDARD BUILD

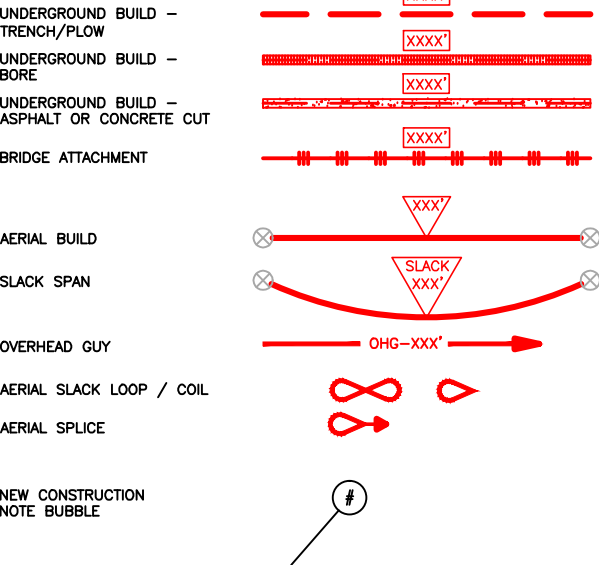

SYMBOL LEGEND

MONUMENT / BRASS CAP

THRU CURB INLET

CATCH BASIN - RECTANGLE

CATCH BASIN - ROUND

STORM DRAIN MANHOLE

SEWER CLEANOUT

SEWER MANHOLE

GAS HAND HOLE

GAS METER

GAS VALVE

AIR-VAC ASSEMBLY

WATER MANHOLE

WATER VAULT

WATER VALVE

FIRE HYDRANT

BLOW-OFF / FDC (FIRE)

WATER METER

CATV HAND HOLE

CATV PEDESTAL

POWER MANHOLE

POWER CABINET

POWER SWITCHGEAR

POWER TRANSFORMER

POWER HAND HOLE

POWER METER

POWER PEDESTAL

POWER J-BOX

STREET LIGHT

TRAFFIC SIGNAL CONTROL CABINET

TRAFFIC SIGNAL POLE

TRAFFIC SIGNAL LOOP J-BOX

TRAFFIC SIGNAL HAND HOLE

TELEPHONE POLE - EXISTING

JOINT USE POLE - EXISTING

TELEPHONE REPEATER - EXISTING

TELEPHONE PEDESTAL - EXISTING

TELEPHONE COOL PED - EXISTING

TELEPHONE SAI - EXISTING

TELEPHONE CABINET - EXISTING

TELEPHONE HAND HOLE - EXISTING

TELEPHONE MANHOLE - EXISTING

NEW POLE

17x30 HAND HOLE - NEW

30x48 HAND HOLE - NEW

264-TA HAND HOLE - NEW

TELEPHONE MANHOLE - NEW

TELEPHONE CABINET - NEW

TELEPHONE COOL PED - NEW

TELEPHONE SAI - NEW

BORE PIT

UTILITY POT HOLE LOCATION

TELEPHONE DOWNGUY ONLY - NEW

TELEPHONE ANCHOR - NEW

ANCHOR - EXISTING OTHER

CULVERT

TRAFFIC SIGN

FLAG POLE

TREE

CELL TOWER



6611 NE CHESTNUT ST
HILLSBORO, OR
PH: 503.730.1919
FAX: 503.640.0499

topcomllc.com

SCALE: NONE

TWN: 2S
SEC:
RNG: 1E
DSNR: SL
FLDR: SL
DRWN: TAP
DATE: 12-1-18

ROSEMONT RD
CBX FIBER
STAFFORD TO BAY MEADOWS
WEST LINN, OR

DIAL 811
CALL LOCATE
BEFORE YOU
DIG

OR-CLCK-242
SHT 2
OF 28

GENERAL NOTES:

1. CALL UTILITY LOCATE AT 811 72 HOURS PRIOR TO TRENCHING OR DIGGING.
2. THE EXISTENCE AND LOCATION OF ANY UNDERGROUND UTILITY PIPES OR STRUCTURES SHOWN ON THESE PLANS WERE OBTAINED BY FIELD INSPECTION AND A SEARCH OF THE AVAILABLE CITY OR COUNTY RECORDS. SINCE THE ACTUAL LOCATION AND NATURE OF THE UNDERGROUND FACILITIES MAY BE SOMEWHAT DIFFERENT FROM THAT SHOWN, THE CONTRACTOR IS REQUIRED TO VERIFY PRIOR TO EXCAVATION.
3. THE RIGHT-OF-WAY SHOWN HAS NOT BEEN SURVEYED OR TIED. RIGHT-OF-WAY LOCATION IS ASSUMED WITH REFERENCE TO ONLINE DATA SOURCE MATERIAL. CONTRACTOR TO VERIFY ALL RIGHTS-OF-WAY AND/OR EASEMENTS PRIOR TO CONSTRUCTION.
4. FOR UNDERGROUND ACTIVITY: TEST AND VENTILATE MANHOLE/UTILITY VAULT PRIOR TO ENTRY, PLACE WARNING DEVICES AND WORK AREA PROTECTION AS REQUIRED, AND USE EYE AND HEAD SAFETY PROTECTION PER FEDERAL, STATE, AND LOCAL REGULATIONS.
5. ALL EXCAVATION, TRENCHING, AND SHORING IS TO ADHERE TO THE CODE OF FEDERAL REGULATIONS (CFR) 1926.650 SUBPART P.

a. PROVIDE ALL PITS WITH 1’x1’ SLOPE AT ONE END OF EXCAVATION FOR TECHNICIAN INGRESS/EGRESS.

b. EXCAVATED SPOILS ARE TO BE NO LESS THAN 24” FROM EDGE OF PIT OR TRENCH.

c. BARRICADE ALL OPEN PITS AND TRENCHING FOR PUBLIC SAFETY. ALL BARRICADES MUST BE EQUIPPED WITH FLASHING LIGHTS FOR NIGHT VISIBILITY.

d. FOR PITS GREATER THAN 4’ IN DEPTH, USE APPROPRIATE SHORING FOR WALL STABILITY.
6. TRENCH COVER IS TO BE 36” MINIMUM AND FREE OF ROCKS, DEBRIS, AND CLODS. THE TRENCH IS TO BE A MINIMUM OF 36” COVER IN DEVELOPED AREAS AND A MINIMUM OF 48” OF COVER IN UNDEVELOPED AREAS (ANY VARIANCE FROM THESE STANDARDS WILL BE SPECIFIED ON THE PLANS).
7. ALL ASPHALT/CONCRETE AND LANDSCAPING REMOVED, DISTURBED, OR DAMAGED AS A RESULT OF CONSTRUCTION SHALL BE RESTORED TO ORIGINAL CONDITION OR BETTER IN ACCORDANCE WITH JURISDICTIONAL AGENCY STANDARDS AND SPECIFICATIONS.
8. NORMAL/GUIDED-BORING METHOD RECOMMENDED WHEN BORING.
9. ADHERE TO AIRTIGHT GUIDELINES UNLESS OTHERWISE NOTED.
10. BOND BURIED/AERIAL FACILITIES AS REQUIRED BY JURISDICTIONAL AGENCY(S).
11. AERIAL FACILITIES ARE TO BE TESTED PRIOR TO BEGINNING WORK PER STATE AND LOCAL REGULATIONS.
12. ALL WORK AREA PROTECTIONS FOR TRAFFIC CONTROL IS TO BE WITH APPROVED WARNING DEVICES AND PLACED PER STATE DEPARTMENT OF TRANSPORTATION AND/OR PUBLIC WORKS ENGINEERING DEPARTMENT STANDARDS AND SPECIFICATIONS. IF REQUIRED, A TRAFFIC CONTROL PLAN SHALL BE SUBMITTED TO THE REQUESTING PERMITTING AGENCY. PRIOR TO BEGINNING WORK, PERMITTING AGENCIES MUST BE NOTIFIED 48 HOURS IN ADVANCE OF CONSTRUCTION ACTIVITIES.
13. EXISTING PEDESTRIAN CROSSWALKS AND WALKING AREAS SHALL BE MAINTAINED AT ALL TIMES. AS NECESSARY, TEMPORARY PEDESTRIAN CROSSWALKS AND WALKING AREAS SHALL BE PROVIDED AND MAINTAINED PER STATE DEPARTMENT OF TRANSPORTATION AND/OR PUBLIC WORKS ENGINEERING DEPARTMENT STANDARDS AND SPECIFICATIONS.
14. THE FOLLOWING FOOTAGES ARE ESTIMATES. FOOTAGES TO BE VERIFIED PRIOR TO CONSTRUCTION.

AERIAL ONLY

NOTE:
CONTRACTOR OR HIS AGENTS SHALL NOT ENTER OR ENCROACH UPON PRIVATE PROPERTY WITHOUT NOTIFYING THE PROPERTY OWNER A MINIMUM OF 72-HOURS IN ADVANCE OF ENTRY. NOTICE SHALL BE IN PERSON OR BY DOOR HANGER IF OWNER IS NOT PRESENT AT TIME OF PHYSICAL VISIT. DOOR HANGER SHALL NOTIFY PROPERTY OWNER OF THE CONTRACTOR’S NAME, PHONE NUMBER, AND NATURE OF ENCROACHMENT AND WORK TO BE PERFORMED



6611 NE CHESTNUT ST
HILLSBORO, OR
PH: 503.730.1919
FAX: 503.640.0499

topcomllc.com

SCALE: NONE

TWN:	2S
SEC:	
RNG:	1E
DSNR:	TAP
FLDR:	SL
DRWN:	SL
DATE:	12-1-18

ROSEMONT RD
CBX FIBER
STAFFORD TO BAY MEADOWS
WEST LINN, OR

DIAL
811
CALL LOCATE
BEFORE YOU
DIG

OR-CLCK-242
SHT 3 OF 28

POLE INFORMATION:

- 1

PGE POLE #12
MAP #D21-16D
80'/CL-1/04
NEUT= 30'+
CATV= 26'-9"
CBX FIBER= 27'-9"
UNKN FIBER= 25'-10"

POA= 27'-9" (OVERLASH)
- 2

PGE POLE #3846
MAP #D21-16D
80'/CL-1/BT
SEC RISER= 25'-1"
CBX FIBER= 21'-6"
CATV= 20'-6"

POA= 21'-6" (OVERLASH)

ATTACHMENT
LEGEND

- 1

STRAND STRAIGHT
ATTACHMENT
- 2

STRAND DE ATTACHMENT
- 3

STRAND DDE
ATTACHMENT
- 4

STRAND 21-45 DEGREE
ATTACHMENT
- 5

ADSS DE ATTACHMENT
- 6

ADSS DDE ATTACHMENT
- 7

ADSS 21-45 DEGREE
ATTACHMENT
- 8

OVERLASH EXISTING
- 9

ANCHOR & GUY
- 10

DOWNGUY



6611 NE CHESTNUT ST
HILLSBORO, OR
PH: 503.730.1919
FAX: 503.640.0499

topcomllc.com

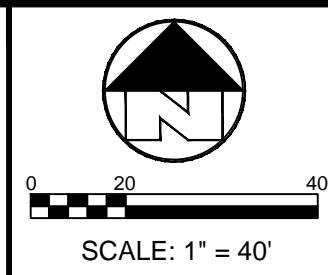

TWN:	2S
SEC:	
RNG:	1E
DSNR:	SL
FLDR:	SL
DRWN:	TAP
DATE:	12-1-18

ROSEMONT RD
CBX FIBER
STAFFORD TO BAY MEADOWS
WEST LINN, OR

DIAL
811
CALL LOCATE
BEFORE YOU
DIG

OR-CLCK-242
SHT 4
OF 28

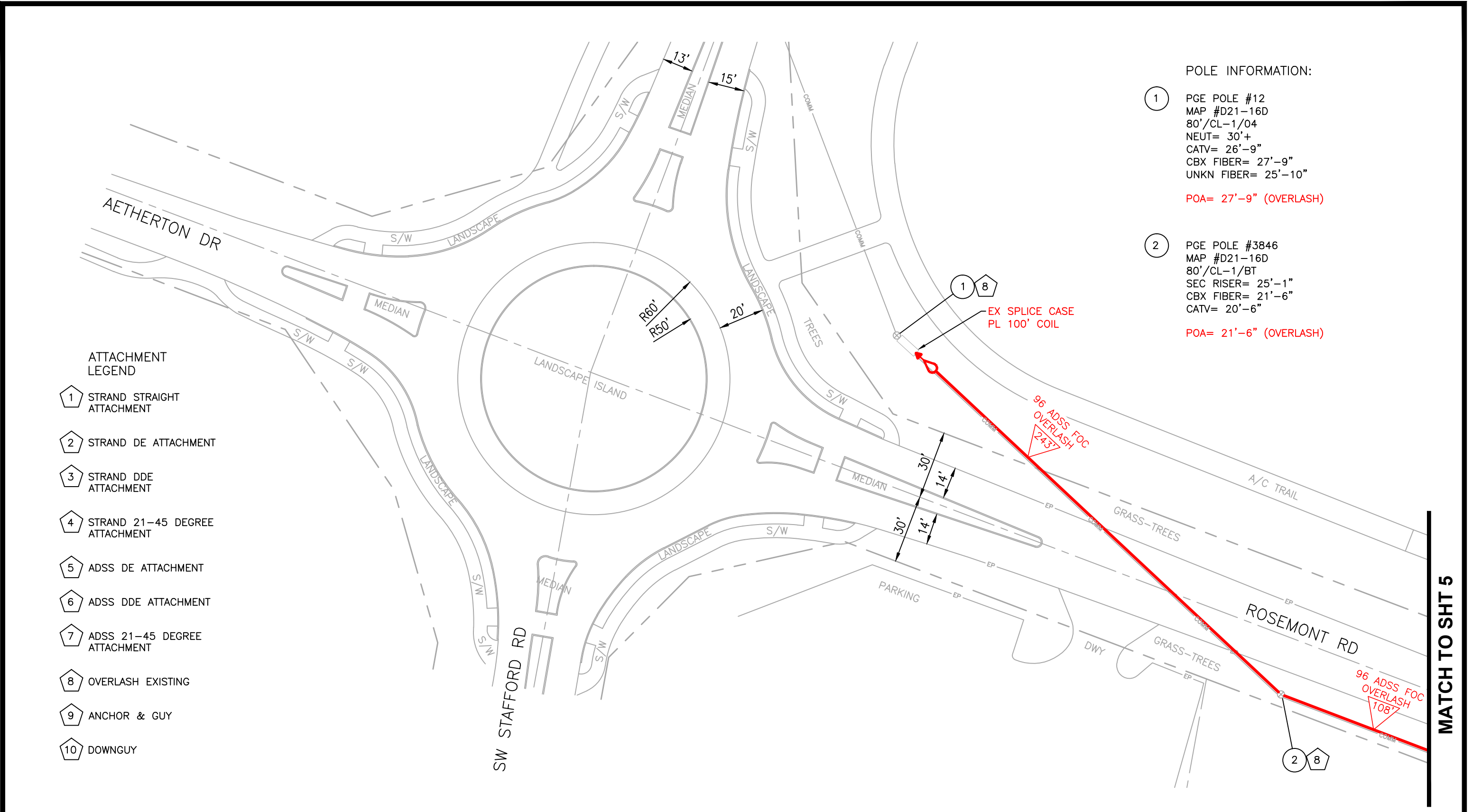

POLE INFORMATION:

- 3

PGE POLE #39
MAP #D21-16D
50'/CL-2/13
NEUT= 26'-7"
CBX FIBER= 23'-3"

POA= 23'-3" (OVERLASH)
- 4

PGE POLE #14
MAP #D21-16D
45'/CL-1/02
NEUT= 28'-8"
CBX FIBER= 22'-4"
CATV= 21'-4" 18" FGA

POA= 22'-4" (OVERLASH)

ATTACHMENT
LEGEND

- 1

STRAND STRAIGHT
ATTACHMENT
- 2

STRAND DE ATTACHMENT
- 3

STRAND DDE
ATTACHMENT
- 4

STRAND 21-45 DEGREE
ATTACHMENT
- 5

ADSS DE ATTACHMENT
- 6

ADSS DDE ATTACHMENT
- 7

ADSS 21-45 DEGREE
ATTACHMENT
- 8

OVERLASH EXISTING
- 9

ANCHOR & GUY
- 10

DOWNGUY

MATCH TO SHT 4

MATCH TO SHT 6



6611 NE CHESTNUT ST
HILLSBORO, OR
PH: 503.730.1919
FAX: 503.640.0499

topcomllc.com

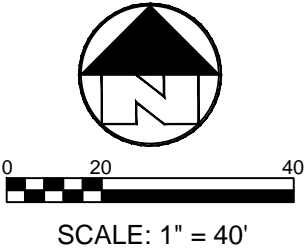

TWN:	2S
SEC:	
RNG:	1E
DSNR:	SL
FLDR:	SL
DRWN:	TAP
DATE:	12-1-18

ROSEMONT RD
CBX FIBER
STAFFORD TO BAY MEADOWS
WEST LINN, OR

DIAL
811
CALL LOCATE
BEFORE YOU
DIG

OR-CLCK-242

SHT 5
OF 28

MATCH TO SHT 5

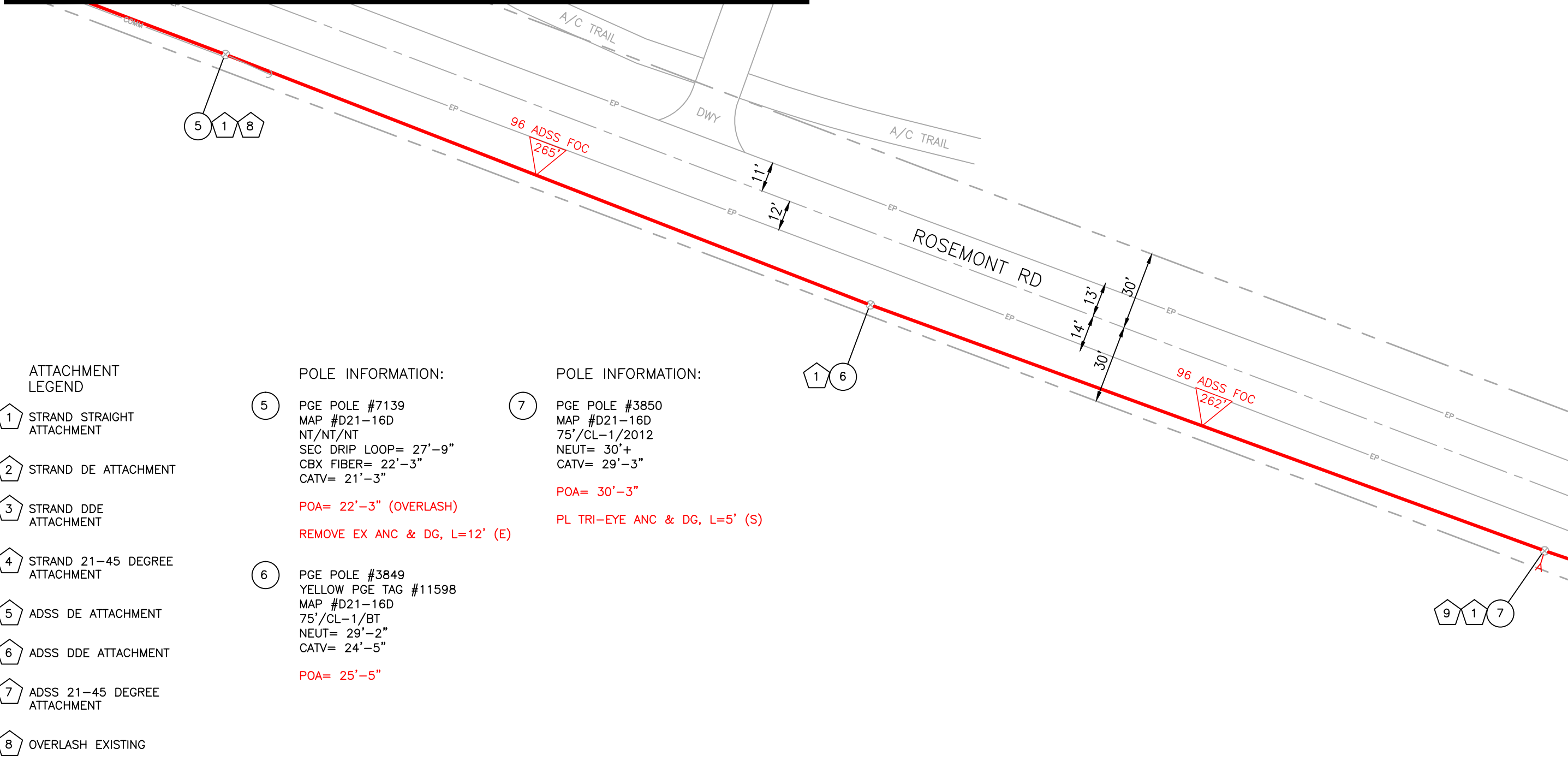

MATCH TO SHT 7

- ATTACHMENT
LEGEND
- 1 STRAND STRAIGHT
ATTACHMENT
 - 2 STRAND DE ATTACHMENT
 - 3 STRAND DDE
ATTACHMENT
 - 4 STRAND 21-45 DEGREE
ATTACHMENT
 - 5 ADSS DE ATTACHMENT
 - 6 ADSS DDE ATTACHMENT
 - 7 ADSS 21-45 DEGREE
ATTACHMENT
 - 8 OVERLASH EXISTING
 - 9 ANCHOR & GUY
 - 10 DOWNGUY

POLE INFORMATION:

5 PGE POLE #7139
MAP #D21-16D
NT/NT/NT
SEC DRIP LOOP= 27'-9"
CBX FIBER= 22'-3"
CATV= 21'-3"

POA= 22'-3" (OVERLASH)
REMOVE EX ANC & DG, L=12' (E)

6 PGE POLE #3849
YELLOW PGE TAG #11598
MAP #D21-16D
75'/CL-1/BT
NEUT= 29'-2"
CATV= 24'-5"

POA= 25'-5"

POLE INFORMATION:

7 PGE POLE #3850
MAP #D21-16D
75'/CL-1/2012
NEUT= 30'+
CATV= 29'-3"

POA= 30'-3"
PL TRI-EYE ANC & DG, L=5' (S)



6611 NE CHESTNUT ST
HILLSBORO, OR
PH: 503.730.1919
FAX: 503.640.0499

topcomllc.com

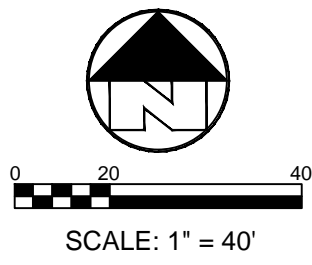

TWN: 2S
SEC:
RNG: 1E
DSNR: SL
FLDR: SL
DRWN: TAP
DATE: 12-1-18

ROSEMONT RD
CBX FIBER
STAFFORD TO BAY MEADOWS
WEST LINN, OR

DIAL
811
CALL LOCATE
BEFORE YOU
DIG

OR-CLCK-242
SHT 6
OF 28

MATCH TO SHT 6

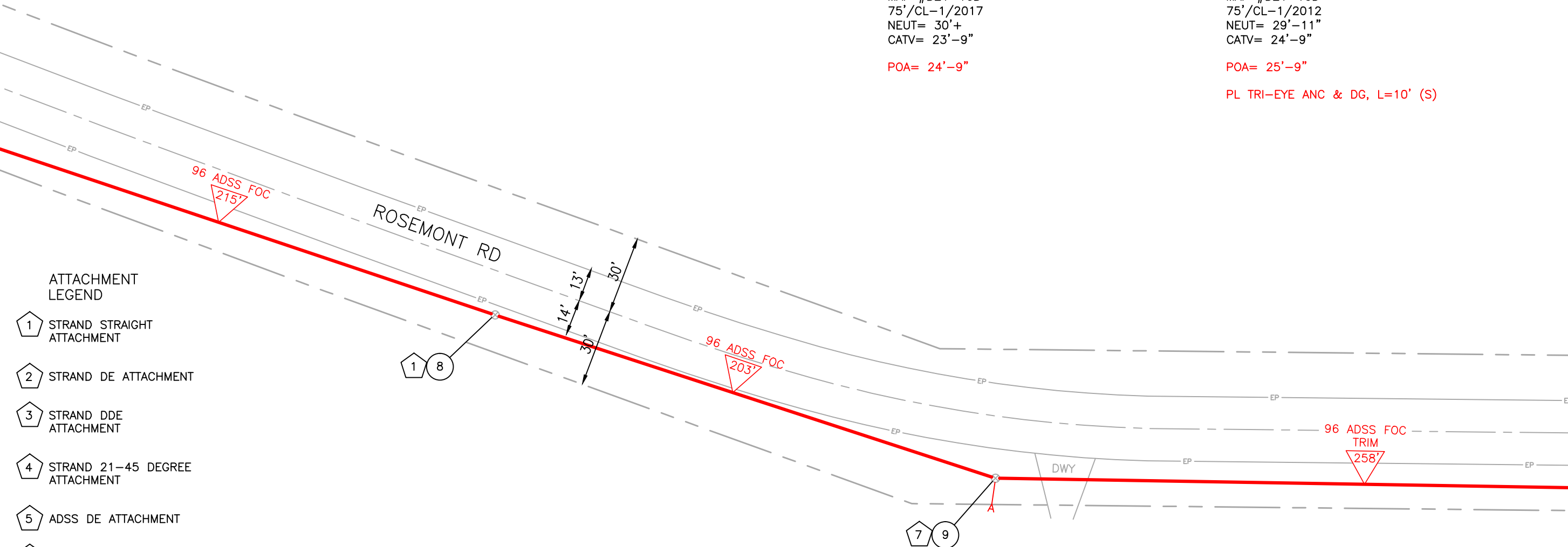

POLE INFORMATION:

8 PGE POLE #3851
MAP #D21-16D
75'/CL-1/2017
NEUT= 30'+
CATV= 23'-9"

POA= 24'-9"

POLE INFORMATION:

9 PGE POLE #3052
MAP #D21-16D
75'/CL-1/2012
NEUT= 29'-11"
CATV= 24'-9"

POA= 25'-9"
PL TRI-EYE ANC & DG, L=10' (S)

ATTACHMENT
LEGEND

- 1 STRAND STRAIGHT ATTACHMENT
- 2 STRAND DE ATTACHMENT
- 3 STRAND DDE ATTACHMENT
- 4 STRAND 21-45 DEGREE ATTACHMENT
- 5 ADSS DE ATTACHMENT
- 6 ADSS DDE ATTACHMENT
- 7 ADSS 21-45 DEGREE ATTACHMENT
- 8 OVERLASH EXISTING
- 9 ANCHOR & GUY
- 10 DOWNGUY

MATCH TO SHT 8



6611 NE CHESTNUT ST
HILLSBORO, OR
PH: 503.730.1919
FAX: 503.640.0499

topcomllc.com

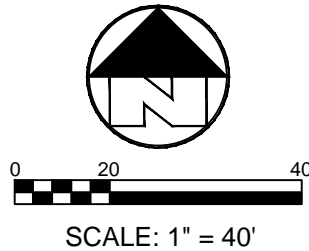

TWN: 2S
SEC:
RNG: 1E
DSNR: SL
FLDR: SL
DRWN: TAP
DATE: 12-1-18

ROSEMONT RD
CBX FIBER
STAFFORD TO BAY MEADOWS
WEST LINN, OR

DIAL **811**
CALL LOCATE
BEFORE YOU
DIG

OR-CLCK-242
SHT 7
OF 28

POLE INFORMATION:

10 PGE POLE #4027
MAP #D21-16D
75'/CL-1/1990
NEUT= 30'+
CATV= 22'-11"

POA= 23'-11"

PL TRI-EYE ANC & DG, L=10' (S)

POLE INFORMATION:

11 PGE POLE #3854
MAP #D21-16D
75'/CL-H1/2012
SEC DRIP LOOP= 30'+
CATV= 24'-7" 12" FGA

POA= 25'-7" 12" FGA

POLE INFORMATION:

12 PGE POLE #3857
MAP #D21-15C
65'/CL-1/2011
SEC DRIP LOOP= 29'-9"
CATV= 23'-2"

POA= 24'-2"

MATCH TO SHT 7

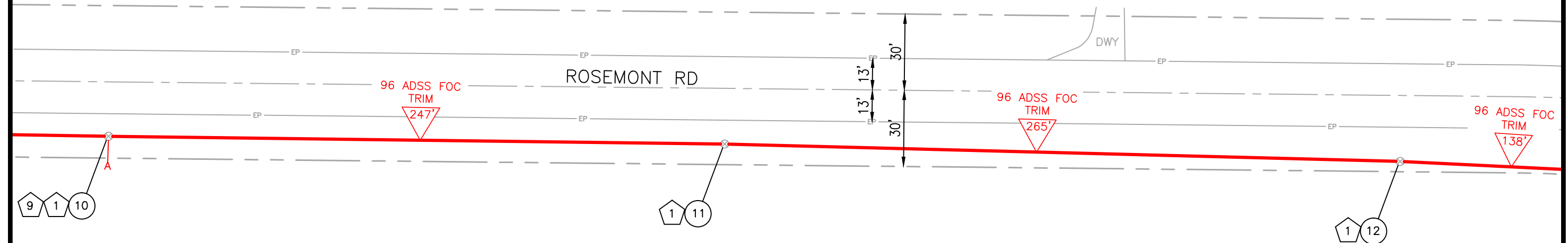

MATCH TO SHT 9

ATTACHMENT
LEGEND

- | | | |
|----------------------------------|--------------------------------|----------------|
| 1 STRAND STRAIGHT ATTACHMENT | 5 ADSS DE ATTACHMENT | 9 ANCHOR & GUY |
| 2 STRAND DE ATTACHMENT | 6 ADSS DDE ATTACHMENT | 10 DOWNGUY |
| 3 STRAND DDE ATTACHMENT | 7 ADSS 21-45 DEGREE ATTACHMENT | |
| 4 STRAND 21-45 DEGREE ATTACHMENT | 8 OVERLASH EXISTING | |



6611 NE CHESTNUT ST
HILLSBORO, OR
PH: 503.730.1919
FAX: 503.640.0499

topcomllc.com

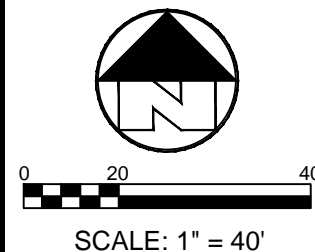

TWN: 2S
SEC:
RNG: 1E
DSNR: SL
FLDR: SL
DRWN: TAP
DATE: 12-1-18

ROSEMONT RD
CBX FIBER
STAFFORD TO BAY MEADOWS
WEST LINN, OR

DIAL **811**
CALL LOCATE
BEFORE YOU
DIG

OR-CLCK-242
SHT 8
OF 28

MATCH TO SHT 8

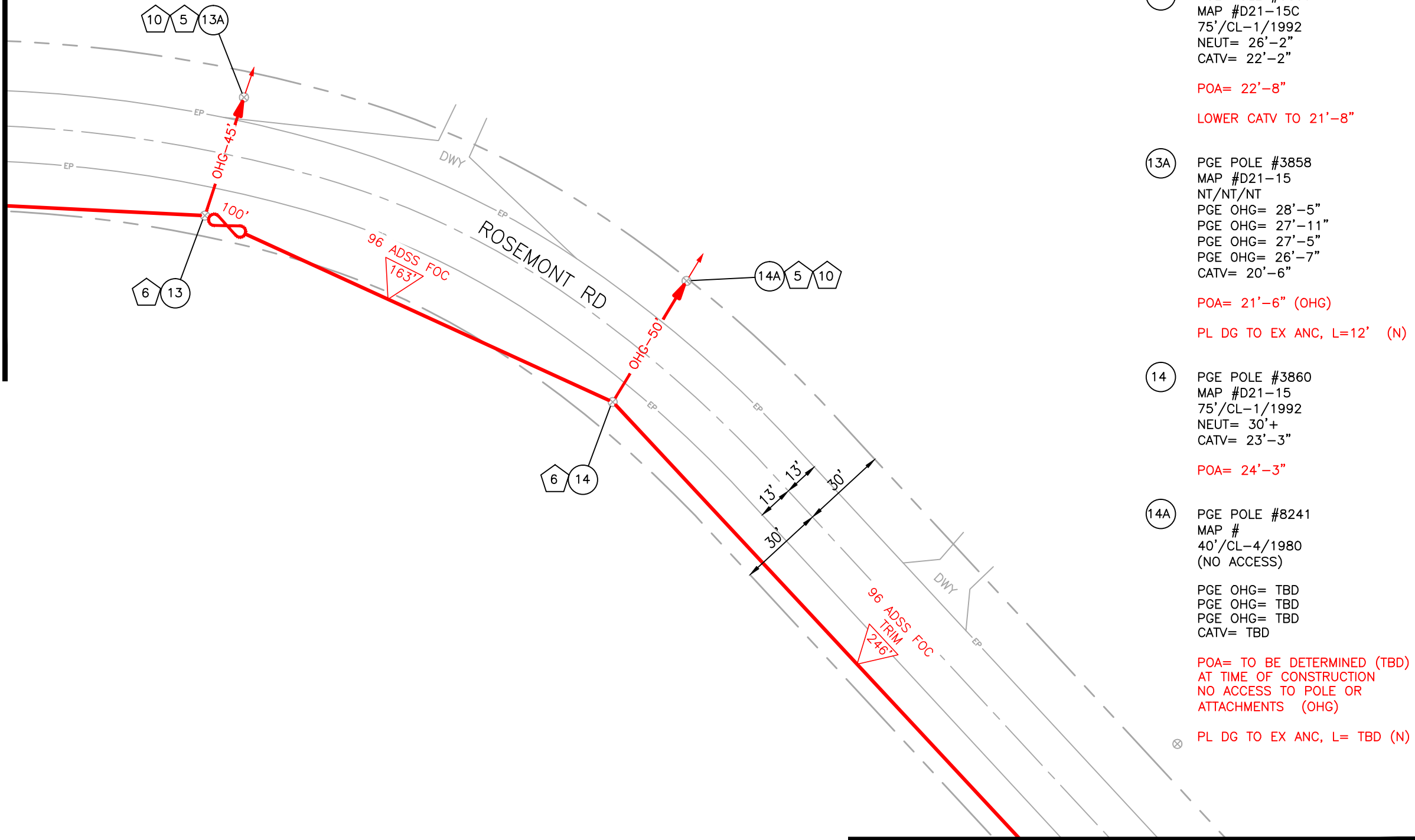

POLE INFORMATION:

- (13) PGE POLE #3859
MAP #D21-15C
75'/CL-1/1992
NEUT= 26'-2"
CATV= 22'-2"

POA= 22'-8"
LOWER CATV TO 21'-8"
- (13A) PGE POLE #3858
MAP #D21-15
NT/NT/NT
PGE OHG= 28'-5"
PGE OHG= 27'-11"
PGE OHG= 27'-5"
PGE OHG= 26'-7"
CATV= 20'-6"

POA= 21'-6" (OHG)
PL DG TO EX ANC, L=12' (N)
- (14) PGE POLE #3860
MAP #D21-15
75'/CL-1/1992
NEUT= 30'+
CATV= 23'-3"

POA= 24'-3"
- (14A) PGE POLE #8241
MAP #
40'/CL-4/1980
(NO ACCESS)

PGE OHG= TBD
PGE OHG= TBD
PGE OHG= TBD
CATV= TBD

POA= TO BE DETERMINED (TBD)
AT TIME OF CONSTRUCTION
NO ACCESS TO POLE OR
ATTACHMENTS (OHG)

PL DG TO EX ANC, L= TBD (N)

ATTACHMENT
LEGEND

- (1) STRAND STRAIGHT
ATTACHMENT
- (2) STRAND DE ATTACHMENT
- (3) STRAND DDE
ATTACHMENT
- (4) STRAND 21-45 DEGREE
ATTACHMENT
- (5) ADSS DE ATTACHMENT
- (6) ADSS DDE ATTACHMENT
- (7) ADSS 21-45 DEGREE
ATTACHMENT
- (8) OVERLASH EXISTING
- (9) ANCHOR & GUY
- (10) DOWNGUY

MATCH TO SHT 10



6611 NE CHESTNUT ST
HILLSBORO, OR
PH: 503.730.1919
FAX: 503.640.0499

topcomllc.com

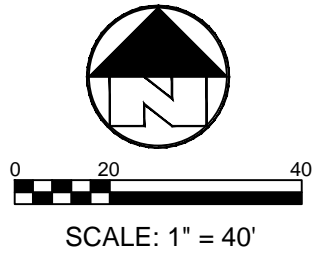

TWN:	2S
SEC:	
RNG:	1E
DSNR:	SL
FLDR:	SL
DRWN:	TAP
DATE:	12-1-18

ROSEMONT RD
CBX FIBER
STAFFORD TO BAY MEADOWS
WEST LINN, OR

DIAL **811**
CALL LOCATE
BEFORE YOU
DIG

OR-CLCK-242
SHT **9**
OF **28**

MATCH TO SHT 9

ATTACHMENT
LEGEND

- 1 STRAND STRAIGHT ATTACHMENT
- 2 STRAND DE ATTACHMENT
- 3 STRAND DDE ATTACHMENT
- 4 STRAND 21-45 DEGREE ATTACHMENT
- 5 ADSS DE ATTACHMENT
- 6 ADSS DDE ATTACHMENT
- 7 ADSS 21-45 DEGREE ATTACHMENT
- 8 OVERLASH EXISTING
- 9 ANCHOR & GUY
- 10 DOWNGUY

POLE INFORMATION:

- 15

PGE POLE #3862
MAP #D21-15C
70'/CL-H2/2011
NEUT= 30'+
CATV= 24'-0"

POA= 25'-0"
- 16

PGE POLE #3863
MAP #D21-15C
70'/CL-1/1992
NEUT= 26'-1"
CATV= 21'-9"

POA= 22'-9"

PL TRI-EYE ANC & DG, L=9' (S)

9 1 16

ROSEMONT RD

MATCH TO SHT 11



6611 NE CHESTNUT ST
HILLSBORO, OR
PH: 503.730.1919
FAX: 503.640.0499
topcomllc.com

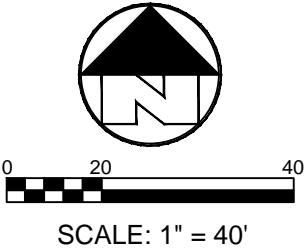

TWN:	2S
SEC:	
RNG:	1E
DSNR:	SL
FLDR:	SL
DRWN:	TAP
DATE:	12-1-18

ROSEMONT RD
CBX FIBER
STAFFORD TO BAY MEADOWS
WEST LINN, OR

DIAL
811
CALL LOCATE
BEFORE YOU
DIG

OR-CLCK-242
SHT 10
OF 28

MATCH TO SHT 10

ATTACHMENT
LEGEND

- 1 STRAND STRAIGHT ATTACHMENT
- 2 STRAND DE ATTACHMENT
- 3 STRAND DDE ATTACHMENT
- 4 STRAND 21-45 DEGREE ATTACHMENT
- 5 ADSS DE ATTACHMENT
- 6 ADSS DDE ATTACHMENT
- 7 ADSS 21-45 DEGREE ATTACHMENT
- 8 OVERLASH EXISTING
- 9 ANCHOR & GUY
- 10 DOWNGUY

POLE INFORMATION:

17 PGE POLE #3864 (CRACKED)
MAP #D21-15
70'/CL-1/1992
SEC DRIP LOOP= 21'-6"
CATV= 18'-5" (VIOLATION)

POA= 18'-1"

LOWER CATV TO 17'-1"

18 PGE POLE #3865
MAP #D21-22B
75'/CL-1/1992
SEC DRIP LOOP RISER= 30'+
CATV= 23'-0"

POA= 24'-0"

19 PGE POLE #3906
MAP #D21-22B
70'/CL-H1/2011
NEUT= 30'+
CATV= 25'-4" FS 18" FGA

POA= 26'-4" FS 12" FGA

ROSEMONT RD

MATCH TO SHT 12



6611 NE CHESTNUT ST
HILLSBORO, OR
PH: 503.730.1919
FAX: 503.640.0499
topcomllc.com

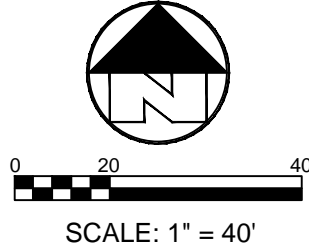

TWN:	2S
SEC:	
RNG:	1E
DSNR:	SL
FLDR:	SL
DRWN:	TAP
DATE:	12-1-18

ROSEMONT RD
CBX FIBER
STAFFORD TO BAY MEADOWS
WEST LINN, OR

DIAL **811**
CALL LOCATE
BEFORE YOU
DIG

OR-CLCK-242
SHT 11
OF 28

MATCH STA 0+00 - SHT 11

ATTACHMENT
LEGEND

- 1 STRAND STRAIGHT ATTACHMENT
- 2 STRAND DE ATTACHMENT
- 3 STRAND DDE ATTACHMENT
- 4 STRAND 21-45 DEGREE ATTACHMENT
- 5 ADSS DE ATTACHMENT
- 6 ADSS DDE ATTACHMENT
- 7 ADSS 21-45 DEGREE ATTACHMENT
- 8 OVERLASH EXISTING
- 9 ANCHOR & GUY
- 10 DOWNGUY

POLE INFORMATION:

20 PGE POLE #3907
MAP #D21-22B
70'/CL-H2/2012
NEUT= 30'+
CATV= 23'-3" FS 18" FGA

POA= 24'-3" FS 12" FGA

21 PGE POLE #3908
MAP #D21-22B
70'/CL-1/1992
NEUT= 30'+
CATV= 22'-9"

POA= 23'-9"

ROSEMONT RD

MATCH STA 0+00 - SHT 13



6611 NE CHESTNUT ST
HILLSBORO, OR
PH: 503.730.1919
FAX: 503.640.0499

topcomllc.com

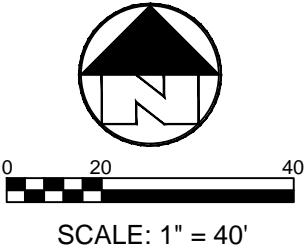

TWN: 2S
SEC:
RNG: 1E
DSNR: SL
FLDR: SL
DRWN: TAP
DATE: 12-1-18

ROSEMONT RD
CBX FIBER
STAFFORD TO BAY MEADOWS
WEST LINN, OR

DIAL **811**
CALL LOCATE
BEFORE YOU
DIG

OR-CLCK-242
SHT 12
OF 28

MATCH TO SHT 12

ATTACHMENT
LEGEND

- 1 STRAND STRAIGHT ATTACHMENT
- 2 STRAND DE ATTACHMENT
- 3 STRAND DDE ATTACHMENT
- 4 STRAND 21-45 DEGREE ATTACHMENT
- 5 ADSS DE ATTACHMENT
- 6 ADSS DDE ATTACHMENT
- 7 ADSS 21-45 DEGREE ATTACHMENT
- 8 OVERLASH EXISTING
- 9 ANCHOR & GUY
- 10 DOWNGUY

POLE INFORMATION:

- 22

PGE POLE #3909
CTL #4302
PI #A1151957
MAP #D21-22B
70'/CL-1/1992
DRIP LOOP RISER= 30'+
CATV= 27'-0"
CTL= 24'-8"

POA= 28'-0"
- 23

PGE POLE #3910
PI # A3410795
MAP #D21-22B
70'/CL-1/2011
NEUT= 30'+
CATV= 23'-7"
CTL DROP= 21'-6"

POA= 24'-7" 12" FGA

ROSEMONT RD

96 ADSS FOC
TRIM
235'

96 ADSS FOC
TRIM
236'

MATCH TO SHT 14



6611 NE CHESTNUT ST
HILLSBORO, OR
PH: 503.730.1919
FAX: 503.640.0499
topcomllc.com

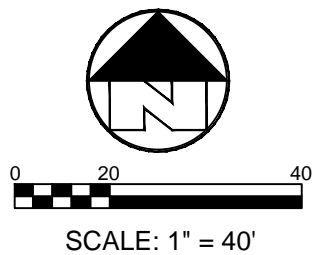

TWN:	2S
SEC:	
RNG:	1E
DSNR:	SL
FLDR:	SL
DRWN:	TAP
DATE:	12-1-18

ROSEMONT RD
CBX FIBER
STAFFORD TO BAY MEADOWS
WEST LINN, OR

DIAL
811
CALL LOCATE
BEFORE YOU
DIG

OR-CLCK-242
SHT 13
OF 28

MATCH TO SHT 13

1 24

POLE INFORMATION:

24 PGE POLE #3911
PI #A3410796
MAP #D21-22B
80'/CL-H1/2001
NEUT= 30'+
CATV= 29'-6"
CTL DROP= 26'-9"

POA= 30'-6"

25 PGE POLE #3912
CTL #43A2
PI # A1151956
MAP #D21-22A
75'/CL-1/1992
NEUT= 30'+
CATV= 27'-4"
CTL DROP= 25'-8"

POA= 28'-4"

25A PGE POLE #3913
CTL #5243
PI #1750132
MAP #D21-22A
40'/CL-3/2008
PGE OHG= 30'+
PGE OHG= 30'+
PGE OHG= 30'+
CATV OHG= 23'-11"
CTL= 23'-0"

POA= 24'-11"

PL TRI-EYE ANC & DG, L=16' (N)

96 ADSS TRIM FOC
312'

S WHITTEN LN

25' 25'

25A 5 9

6 25

100' OHG=41'

ROSEMONT RD

96 ADSS TRIM FOC
250'

ATTACHMENT
LEGEND

- 1 STRAND STRAIGHT ATTACHMENT
- 2 STRAND DE ATTACHMENT
- 3 STRAND DDE ATTACHMENT
- 4 STRAND 21-45 DEGREE ATTACHMENT
- 5 ADSS DE ATTACHMENT
- 6 ADSS DDE ATTACHMENT
- 7 ADSS 21-45 DEGREE ATTACHMENT
- 8 OVERLASH EXISTING
- 9 ANCHOR & GUY
- 10 DOWNGUY

MATCH TO SHT 15



6611 NE CHESTNUT ST
HILLSBORO, OR
PH: 503.730.1919
FAX: 503.640.0499
topcomllc.com

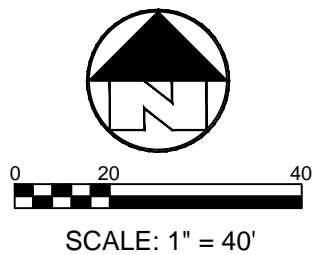

TWN:	2S
SEC:	
RNG:	1E
DSNR:	SL
FLDR:	SL
DRWN:	TAP
DATE:	12-1-18

ROSEMONT RD
CBX FIBER
STAFFORD TO BAY MEADOWS
WEST LINN, OR

DIAL
811
CALL LOCATE
BEFORE YOU
DIG

OR-CLCK-242
SHT 14
OF 28

MATCH TO SHT 14

POLE INFORMATION:

26

PGE POLE #3914
CTL #44A2
PI #A1023535
MAP #D21-22
70'/CL-1/1992
NEUT= 27'-6"
CATV= 21'-1"
CTL DROP= 20'-8"

POA= 22'-1"

27

PGE POLE #3915
MAP #D21-22
70'/CL-1/1972
NEUT= 28'-4" RS
CATV= 22'-3" FS

POA= 23'-3" FS

27A

PGE POLE #3916
CTL #-44-5
PI #1023532
MAP #D21-22A
40'/CL-4/1977
PGE OHG= 30'+
PGE OHG= 30'+
CATV OHG= 24'-8"
CTL= 23'-9"

POA= 25'-8"

PL DG TO EX S/W ANC; PL AUX
EYE, L=13' (N)

ROSEMONT RD

96 ADSS FOC
TRIM
25'

13' 13' 30'

OHG-41'

MATCH TO SHT 16

ATTACHMENT
LEGEND

- 1 STRAND STRAIGHT ATTACHMENT
- 2 STRAND DE ATTACHMENT
- 3 STRAND DDE ATTACHMENT
- 4 STRAND 21-45 DEGREE ATTACHMENT
- 5 ADSS DE ATTACHMENT
- 6 ADSS DDE ATTACHMENT
- 7 ADSS 21-45 DEGREE ATTACHMENT
- 8 OVERLASH EXISTING
- 9 ANCHOR & GUY
- 10 DOWNGUY



6611 NE CHESTNUT ST
HILLSBORO, OR
PH: 503.730.1919
FAX: 503.640.0499
topcomllc.com

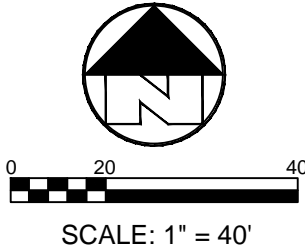

TWN:	2S
SEC:	
RNG:	1E
DSNR:	SL
FLDR:	SL
DRWN:	TAP
DATE:	12-1-18

ROSEMONT RD
CBX FIBER
STAFFORD TO BAY MEADOWS
WEST LINN, OR

DIAL
811
CALL LOCATE
BEFORE YOU
DIG

OR-CLCK-242
SHT 15
OF 28

MATCH TO SHT 15

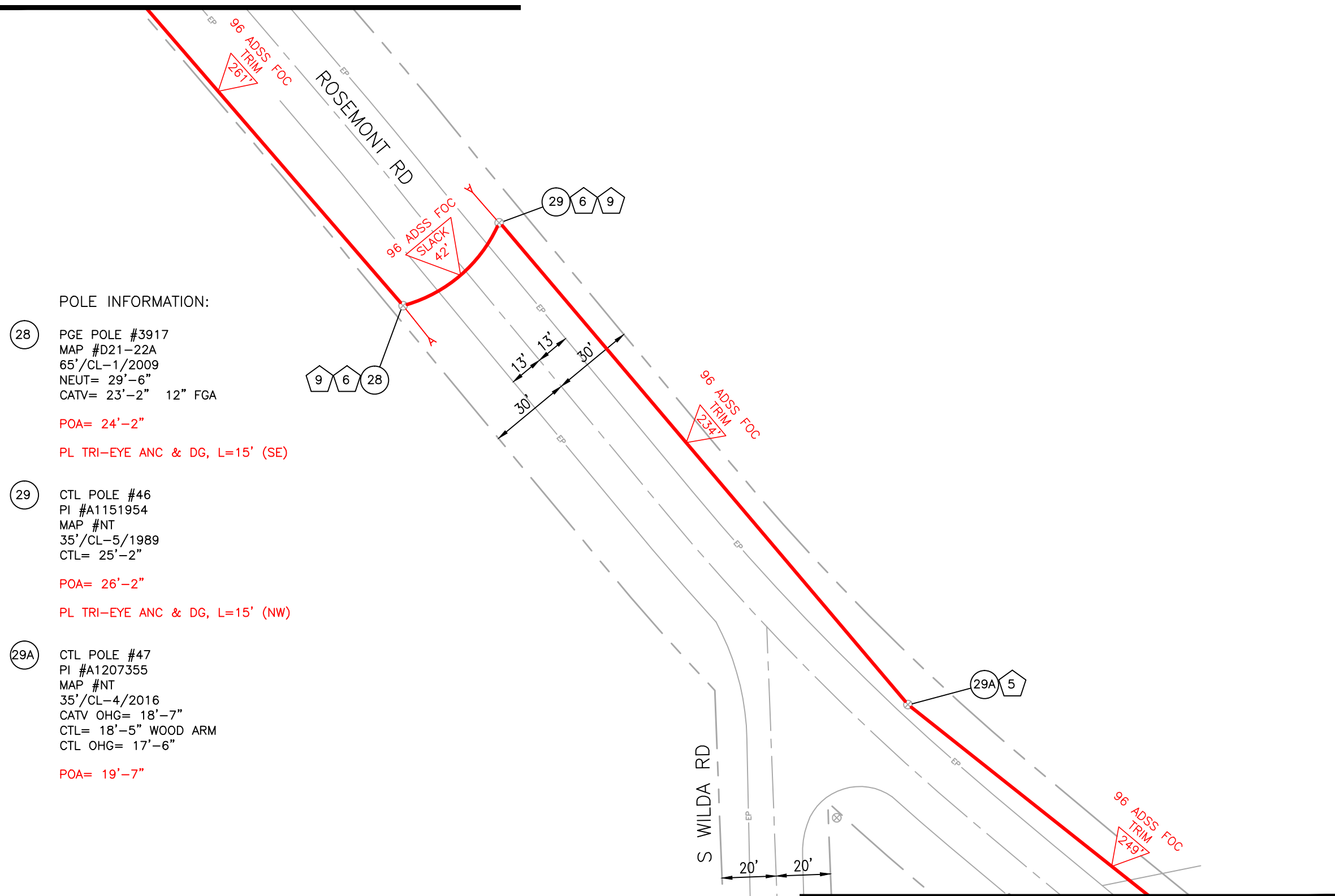

ATTACHMENT
LEGEND

- 1 STRAND STRAIGHT ATTACHMENT
- 2 STRAND DE ATTACHMENT
- 3 STRAND DDE ATTACHMENT
- 4 STRAND 21-45 DEGREE ATTACHMENT
- 5 ADSS DE ATTACHMENT
- 6 ADSS DDE ATTACHMENT
- 7 ADSS 21-45 DEGREE ATTACHMENT
- 8 OVERLASH EXISTING
- 9 ANCHOR & GUY
- 10 DOWNGUY

POLE INFORMATION:

28 PGE POLE #3917
MAP #D21-22A
65'/CL-1/2009
NEUT= 29'-6"
CATV= 23'-2" 12" FGA

POA= 24'-2"

PL TRI-EYE ANC & DG, L=15' (SE)

29 CTL POLE #46
PI #A1151954
MAP #NT
35'/CL-5/1989
CTL= 25'-2"

POA= 26'-2"

PL TRI-EYE ANC & DG, L=15' (NW)

29A CTL POLE #47
PI #A1207355
MAP #NT
35'/CL-4/2016
CATV OHG= 18'-7"
CTL= 18'-5" WOOD ARM
CTL OHG= 17'-6"

POA= 19'-7"

MATCH TO SHT 17



6611 NE CHESTNUT ST
HILLSBORO, OR
PH: 503.730.1919
FAX: 503.640.0499
topcomllc.com

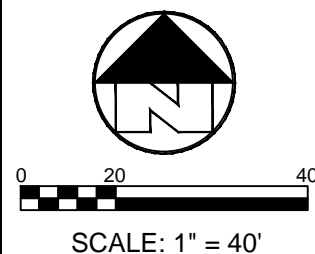

TWN: 2S
SEC:
RNG: 1E
DSNR: SL
FLDR: SL
DRWN: TAP
DATE: 12-1-18

ROSEMONT RD
CBX FIBER
STAFFORD TO BAY MEADOWS
WEST LINN, OR

DIAL **811**
CALL LOCATE
BEFORE YOU
DIG

OR-CLCK-242
SHT 16
OF 28

MATCH TO SHT 16

POLE INFORMATION:

29B CTL POLE #48
PI #A1207326
MAP #NT
35'/CL-4/2006
CATV DROP= 25'-6"
CTL DROP= 24'-5"
CTL= 22'-7"

POA= 23'-7"

PL TRI-EYE ANC & DG, L=15' (SE)

ATTACHMENT
LEGEND

- 1 STRAND STRAIGHT ATTACHMENT
- 2 STRAND DE ATTACHMENT
- 3 STRAND DDE ATTACHMENT
- 4 STRAND 21-45 DEGREE ATTACHMENT
- 5 ADSS DE ATTACHMENT
- 6 ADSS DDE ATTACHMENT
- 7 ADSS 21-45 DEGREE ATTACHMENT
- 8 OVERLASH EXISTING
- 9 ANCHOR & GUY
- 10 DOWNGUY

POLE INFORMATION:

30 PGE POLE #3919
CTL #48A6
PI #A1207327
MAP #D21-22
BT/BT/BT
SEC DRIP LOOP= 30'+
CATV= 23'-4"

POA= 24'-4"

PL TRI-EYE ANC & DG, L=15' (NW)

31 PGE POLE #3920
MAP #D21-22
70'/CL-1/1991
SEC DRIP LOOP= 30'-0"
CATV= 23'-11" FS

POA= 24'-11"

1 31

MATCH TO SHT 18



6611 NE CHESTNUT ST
HILLSBORO, OR
PH: 503.730.1919
FAX: 503.640.0499

topcomllc.com

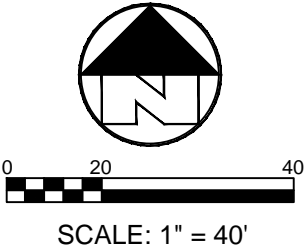

TWN:	2S
SEC:	
RNG:	1E
DSNR:	SL
FLDR:	SL
DRWN:	TAP
DATE:	12-1-18

ROSEMONT RD
CBX FIBER
STAFFORD TO BAY MEADOWS
WEST LINN, OR

DIAL 811
CALL LOCATE
BEFORE YOU
DIG

OR-CLCK-242
SHT 17
OF 28

MATCH TO SHT 17

ATTACHMENT
LEGEND

- 1 STRAND STRAIGHT ATTACHMENT
- 2 STRAND DE ATTACHMENT
- 3 STRAND DDE ATTACHMENT
- 4 STRAND 21-45 DEGREE ATTACHMENT
- 5 ADSS DE ATTACHMENT
- 6 ADSS DDE ATTACHMENT
- 7 ADSS 21-45 DEGREE ATTACHMENT
- 8 OVERLASH EXISTING
- 9 ANCHOR & GUY
- 10 DOWNGUY

POLE INFORMATION:

- 32 PGE POLE #3921
MAP #D21-22
70'/CL-1/1978
NEUT= 29'-8"
CATV= 23'-8"

POA= 24'-8"
- 33 PGE POLE #3922
PI #A1724233
MAP #D21-22A
65'/CL-H1/2010
SEC DRIP LOOP= 27'-8"
CATV= 22'-0"

POA= 23'-0"

ROSEMONT RD

MATCH TO SHT 19



6611 NE CHESTNUT ST
HILLSBORO, OR
PH: 503.730.1919
FAX: 503.640.0499

topcomllc.com

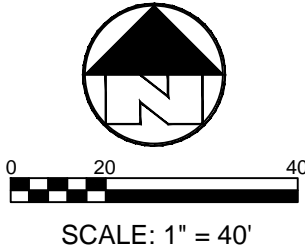

TWN:	2S
SEC:	
RNG:	1E
DSNR:	SL
FLDR:	SL
DRWN:	TAP
DATE:	12-1-18

ROSEMONT RD
CBX FIBER
STAFFORD TO BAY MEADOWS
WEST LINN, OR

DIAL **811**
CALL LOCATE
BEFORE YOU
DIG

OR-CLCK-242
SHT **18**
OF **28**

MATCH TO SHT 18

POLE INFORMATION:

(36) PGE POLE #3925
PI #A3410800
MAP #D21-22
70'/CL-1/2011
NEUT= 30'+
CATV= 23'-2"

POA= 24'-2"

ATTACHMENT
LEGEND

- 1 STRAND STRAIGHT ATTACHMENT
- 2 STRAND DE ATTACHMENT
- 3 STRAND DDE ATTACHMENT
- 4 STRAND 21-45 DEGREE ATTACHMENT
- 5 ADSS DE ATTACHMENT
- 6 ADSS DDE ATTACHMENT
- 7 ADSS 21-45 DEGREE ATTACHMENT
- 8 OVERLASH EXISTING
- 9 ANCHOR & GUY
- 10 DOWNGUY

POLE INFORMATION:

(34) PGE POLE #3923
CTL #5286
PI #A1130000
MAP #D21-22
BT/BT/BT
NEUT= 28'-1"
ST LT= 25'-4"
CATV= 23'-8"
OHG= 20'-4" (N)

POA= 23'-8"

LOWER CATV TO 22'-8"
PL DG TO EX ANC, L=10' (S)

POLE INFORMATION:

(35) PGE POLE #3924
PI #A1724444
MAP #D21-22D
BT/CL-1/2010
SEC RISER DRIP LOOP= 26'-5"
CATV= 21'-0"

POA= 22'-0"



0 20 40

SCALE: 1" = 40'

TWN: 2S
SEC:
RNG: 1E
DSNR: SL
FLDR: SL
DRWN: TAP
DATE: 12-1-18

ROSEMONT RD
CBX FIBER
STAFFORD TO BAY MEADOWS
WEST LINN, OR

DIAL **811**
CALL LOCATE
BEFORE YOU
DIG

OR-CLCK-242
SHT 19
OF 28

MATCH TO SHT 20

MATCH TO SHT 19

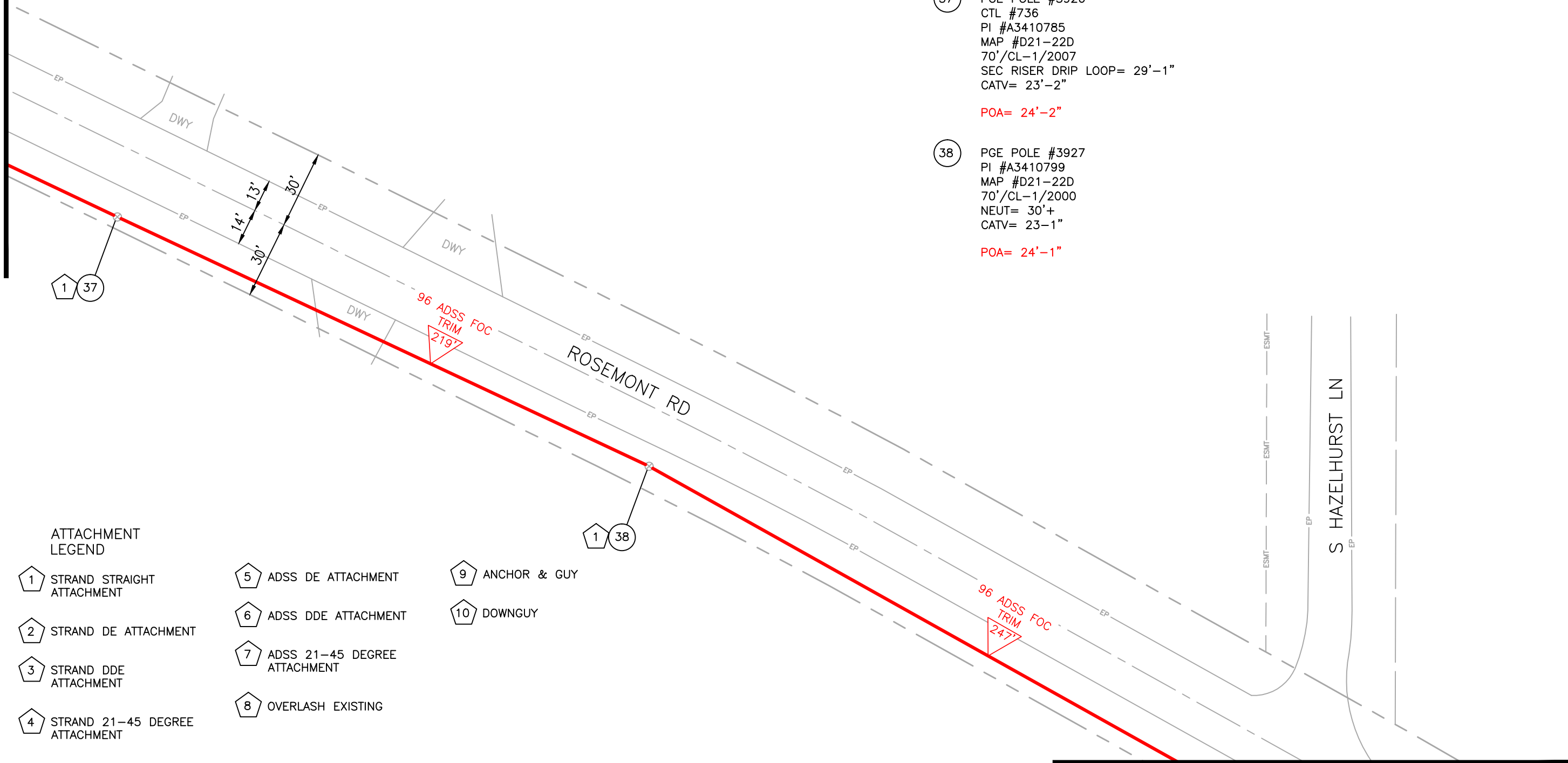

POLE INFORMATION:

37 PGE POLE #3926
CTL #736
PI #A3410785
MAP #D21-22D
70'/CL-1/2007
SEC RISER DRIP LOOP= 29'-1"
CATV= 23'-2"

POA= 24'-2"

38 PGE POLE #3927
PI #A3410799
MAP #D21-22D
70'/CL-1/2000
NEUT= 30'+
CATV= 23-1"

POA= 24'-1"

ATTACHMENT
LEGEND

- | | | |
|----------------------------------|--------------------------------|----------------|
| 1 STRAND STRAIGHT ATTACHMENT | 5 ADSS DE ATTACHMENT | 9 ANCHOR & GUY |
| 2 STRAND DE ATTACHMENT | 6 ADSS DDE ATTACHMENT | 10 DOWNGUY |
| 3 STRAND DDE ATTACHMENT | 7 ADSS 21-45 DEGREE ATTACHMENT | |
| 4 STRAND 21-45 DEGREE ATTACHMENT | 8 OVERLASH EXISTING | |

MATCH TO SHT 21



6611 NE CHESTNUT ST
HILLSBORO, OR
PH: 503.730.1919
FAX: 503.640.0499

topcomllc.com

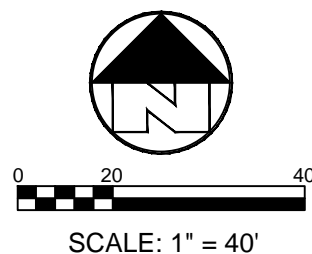

TWN: 2S
SEC:
RNG: 1E
DSNR: SL
FLDR: SL
DRWN: TAP
DATE: 12-1-18

ROSEMONT RD
CBX FIBER
STAFFORD TO BAY MEADOWS
WEST LINN, OR

DIAL **811**
CALL LOCATE
BEFORE YOU
DIG

OR-CLCK-242
SHT 20
OF 28

MATCH TO SHT 20

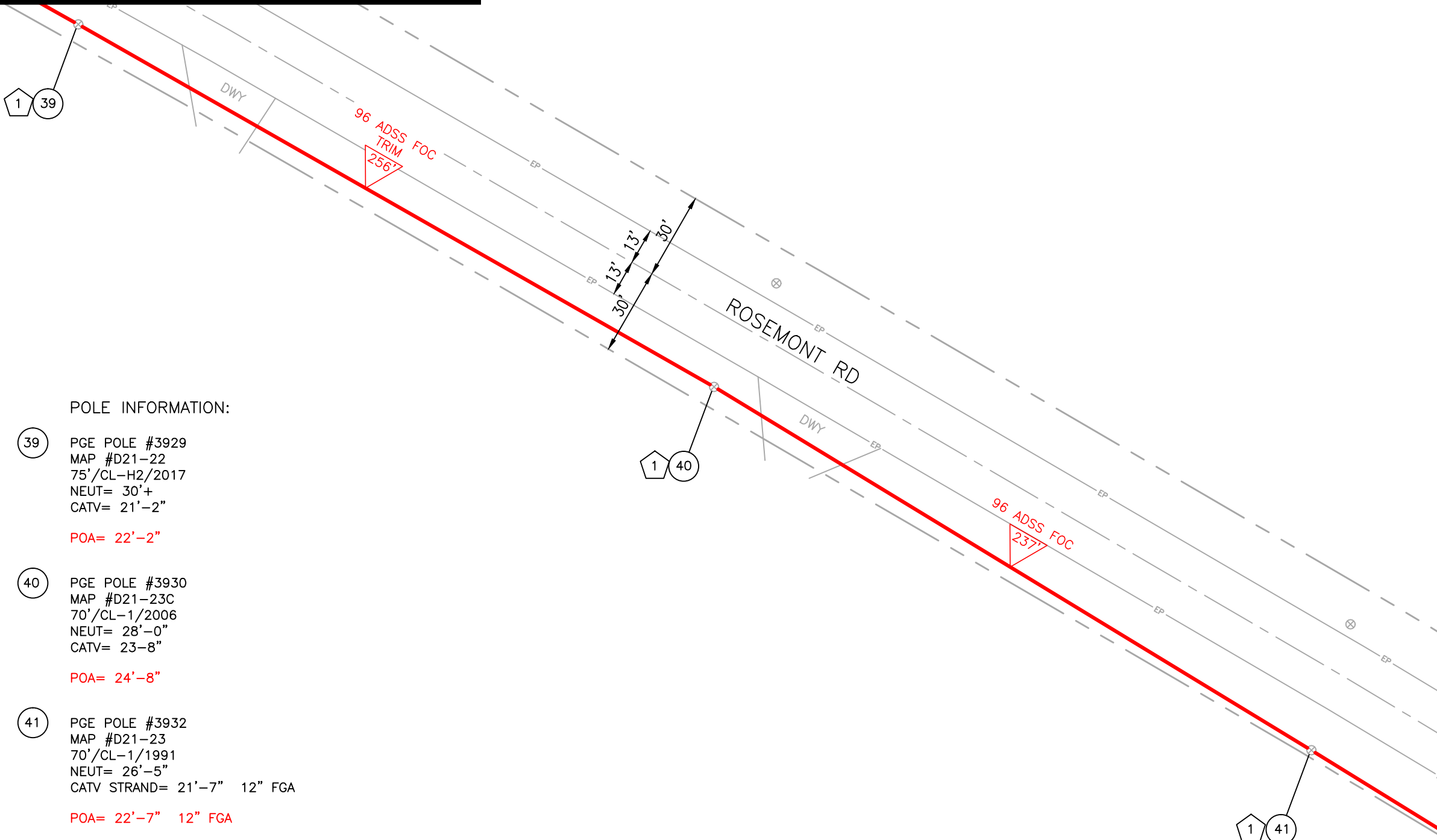

ATTACHMENT
LEGEND

- 1 STRAND STRAIGHT ATTACHMENT
- 2 STRAND DE ATTACHMENT
- 3 STRAND DDE ATTACHMENT
- 4 STRAND 21-45 DEGREE ATTACHMENT
- 5 ADSS DE ATTACHMENT
- 6 ADSS DDE ATTACHMENT
- 7 ADSS 21-45 DEGREE ATTACHMENT
- 8 OVERLASH EXISTING
- 9 ANCHOR & GUY
- 10 DOWNGUY

POLE INFORMATION:

- 39 PGE POLE #3929
MAP #D21-22
75'/CL-H2/2017
NEUT= 30'+
CATV= 21'-2"

POA= 22'-2"
- 40 PGE POLE #3930
MAP #D21-23C
70'/CL-1/2006
NEUT= 28'-0"
CATV= 23-8"

POA= 24'-8"
- 41 PGE POLE #3932
MAP #D21-23
70'/CL-1/1991
NEUT= 26'-5"
CATV STRAND= 21'-7" 12" FGA

POA= 22'-7" 12" FGA

MATCH TO SHT 22



6611 NE CHESTNUT ST
HILLSBORO, OR
PH: 503.730.1919
FAX: 503.640.0499

topcomllc.com

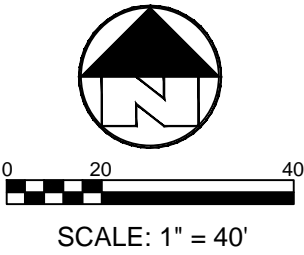

TWN: 2S
SEC:
RNG: 1E
DSNR: SL
FLDR: SL
DRWN: TAP
DATE: 12-1-18

ROSEMONT RD
CBX FIBER
STAFFORD TO BAY MEADOWS
WEST LINN, OR

DIAL **811**
CALL LOCATE
BEFORE YOU
DIG

OR-CLCK-242
SHT 21
OF 28

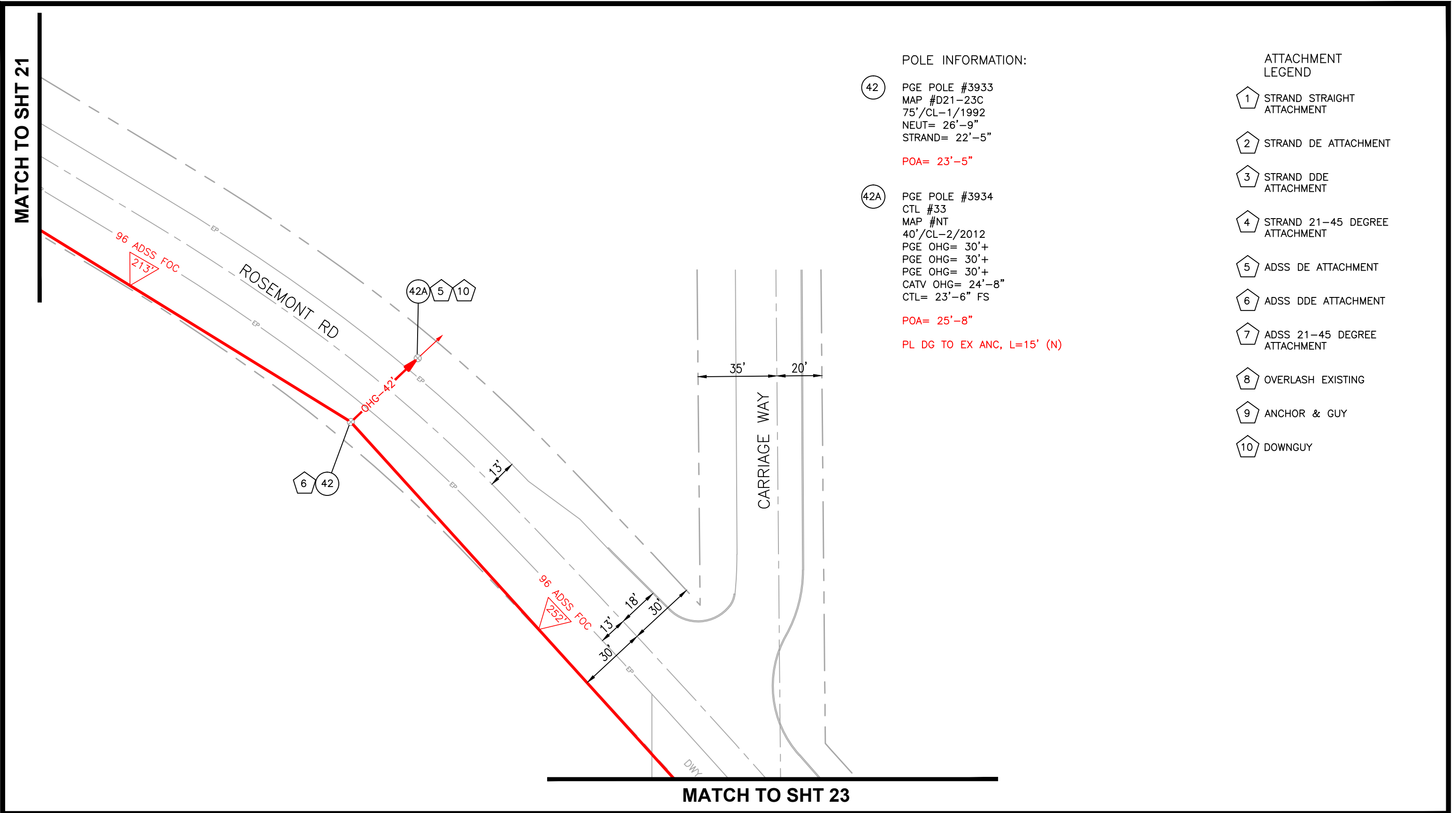

POLE INFORMATION:

42 PGE POLE #3933
MAP #D21-23C
75'/CL-1/1992
NEUT= 26'-9"
STRAND= 22'-5"

POA= 23'-5"

42A PGE POLE #3934
CTL #33
MAP #NT
40'/CL-2/2012
PGE OHG= 30'+
PGE OHG= 30'+
PGE OHG= 30'+
CATV OHG= 24'-8"
CTL= 23'-6" FS

POA= 25'-8"



PL DG TO EX ANC, L=15' (N)

ATTACHMENT
LEGEND

- 1 STRAND STRAIGHT ATTACHMENT
- 2 STRAND DE ATTACHMENT
- 3 STRAND DDE ATTACHMENT
- 4 STRAND 21-45 DEGREE ATTACHMENT
- 5 ADSS DE ATTACHMENT
- 6 ADSS DDE ATTACHMENT
- 7 ADSS 21-45 DEGREE ATTACHMENT
- 8 OVERLASH EXISTING
- 9 ANCHOR & GUY
- 10 DOWNGUY



6611 NE CHESTNUT ST
HILLSBORO, OR
PH: 503.730.1919
FAX: 503.640.0499
topcomllc.com



SCALE: 1" = 40'

TWN: 2S
SEC:
RNG: 1E
DSNR: SL
FLDR: SL
DRWN: TAP
DATE: 12-1-18

ROSEMONT RD
CBX FIBER
STAFFORD TO BAY MEADOWS
WEST LINN, OR

DIAL 811
CALL LOCATE
BEFORE YOU
DIG

OR-CLCK-242
SHT 22
OF 28

MATCH TO SHT 22

POLE INFORMATION:

43 PGE POLE #3935
MAP #D21-23C
70'/CL-1/2004
NEUT= 30'+
OHG= 27'-3"
CATV= 25'-3" 12" FGA

POA= 26'-3" 12" FGA

44 PGE POLE #3936
MAP #D21-23C
75'/CL-1/1992
NEUT= 28'-2"
CATV= 24'-1"

POA= 24'-9"

LOWER CATV TO 23'-9"

44A PGE POLE #3937
MAP #D21-23C
40'/CL-1/2009
PGE OHG= 30'+
PGE OHG= 30'+
PGE OHG= 29'-0"
CATV OHG= 23'-6"
CTL= 21'-11"

POA= 24'-6"

PL DG TO EX S/W ANC; PL AUX
EYE, L=8' (NE)

- ATTACHMENT
LEGEND
- 1 STRAND STRAIGHT
ATTACHMENT
 - 2 STRAND DE ATTACHMENT
 - 3 STRAND DDE
ATTACHMENT
 - 4 STRAND 21-45 DEGREE
ATTACHMENT
 - 5 ADSS DE ATTACHMENT
 - 6 ADSS DDE ATTACHMENT
 - 7 ADSS 21-45 DEGREE
ATTACHMENT
 - 8 OVERLASH EXISTING
 - 9 ANCHOR & GUY
 - 10 DOWNGUY

MATCH TO SHT 24



6611 NE CHESTNUT ST
HILLSBORO, OR
PH: 503.730.1919
FAX: 503.640.0499

topcomllc.com

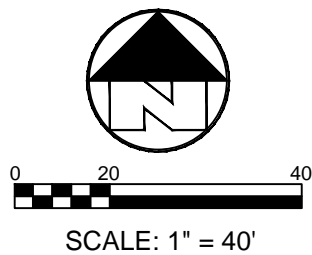

TWN: 2S
SEC:
RNG: 1E
DSNR: SL
FLDR: SL
DRWN: TAP
DATE: 12-1-18

ROSEMONT RD
CBX FIBER
STAFFORD TO BAY MEADOWS
WEST LINN, OR

DIAL 811
CALL LOCATE
BEFORE YOU
DIG

OR-CLCK-242
SHT 23
OF 28

MATCH TO SHT 23

POLE INFORMATION:

- 45

PGE POLE #3938
MAP #D21-25
70'/CL-1/2004
NEUT= 26'-0"
CATV= 22'-11"

POA= 22'-7"

LOWER CATV TO 21'-7"
- 45A

CTL #932
PI #A3410797
MAP #NT
35'/CL-2/2010
PGE OHG= 29'-2"
PGE OHG= 28'-8"
PGE OHG= 28'-2"
CATV OHG= 25'-7"

POA= 26'-7"

PL DG TO EX S/W ANC; PL AUX
EYE, L=8' (NE)
- 46

PGE POLE #3940
MAP #D21-23
70'/CL-1/1992
NEUT= 30'+
CATV= 25'-6"

POA= 26'-6"
- 46A

PGE POLE #2367
MAP #D21-23C
35'/CL-2/2000
PGE OHG= 26'-6"
PGE OHG= 26'-2"
CATV OHG= 25'9"

POA= 25'-9"

LOWER CATV TO 25'-3"
PL DG TO EX S/W ANC, L=8' (N)

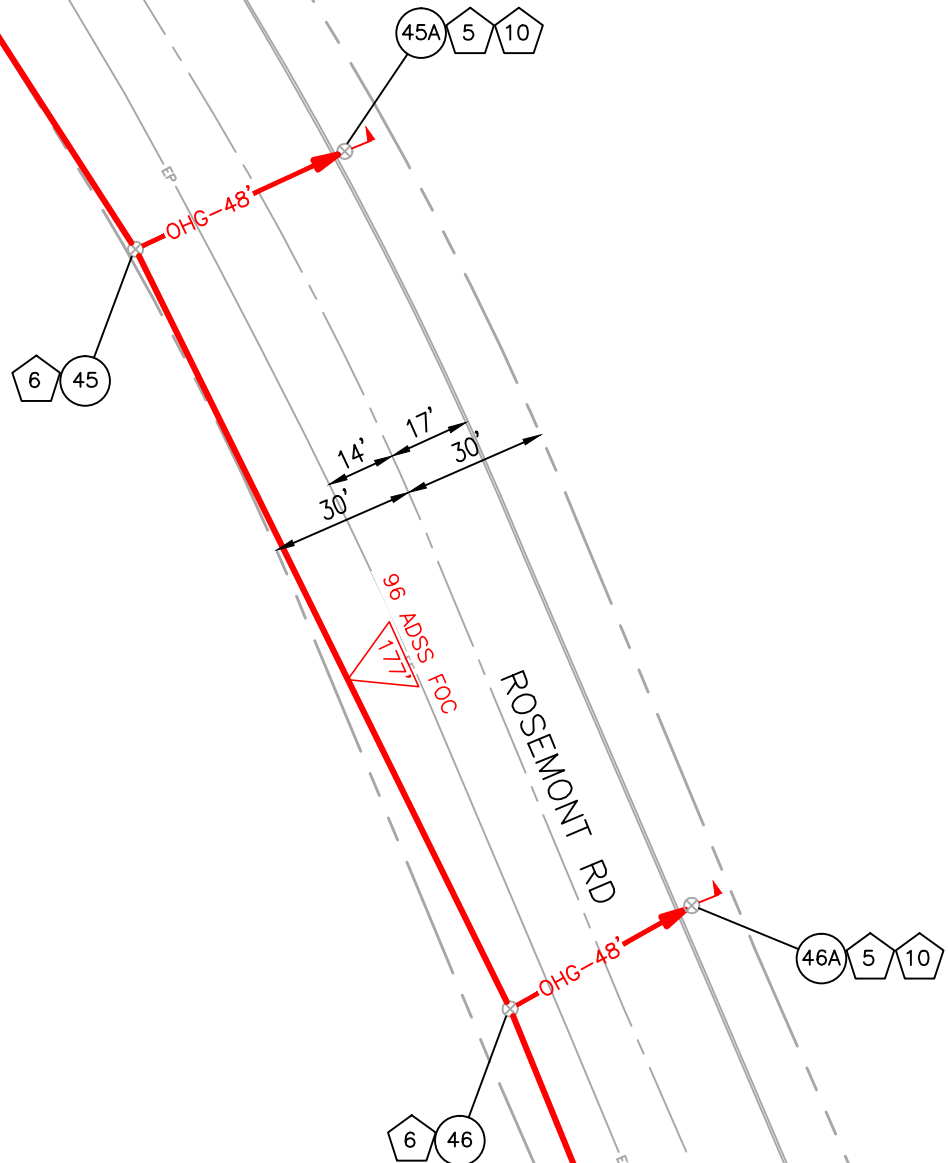

ATTACHMENT
LEGEND

- 1 STRAND STRAIGHT ATTACHMENT
- 2 STRAND DE ATTACHMENT
- 3 STRAND DDE ATTACHMENT
- 4 STRAND 21-45 DEGREE ATTACHMENT
- 5 ADSS DE ATTACHMENT
- 6 ADSS DDE ATTACHMENT
- 7 ADSS 21-45 DEGREE ATTACHMENT
- 8 OVERLASH EXISTING
- 9 ANCHOR & GUY
- 10 DOWNGUY

MATCH TO SHT 25



6611 NE CHESTNUT ST
HILLSBORO, OR
PH: 503.730.1919
FAX: 503.640.0499

topcomllc.com

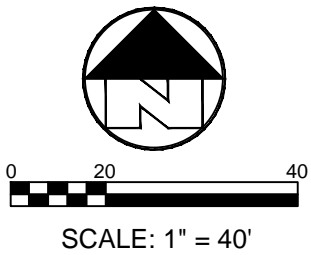

TWN:	2S
SEC:	
RNG:	1E
DSNR:	SL
FLDR:	SL
DRWN:	TAP
DATE:	12-1-18

ROSEMONT RD
CBX FIBER
STAFFORD TO BAY MEADOWS
WEST LINN, OR

DIAL **811**
CALL LOCATE
BEFORE YOU
DIG

OR-CLCK-242
SHT 24
OF 28

MATCH TO SHT 24

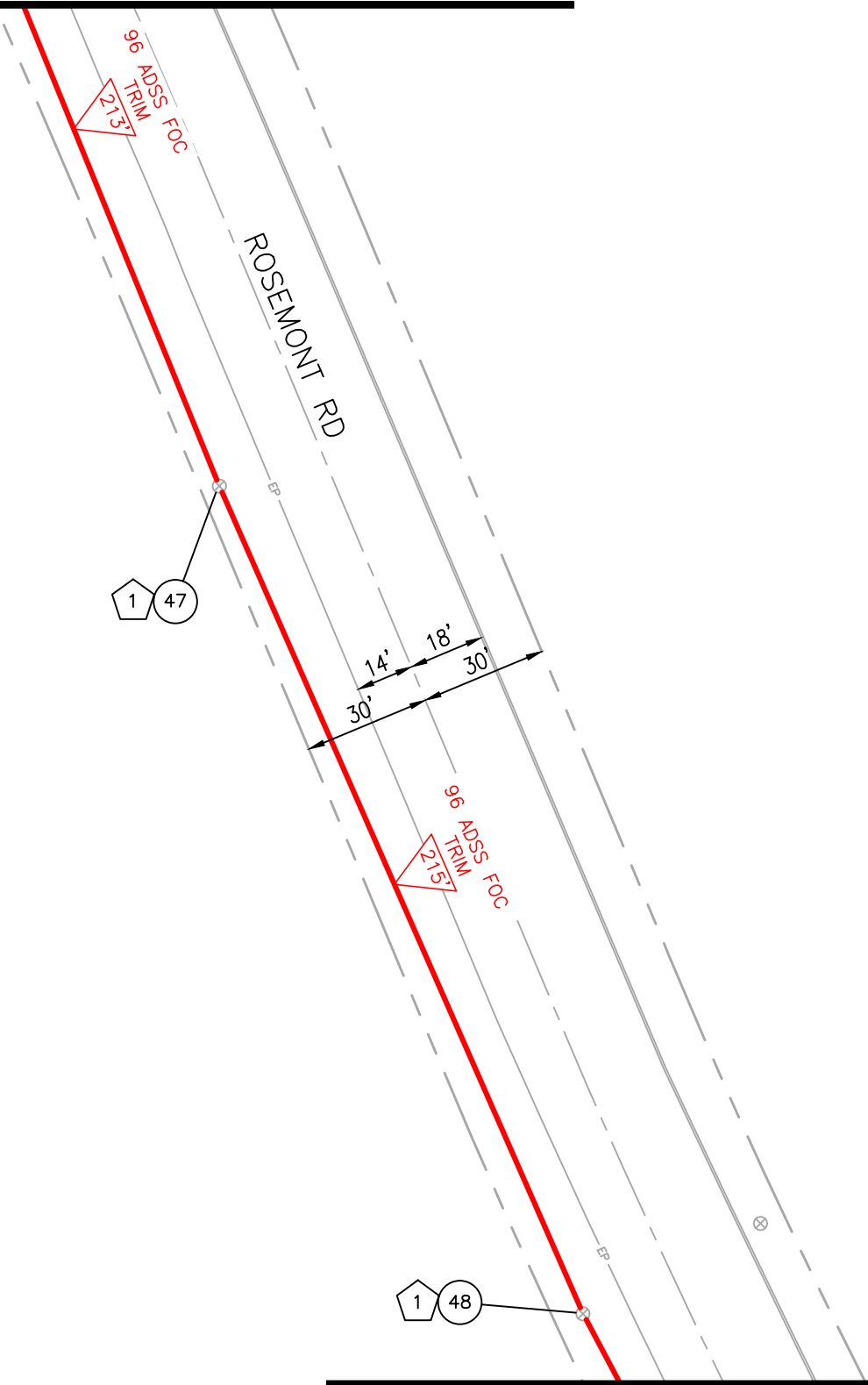

POLE INFORMATION:

- 47 PGE POLE #3941
MAP #D21-23
65'/CL-2/1989
NEUT= 29'-7"
CATV= 24'-6"

POA= 25'-6"
- 48 PGE POLE #3942
CTL #950
MAP #D21-23
70'/CL-1/1993
NEUT= 28'-10"
CATV= 25'-2"
CATV= 23'-4" (X-ING RD)
CTL= 22'-8"

POA= 25'-6"
LOWER CATV TO 24'-6"

ATTACHMENT
LEGEND

- 1 STRAND STRAIGHT
ATTACHMENT
- 2 STRAND DE ATTACHMENT
- 3 STRAND DDE
ATTACHMENT
- 4 STRAND 21-45 DEGREE
ATTACHMENT
- 5 ADSS DE ATTACHMENT
- 6 ADSS DDE ATTACHMENT
- 7 ADSS 21-45 DEGREE
ATTACHMENT
- 8 OVERLASH EXISTING
- 9 ANCHOR & GUY
- 10 DOWNGUY

MATCH TO SHT 26



6611 NE CHESTNUT ST
HILLSBORO, OR
PH: 503.730.1919
FAX: 503.640.0499

topcomllc.com

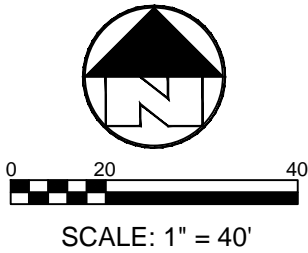

TWN:	2S
SEC:	
RNG:	1E
DSNR:	SL
FLDR:	SL
DRWN:	TAP
DATE:	12-1-18

ROSEMONT RD
CBX FIBER
STAFFORD TO BAY MEADOWS
WEST LINN, OR

DIAL **811**
CALL LOCATE
BEFORE YOU
DIG

OR-CLCK-242

SHT 25
OF 28

MATCH TO SHT 25

POLE INFORMATION:

49 PGE POLE #3943
MAP #D21-23C
65'/CL-1/2010
SEC= 29'-0"
CATV= 25'-6"
QUEST FIBER= 23'-7"

POA= 25'-6"

LOWER CATV TO 24'-6"

50 PGE POLE #4025
CTL #29
MAP #D21-23C
BT/BT/BT
SEC= 30'+
CATV= 25'-8"
QUEST FIBER= 23'-9"

POA= 26'-8"

PL DG TO EX ANC, L=27' (S)

ATTACHMENT
LEGEND

- 1 STRAND STRAIGHT ATTACHMENT
- 2 STRAND DE ATTACHMENT
- 3 STRAND DDE ATTACHMENT
- 4 STRAND 21-45 DEGREE ATTACHMENT
- 5 ADSS DE ATTACHMENT
- 6 ADSS DDE ATTACHMENT
- 7 ADSS 21-45 DEGREE ATTACHMENT
- 8 OVERLASH EXISTING
- 9 ANCHOR & GUY
- 10 DOWNGUY

ROSEMONT RD

HIDDEN SPRINGS RD

MATCH TO SHT 27



6611 NE CHESTNUT ST
HILLSBORO, OR
PH: 503.730.1919
FAX: 503.640.0499
topcomllc.com

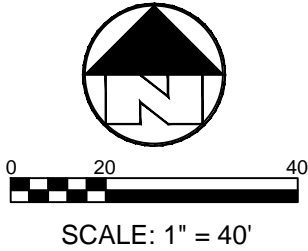

TWN:	2S
SEC:	
RNG:	1E
DSNR:	SL
FLDR:	SL
DRWN:	TAP
DATE:	12-1-18

ROSEMONT RD
CBX FIBER
STAFFORD TO BAY MEADOWS
WEST LINN, OR

DIAL **811**
CALL LOCATE
BEFORE YOU
DIG

OR-CLCK-242

SHT 26
OF 28

MATCH TO SHT 26

POLE INFORMATION:

51 PGE POLE #4026
CTL #28
PI #A1993290
MAP #D21-23C
70'/CL-1/2010
SEC RISER DRIP LOOP= 30'+
CATV= 30'-0"
QUEST FIBER= 27'-10"

POA= 31'-0"

MATCH STA 0+00 - SHT X

ATTACHMENT
LEGEND

- 1 STRAND STRAIGHT ATTACHMENT
- 2 STRAND DE ATTACHMENT
- 3 STRAND DDE ATTACHMENT
- 4 STRAND 21-45 DEGREE ATTACHMENT
- 5 ADSS DE ATTACHMENT
- 6 ADSS DDE ATTACHMENT
- 7 ADSS 21-45 DEGREE ATTACHMENT
- 8 OVERLASH EXISTING
- 9 ANCHOR & GUY
- 10 DOWNGUY

MATCH STA 0+00 - SHT X

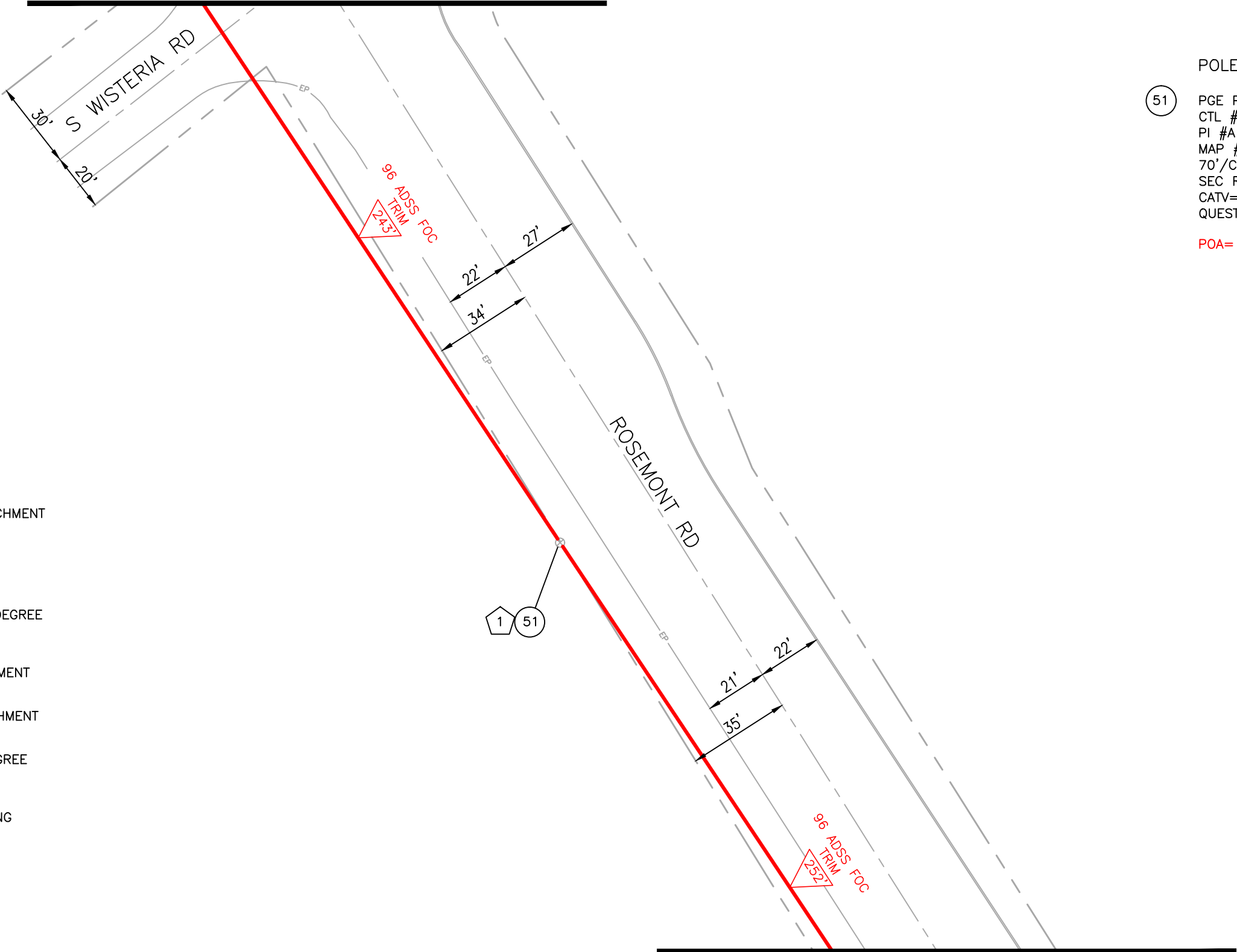

MATCH TO SHT 28



6611 NE CHESTNUT ST
HILLSBORO, OR
PH: 503.730.1919
FAX: 503.640.0499

topcomllc.com

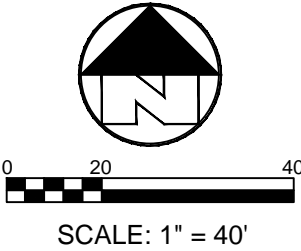

TWN:	2S
SEC:	
RNG:	1E
DSNR:	SL
FLDR:	SL
DRWN:	TAP
DATE:	12-1-18

ROSEMONT RD
CBX FIBER
STAFFORD TO BAY MEADOWS
WEST LINN, OR

DIAL **811**
CALL LOCATE
BEFORE YOU
DIG

OR-CLCK-242
SHT 27
OF 28

MATCH TO SHT 27

POLE INFORMATION:

- 52

PGE POLE #3944
CTL #27
PI #A1085179
MAP #D21-26
70'/CL-1/1973
SEC DRIP LOOP= 29'-10"
CATV= 21'-9"
QUEST FIBER= 20'-7"

POA= 22'-9"
- 53

PGE POLE #3942
CTL #26
PI #A1724212
MAP #D21-26B
70'/CL-1/2011
SEC RISER DRIP LOOP= 30'-0"
CATV= 25'-7"
QUEST FIBER= 24'-6"
CTL= 23'-9"

POA= 26'-7"

REMOVE ANC & DG, L=16' (NW)

ATTACHMENT
LEGEND

- 1

STRAND STRAIGHT
ATTACHMENT
- 2

STRAND DE ATTACHMENT
- 3

STRAND DDE
ATTACHMENT
- 4

STRAND 21-45 DEGREE
ATTACHMENT
- 5

ADSS DE ATTACHMENT
- 6

ADSS DDE ATTACHMENT
- 7

ADSS 21-45 DEGREE
ATTACHMENT
- 8

OVERLASH EXISTING
- 9

ANCHOR & GUY
- 10

DOWNGUY

1 52

1 53

SPLICE INTO EX CBX COIL
PL SPLICE CASE

ROSEMONT RD

96 ADSS FOC
252' TRIM

20'
25'
37'

100'



6611 NE CHESTNUT ST
HILLSBORO, OR
PH: 503.730.1919
FAX: 503.640.0499

topcomllc.com

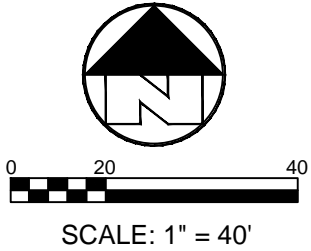

TWN:	2S
SEC:	
RNG:	1E
DSNR:	SL
FLDR:	SL
DRWN:	TAP
DATE:	12-1-18

ROSEMONT RD
CBX FIBER
STAFFORD TO BAY MEADOWS
WEST LINN, OR

DIAL
811
CALL LOCATE
BEFORE YOU
DIG

OR-CLCK-242
SHT 28
OF 28