

OREGON PUBLIC LAND CORNER REPORT / RESTORATION FORM

Clackamas County Surveyor's Office
 Development Services Building
 150 Beavercreek Road, #325
 Oregon City, OR 97045

SECTION	TOWNSHIP	RANGE
COUNTY: CLACKAMAS		DATE
CORNER DESIGNATION:		(Please check one)
		<input type="checkbox"/> Condition Report Only
		<input type="checkbox"/> Not Found
		<input type="checkbox"/> Renewed
		<input type="checkbox"/> Unrecorded
		<input type="checkbox"/> Surveyed In
		<input type="checkbox"/> Referenced Out
Previous Renewals/Surveys, etc.		
Monument(s) & Accessories Found: (Condition and Source)		
Monument Detail:	Sketch:	
Monument Set (Procedures and Description):		
New Accessories:		
Location & Comments:		Compass Declination:
Firm/Agency		SURVEYOR'S SEAL
Address:		
Party Chief		
Notes		
Witness		

INSTRUCTIONS FOR COMPLETION:

OREGON PUBLIC LAND CORNER REPORT / RESTORATION FORM
TO BE PLACED ON 18" X 24" POLYESTER FILM W/STANDARD LAYOUT

The purpose of this form is to outline an optional method of supplying information to the public when there is a change in condition of a monument, but a Record of Survey Map is not required to be filed. This form should be filled out as completely as possible. If no new monument or accessories are set, please state that in the appropriate location.

The *original* document must be filed at the Office of the County Surveyor. **DO NOT EMAIL** completed form to the County Surveyor's Office. Please copy form into AutoCAD, make your additions and plot on archival mylar with archival ink. There is no charge to file this report with the Clackamas County Surveyor.

If you have any questions, please contact the Office of the Clackamas County Surveyor at (503) 742-4475.

The following information is required:

- Section, township, range
- Previous restorations/surveys
- Monument and accessories found
- Monument detail and sketch
- Monument or references set
- Basis of bearings
- Firm name/address/phone number
- Seal and signature
- More than one corner may be reported on the same sheet

***NOTE:** These instructions supersede any of the previous instructions.

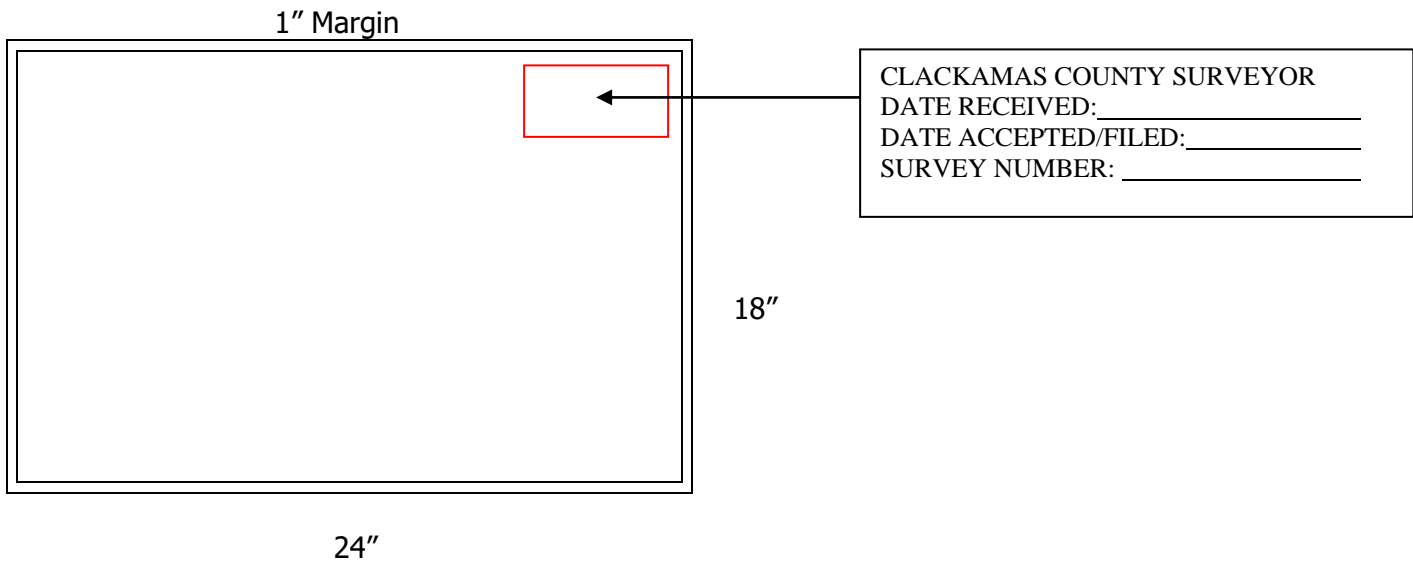

The report must meet current archival standards and be prepared on 18" x 24" polyester film. Current standards may be found at: <http://www.clackamas.us/surveyor/poly.html>