

CLACKAMAS COUNTY BOARD OF COUNTY COMMISSIONERS

Policy Session Worksheet

Presentation Date: 03/23/2021 **Approx Start Time:** 2:00 pm **Approx Length:** 30 mins

Presentation Title: Eagle Fern Weir Removal

Department: Business and Community Services (BCS), County Parks Division

Presenters: Tom Riggs, Parks and Forestry Manager
Sarah Eckman, BCS Deputy Director

Other Invitees: Dave Stewart, Oregon Department of Fish and Wildlife
Laura Zentner, BCS Director

WHAT ACTION ARE YOU REQUESTING FROM THE BOARD?

Sign a landowner letter of support for the proposed Eagle Fern Weir Removal project, so that partner organizations may seek grant opportunities for funding the project.

EXECUTIVE SUMMARY:

Oregon Department of Fish and Wildlife (ODFW) is working with several partner organizations in proposing a project at Eagle Fern County Park, to remove an old concrete weir (dam), and stabilize the bank with large wood and riparian planting where applicable. The goal is to remove the structure to restore fish passage and natural channel processes and reduce streambank erosion risk following removal. The weir was originally constructed as a recreational "swimming hole" feature at the park. BCS/Parks staff have made ODFW aware of concerns about recreational impacts, such as the loss of swimming opportunities, maintaining the beach area, and potential risks to the footbridge abutments downstream from the weir. ODFW is addressing public recreational use in their planning. The weir is also aging, and being undercut in places by the current, and this project allows the County to avoid potential future safety concerns by having the weir removed at almost no cost to the County.

As the landowner, support for the project from Clackamas County is critical to ODFW and partner organizations being able to seek grant support for funding the project. The total proposed project cost is approximately \$129,000, and ODFW is only asking the County to contribute \$960 to obtain a Floodplain Development Permit. The remainder of the project costs would be covered by partners and grants.

FINANCIAL IMPLICATIONS (current year and ongoing):

Is this item in your current budget? YES NO

What is the cost? \$960.00 for a Floodplain Development Permit

What are the funding sources? Parks budget (Fund 213)

STRATEGIC PLAN ALIGNMENT:

- How does this item align with your Department's Strategic Business Plan goals?

Supporting this project aligns with the BCS strategic result of maintaining clean, safe, healthy parks by permitting a project to move forward which improves fish passage, restores natural stream function, and mitigates public safety concerns related to the weir as it ages.

- **How does this item align with the County's Performance Clackamas goals?**

Supporting this project aligns with the Performance Clackamas strategic priority of Honoring our Natural Resources by supporting improved fish passage and restoration of natural stream function.

LEGAL/POLICY REQUIREMENTS:

Staff verified that the weir serves no current water rights.

PUBLIC/GOVERNMENTAL PARTICIPATION:

The proposed project has been discussed by the Parks Advisory Board and recommended for approval.

OPTIONS:

- 1) Issue a landowner letter of support for the project
- 2) Do not issue a letter of support, but allow the project to proceed
- 3) Do not support or allow the project to proceed

RECOMMENDATION:

Staff recommends Option 1: Issue a landowner letter of support for the project

ATTACHMENTS:

Eagle Fern Weir Removal Proposal Presentation

SUBMITTED BY:

Division Director/Head Approval _____
Department Director/Head Approval Laura Zentner 3/17/2021
County Administrator Approval _____

For information on this issue or copies of attachments, please contact Tom Riggs at 503-742-4345

Eagle Fern Weir Removal Proposal

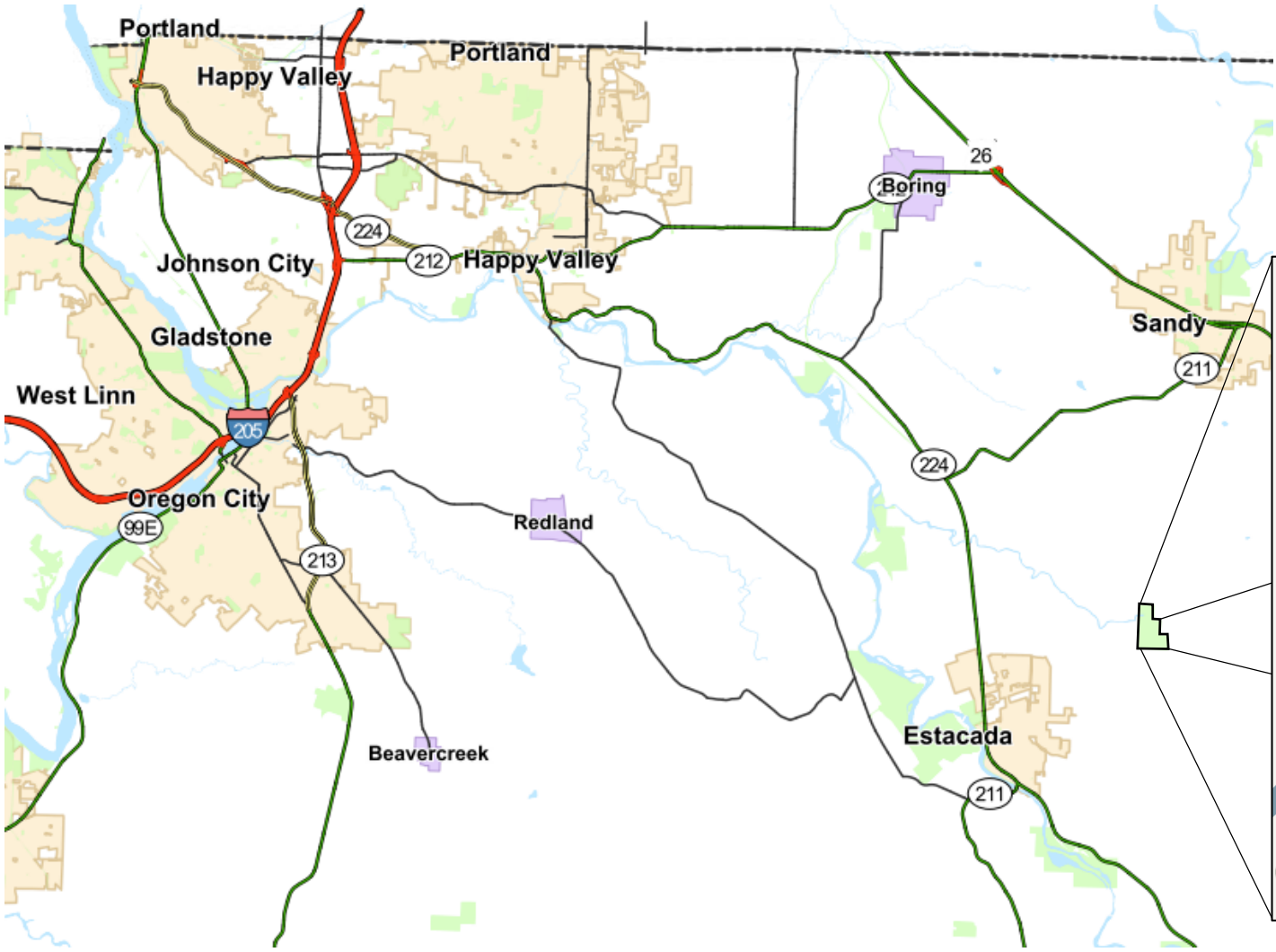

- LEGEND**
- (E) CONTOURS BY WW
 - (E) SURVEY CONTROL POINT
 - (E) ALIGNMENT
 - (E) THALWEG
 - (E) ORDINARY HIGH WATER
 - (E) FLOW DIRECTION
 - (E) BEDROCK
 - (E) CONCRETE
 - (E) SANDY BEACH
 - (E) TREE

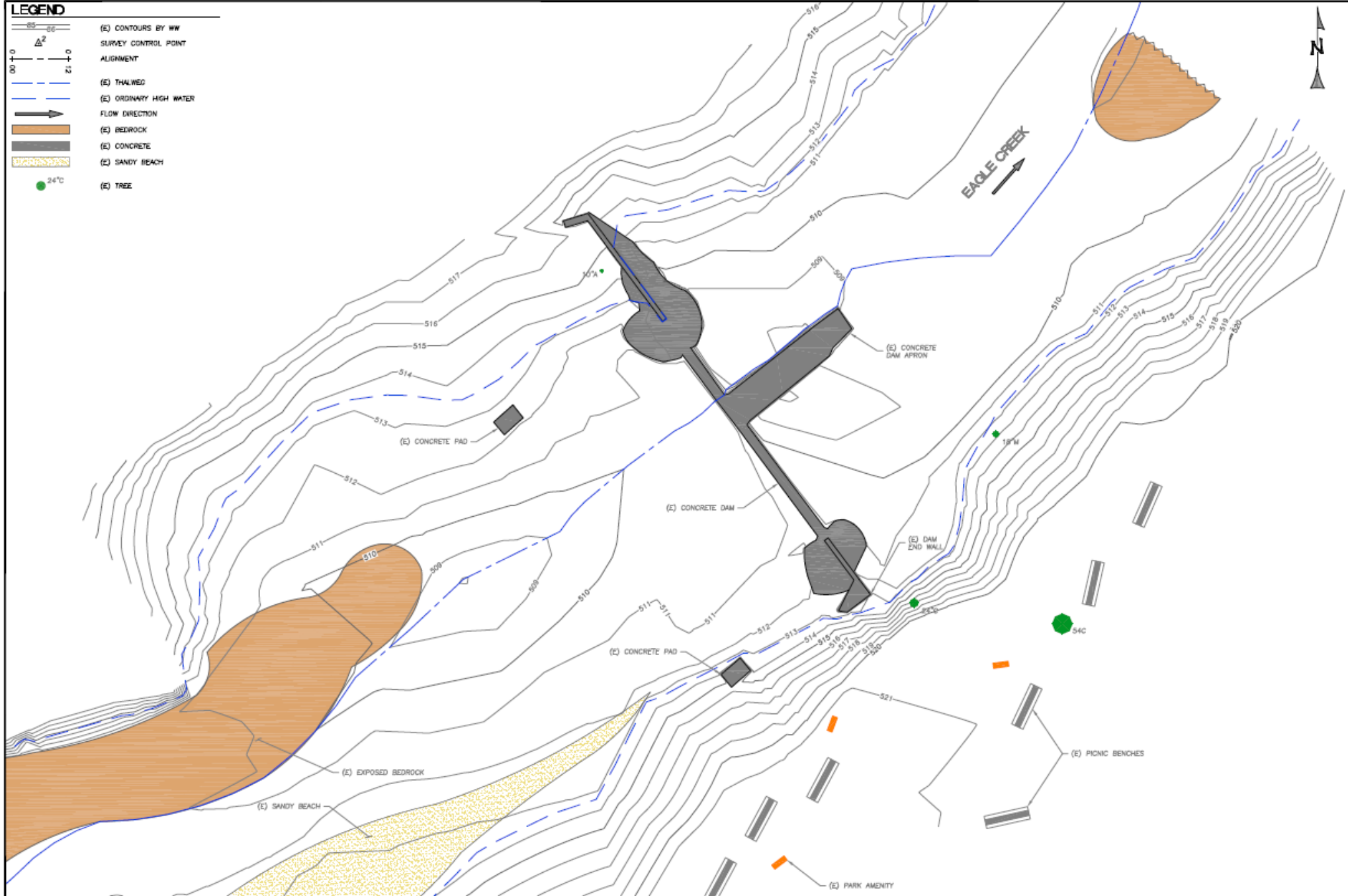

EXISTING CONDITIONS
SCALE 1" = 10'

WATERWAYS CONSULTING INC.
1020 SW TAYLOR STREET, STE. 300
PORTLAND, OREGON 97205 / PHONE 503-251-4847
WWW.WATERWAYS.COM

PRELIMINARY
NOT FOR CONSTRUCTION

PREPARED AT THE REQUEST OF
OREGON WILDLIFE FOUNDATION

EXISTING CONDITIONS

EAGLE CREEK AT EAGLE FERN PARK FISH PASSAGE PROJECT
DRAFT 66% DESIGN

DESIGNED BY: J.H.
DRAWN BY: J.H./M.L.
CHECKED BY: J.D.
DATE: 11/13/20
JOB NO.: 12-035









BAR IS ONE INCH ON ORIGINAL DRAWING. ADJUST SCALES FOR REDUCED PLOTS.







LEGEND

-  (E) CONTOURS BY WW
-  PROPOSED CONTOURS
-  (E) ORDINARY HIGH WATER
-  (N) STRAW WATTLE
-  FLOW DIRECTION
-  (N) SLOPE PROTECTION FABRIC
-  (E) CONCRETE
-  (C) TREE



BANK STABILIZATION AND EROSION CONTROL PLAN
SCALE: 1" = 3'

WATERWAYS CONSULTING INC.
1020 SW TAYLOR STREET, STE. 380
PORTLAND, OR 97205
PH: (503) 227-3999 / FAX: (503) 227-6847
WWW.WATERWAYS.COM

PRELIMINARY
NOT FOR CONSTRUCTION

PREPARED AT THE REQUEST OF
OREGON WILDLIFE FOUNDATION

BANK STABILIZATION AND EROSION CONTROL PLAN

EAGLE CREEK AT EAGLE FERN PARK FISH PASSAGE PROJECT
DRAFT 65% DESIGN

DESIGNED BY: J.H.
DRAWN BY: J.H./M.L.
CHECKED BY: J.D.
DATE: 11/13/20
JOB NO.: 19-035

BAR IS ONE INCH ON ORIGINAL DRAWING. ADJUST SCALES FOR REDUCED PLOTS

Eagle Fern Weir Removal Project Partners

Oregon Department of Fish and Wildlife: Project Management

American Rivers: \$49,000 for construction

Resources Legacy Fund: \$40,000 for design and consulting

Oregon Wildlife Foundation: \$25,000 for construction

Oregon Watershed Enhancement Board: \$15,000 construction

Trout Unlimited: Volunteer Outreach

Confluence Consulting: Project Oversight

Waterways Consulting: Design

Dave Bugni: Representing the Eagle Creek Restoration Plan

PGE: Supportive of project, funded multiple Eagle Creek Projects nearby

Watershed Council: Supportive, have provided in-kind support for multiple Eagle Creek Projects

Eagle Fern Weir Removal Project

Summary: A roughly \$129,000 project to improve fish passage and safety, and restore natural creek functioning

County Parks Contribution: staff support for process, and \$960 for a Floodplain Development Permit

Requesting from BCC: A landowner letter of support for the project, so our partners can pursue the identified grant funding opportunities.