

Option 1: Multi-Use Path

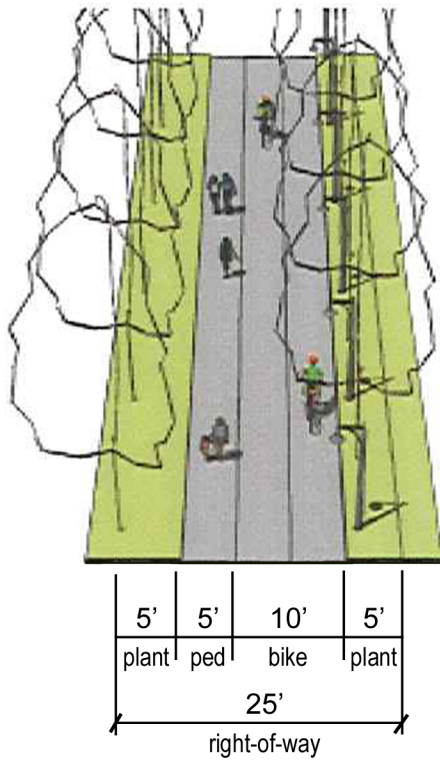

Option 2: Walkway

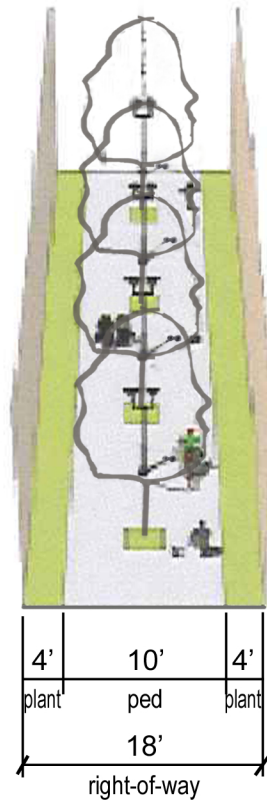

Option 3: Alley/Universal Access

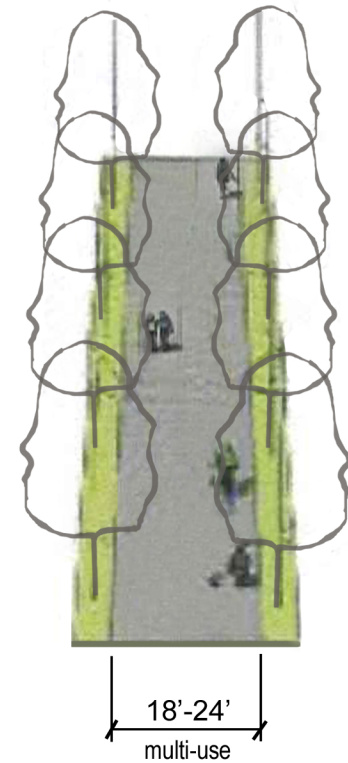

NOTES

* UTILITY EASEMENT MAY BE REQUIRED OUTSIDE OF RIGHT-OF-WAY.

**Clackamas Regional Center Area Design Plan
Fuller Road Station Community, Type "E"
Pedestrian/Bicycle Connection**

CLACKAMAS COUNTY
COMPREHENSIVE PLAN

FIGURE 10-CRC-11

March 7, 2011

