



INVITATION TO BID #2018-40
Dickey Prairie Road Pavement Distress Mitigation
ADDENDUM NUMBER 1
May 16, 2018

On May 14, 2018, Clackamas County ("County") published Invitation to Bid #2018-40 ("BID"). The County has found that it is in its interest to amend the BID through the issuance of this Addendum #1. Except as expressly amended below, all other terms and conditions of the original BID shall remain unchanged.

1. The following drawings have been added to the Project Information, Plans, Specifications, and Drawings:

PAVEMENT DISTRESS MITIGATION DICKY PRAIRIE ROAD Drawing Set:
Sheet No. 11-13.

Attachments:

PAVEMENT DISTRESS MITIGATION DICKY PRAIRIE ROAD Drawing Set:
Sheet No. 11-13.

End of Addendum #1

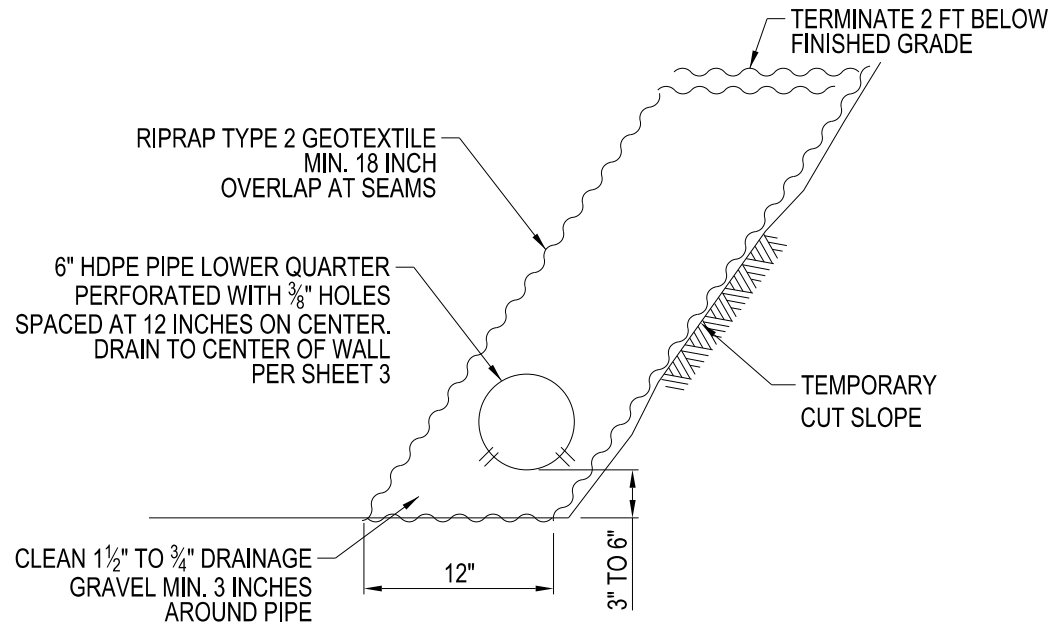

WALL DRAIN
SCALE: NOT TO SCALE

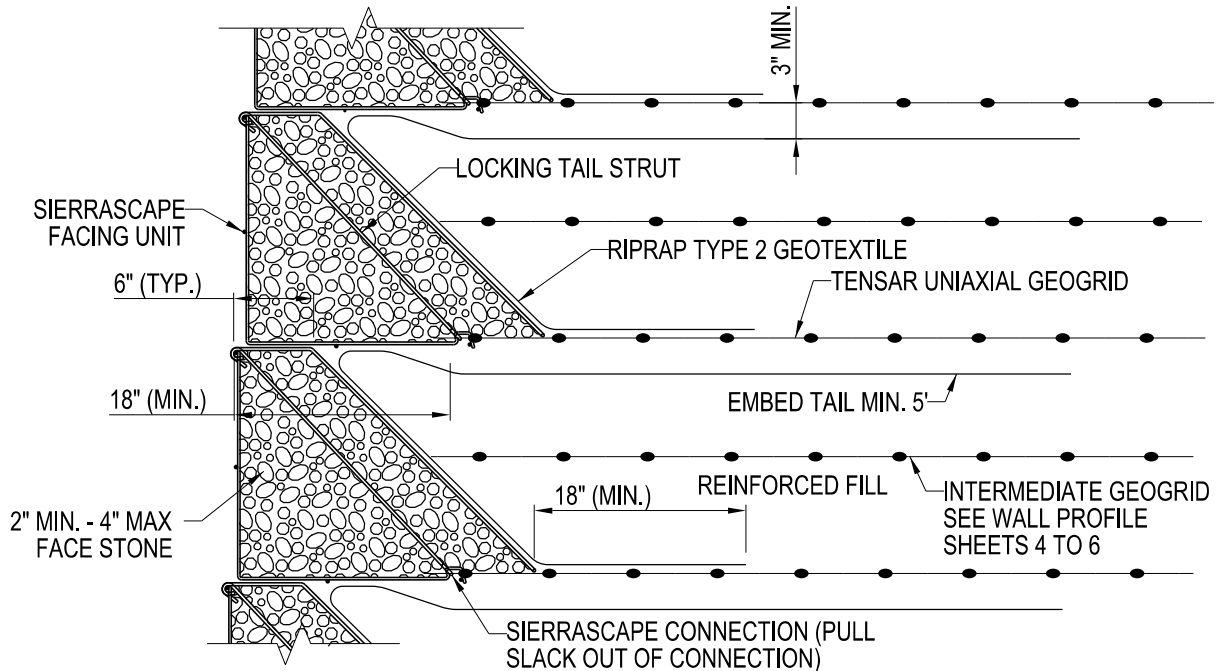

- NOTES:**
1. SEE SIERRASCAPE FACING UNIT DETAIL FOR FACING MATERIAL AND DIMENSIONS.
 2. ALL FACING UNITS SHALL BE GALVANIZED PER ASTM A123 AFTER FABRICATION.
 3. A THIN LAYER (2" MAX.) OF FINER STONE (1/4"-1") MAY BE PLACED AT THE TOP OF EACH UNIT PER DIRECTION OF THE ENGINEER TO PROVIDE A LEVEL SURFACE FOR THE UNIT ABOVE AND SHALL BE INCIDENTAL TO WALL BID ITEM.

SIERRASCAPE STONE FACING DETAIL
SCALE: NOT TO SCALE

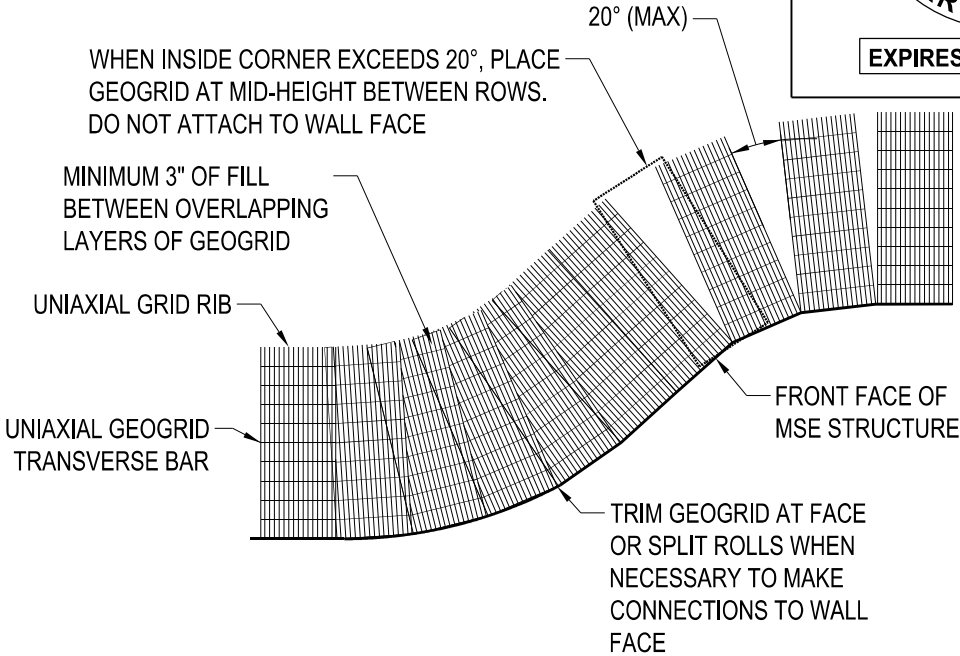

GEOGRID PLACEMENT ON CURVES DETAIL
SCALE: NOT TO SCALE

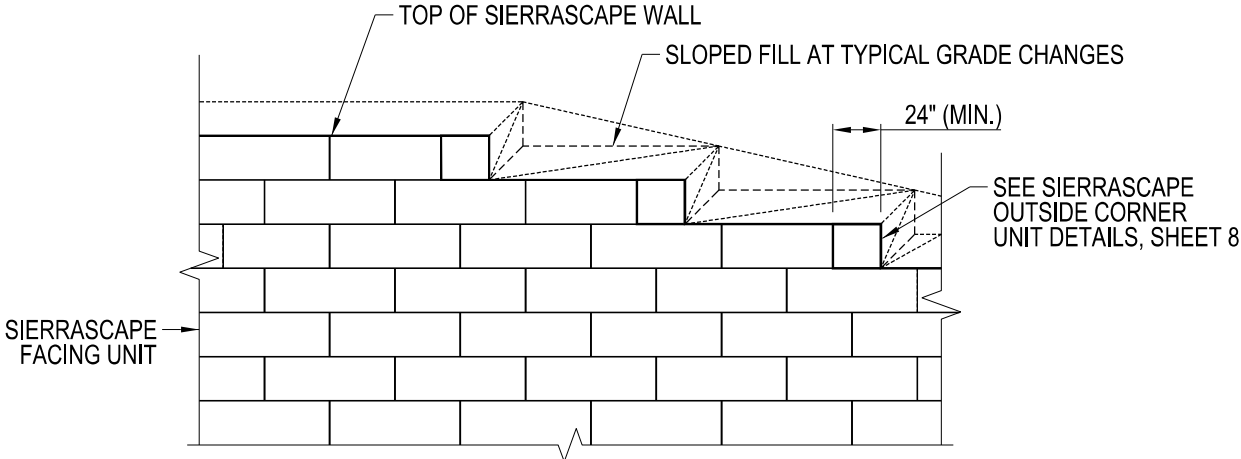

- NOTES:**
1. SEE SIERRASCAPE FACING UNIT DETAIL FOR FACING MATERIALS AND DIMENSIONS.
 2. USE SIERRASCAPE FACING UNIT TO FABRICATE CONTINUOUS CORNER. PROVIDE 24" (MIN.) OF SIERRASCAPE FACING UNIT IN BOTH DIRECTIONS AS MEASURED FROM THE CORNER BEND.
 3. INSTALL ADJACENT SIERRASCAPE FACING UNITS TO PROVIDE 2.4" OVERLAP OF HORIZONTAL WIRES.

TOP OF SIERRASCAPE WALL, FINISHING DETAIL
SCALE: NOT TO SCALE

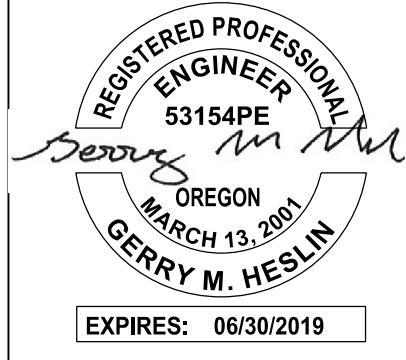

DICKEY PRAIRIE ROAD MSE TYPICAL DETAILS 3	
CLACKAMAS COUNTY DEPT. OF TRANSPORTATION AND DEVELOPMENT 150 BEAVERCREEK ROAD OREGON CITY, OR 97045	
DESIGNED BY: AK	DRAFTED BY: DWS
CHECKED BY: GMH	NO. DATE:
Sheet No. 11	

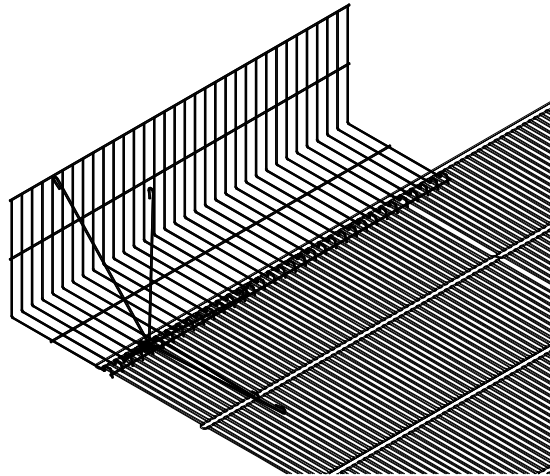

STEP 1: INSTALL THE SIERRASCAPE FACING ELEMENTS ON LEVEL GRADE

INSTALL SEQUENCE (STEP 1)

SCALE: NOT TO SCALE

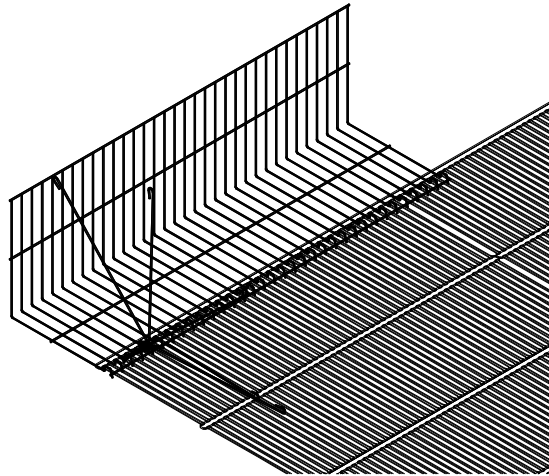

STEP 2: ATTACH UNIAxIAL GEOGRID TO FACING ELEMENT.

INSTALL SEQUENCE (STEP 2)

SCALE: NOT TO SCALE

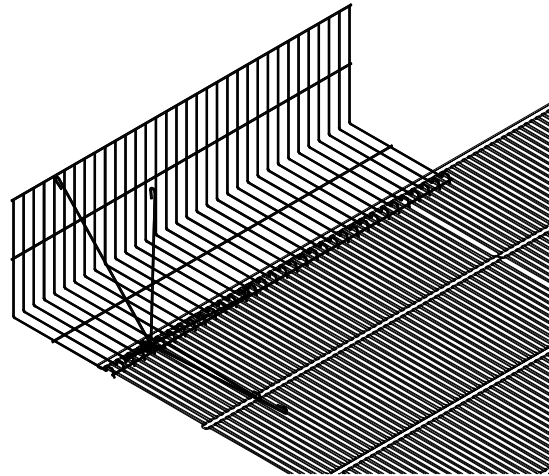

STEP 3: THREAD THE LOCKING TAIL STRUT THROUGH THE CONNECTION LOOP OVER THE RIBS OF THE UNIAxIAL GEOGRIDS.

INSTALL SEQUENCE (STEP 3)

SCALE: NOT TO SCALE

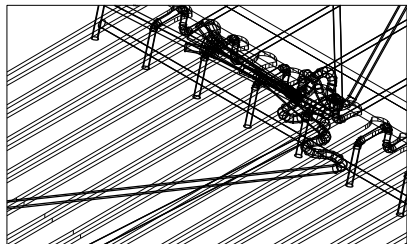

LOCKING TAIL STRUT THREADING ENLARGEMENT (1)

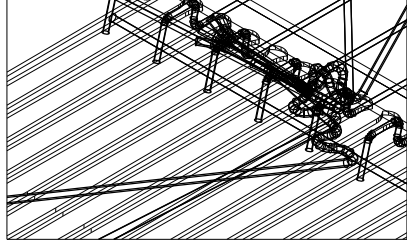

LOCKING TAIL STRUT THREADING ENLARGEMENT (2)

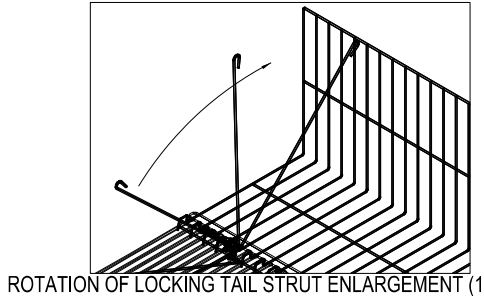

ROTATION OF LOCKING TAIL STRUT ENLARGEMENT (1)

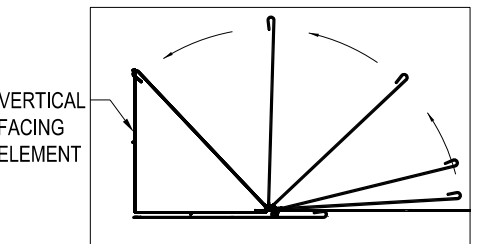

ROTATION OF LOCKING TAIL STRUT ENLARGEMENT (2)

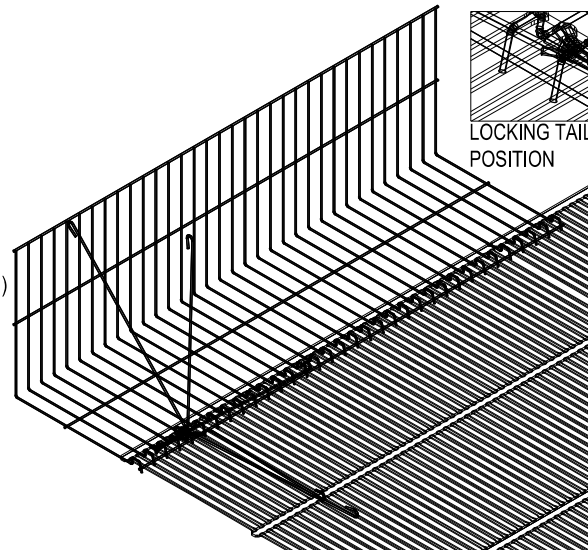

STEP 4: ROTATE LOCKING TAIL STRUT TOWARD TOP OF FACING ELEMENT. CONNECT THE TOP AND BACK HORIZONTAL WIRES OF THE FACING ELEMENT WITH LOCKING TAIL STRUT SPACED APPROXIMATELY 16 IN. APART.

INSTALL SEQUENCE (STEP 4)

SCALE: NOT TO SCALE



LOCKING TAIL STRUT LOCKED POSITION

CUT GEOGRID TRANSVERSE BAR AT APERTURES BETWEEN WIRE PAIRS TO ALLOW CONTACT BETWEEN GEOGRID AND LOOPS (MAXIMUM OF 5 CUTS PER ROLL WIDTH OF GEOGRID)

LOCKING TAIL STRUTS
16" C-C MAX.
(AS REQUIRED)

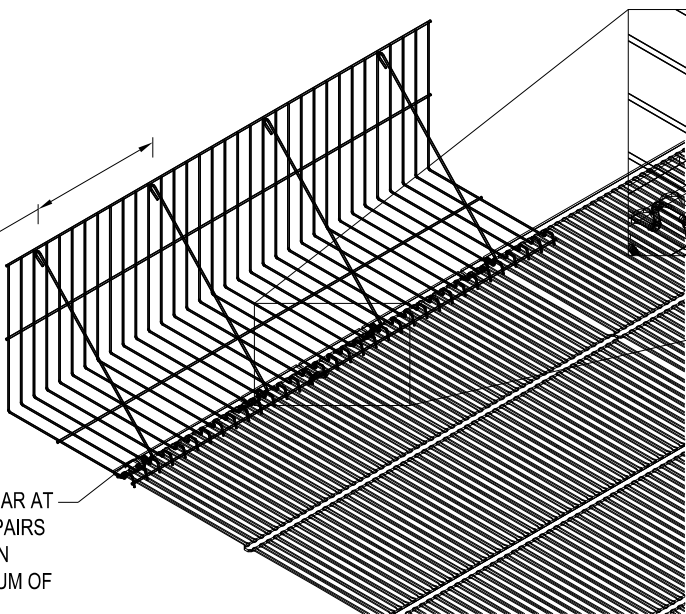

SIERRASCAPE FACING ELEMENT WITH LOCKING TAIL STRUT COMPLETE VIEW

INSTALL SEQUENCE (STEP 5)

SCALE: NOT TO SCALE

IF CUT IS MADE BETWEEN LOCKING TAIL STRUTS, FASTEN GRID TO BASKET WITH TIE WIRE OR HOG RING UNTIL BACKFILL HAS BEEN PLACED

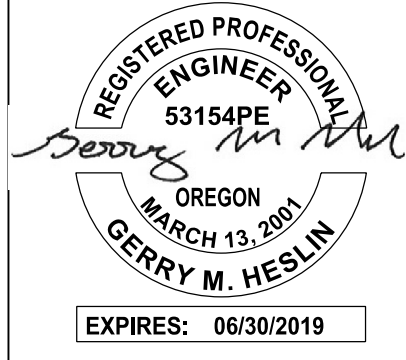

CLACKAMAS COUNTY
DEPT. OF TRANSPORTATION
AND DEVELOPMENT
150 BEAVERCREEK ROAD
OREGON CITY, OR 97045

**DICKEY PRAIRIE ROAD
MSE TYPICAL DETAILS 4**

DESIGNED BY: AK
DRAFTED BY: DWS
CHECKED BY: GMH

REVISIONS

NO.	DATE	DESCRIPTION

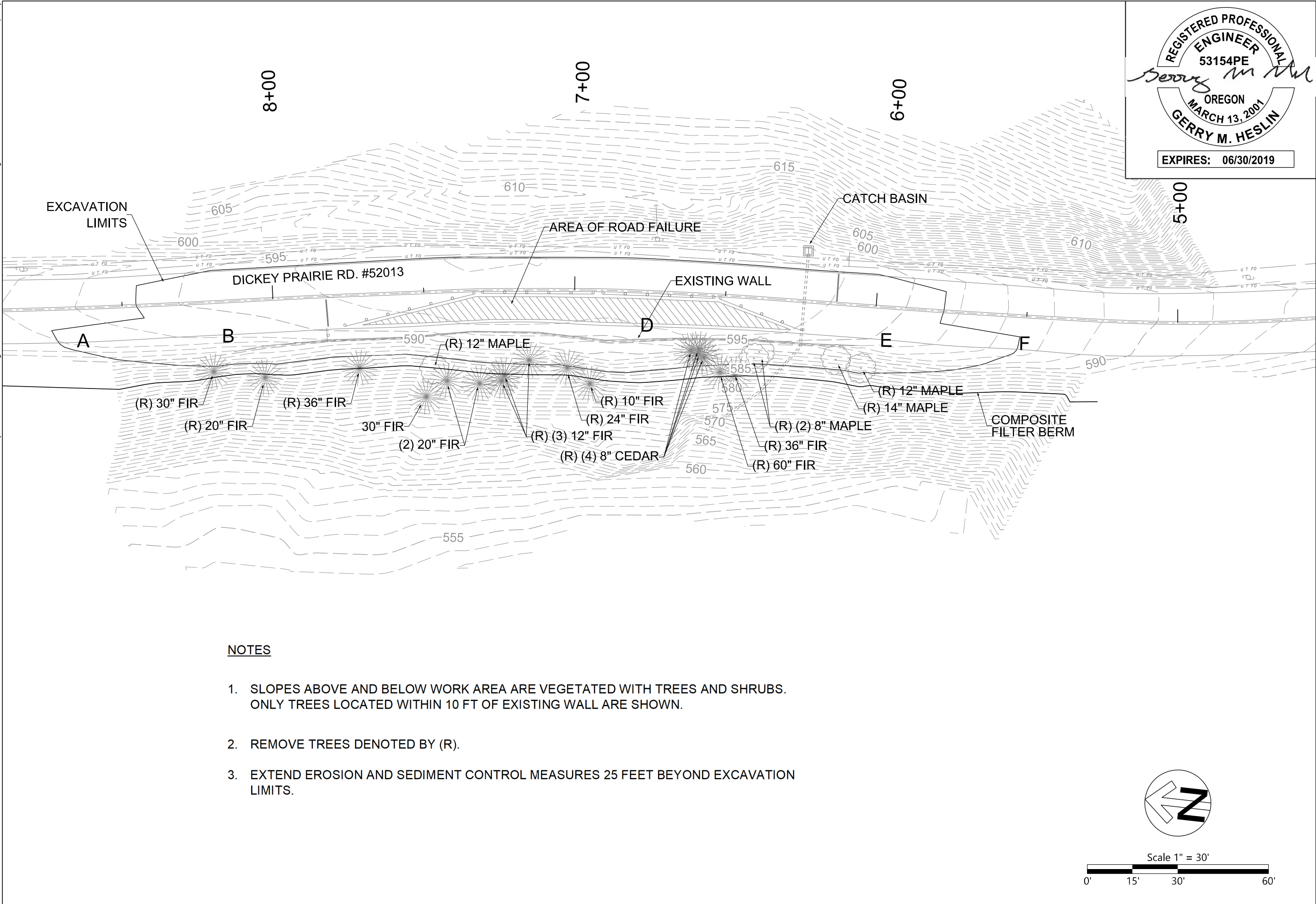

NOTES

1. SLOPES ABOVE AND BELOW WORK AREA ARE VEGETATED WITH TREES AND SHRUBS. ONLY TREES LOCATED WITHIN 10 FT OF EXISTING WALL ARE SHOWN.
2. REMOVE TREES DENOTED BY (R).
3. EXTEND EROSION AND SEDIMENT CONTROL MEASURES 25 FEET BEYOND EXCAVATION LIMITS.

CLACKAMAS COUNTY DEPT. OF TRANSPORTATION AND DEVELOPMENT 150 BEAVERCREEK ROAD OREGON CITY, OR 97045	
	
DESIGNED BY: AK	CHECKED BY: GMH
DRAFTED BY: DWS	
REVISIONS	
NO. DATE:	
Sheet No. 13	

PROJECT NO.: RM 2017-19
DATE: 04-2018

**DICKEY PRAIRIE ROAD
EROSION CONTROL AND TREE
REMOVAL**