

VOTER INFORMATION

YOU MAY REGISTER TO VOTE IF:

1. You are a resident of Oregon;
2. You will be 18 or older on election day, and
3. You are a United States citizen.

YOU MUST UPDATE YOUR REGISTRATION IF:

1. Your residence or mailing address changes;
2. Your name changes, or
3. You wish to change political affiliation.

To be eligible to vote, you must be registered by the close of business on the 21st day before an election. If you have any questions on registration or updating your registration, contact the Elections Division at 503.655.8510.

BALLOT DROP SITES

Your voted ballot must be received in any county election office or drop site location by 8:00 p.m. on election night, Tuesday, November 8. Remember: The postmark does not count. If you prefer, instead of mailing your ballot, you may take it to one of the Drop Site Locations, listed below. A complete list of drop sites can be found at <http://www.co.clackamas.or.us/elections/drop/site/locations.htm>.

Lake Oswego Library
706 S.W. 4th Street, Lake Oswego
Phone: 503.636.7628

Mon -- Thur 10:00 am -- 9:00 pm
Fri, Sat 10:00 am -- 6:00 pm
Sun 1:00 pm -- 6:00 pm
Tue 11/8 10:00 am -- 8:00 pm

Clackamas County Elections
825 Portland Ave., Gladstone
Phone: 503.655.8510

Mon -- Fri 8:30 am -- 5:00 pm
Election Day 7:00 am -- 8:00 pm

Ballot drop slot (front of building, to the right of the front door) is available 24 hours every day.

Measure No. 3-191

CITY OF RIVERGROVE

ANNEXES PROPERTY INTO THE CITY OF RIVERGROVE

QUESTION: Shall property located at 5470 Childs Road be annexed into the City of Rivergrove?

SUMMARY: This measure would preliminarily approve the annexation of 2.95 acres of land located at 5470 Childs Road into the City of Rivergrove. No determination has been made as to whether the proposal complies with the annexation criteria of RLDO Section 6.235, including consideration of conformity to the comprehensive plan, or Metro Code Section 3.09.040. This annexation proposal will be forwarded to the Planning Commission for a recommendation as to whether the proposal complies with the applicable criteria of the RLDO and Metro Code and then forwarded to the City Council for approval. The annexation would become effective only after the City Council finds that all applicable criteria are met and it is approved by a majority of the voters with the City.

Once annexation is effective, the property will be incorporated within the City and all further development on the property will be subject to review under the requirements of the Rivergrove Land Development Ordinance.

EXPLANATORY STATEMENT:

This measure would approve annexation of 2.95 acres into the city limits of the City of Rivergrove. The property is located at 5470 Childs Road and identified in the Clackamas County Tax Records as Tax Map 2 1E 19AC, Tax Lot #01300. The property is contiguous to the city limits on its western, northern and eastern borders. The current zoning on the property is R-10 (Urban Low Density Residential), Clackamas County. Upon annexation to the City of

Rivergrove, the property will be subject to the City's Residential zoning.

Debbie and Herman Stonebraker, the property owners, and Peter Kusyk of Beacon Homes Northwest, have applied to the City of Rivergrove for approval of this annexation request as allowed by Oregon law. A single family residence currently exists on the property. The city, following its Charter, is putting this matter before the voters for approval.

No determination has yet been made as to whether the proposal complies with the annexation criteria of Rivergrove Land Development Ordinance (RLDO) Section 6.235, including consideration of conformity to the comprehensive plan or Metro Code Section 3.09.040. The annexation would become effective only after the annexation measure is approved by the voters and the Planning Commission and the City Council find that all applicable land use criteria are met.

The Rivergrove City Council conducted a public hearing on August 8, 2005 and approved this application for inclusion on the November 2005 ballot by adopting Resolution 204-2005 by a 4-0 vote.

Furnished by:
Mike Collmeyer
City Recorder

(Map of property to be annexed can be found on the reverse side.)

NO ARGUMENTS FOR OR AGAINST THIS MEASURE WERE FILED.

MEASURE 3-191 City of Rivergrove

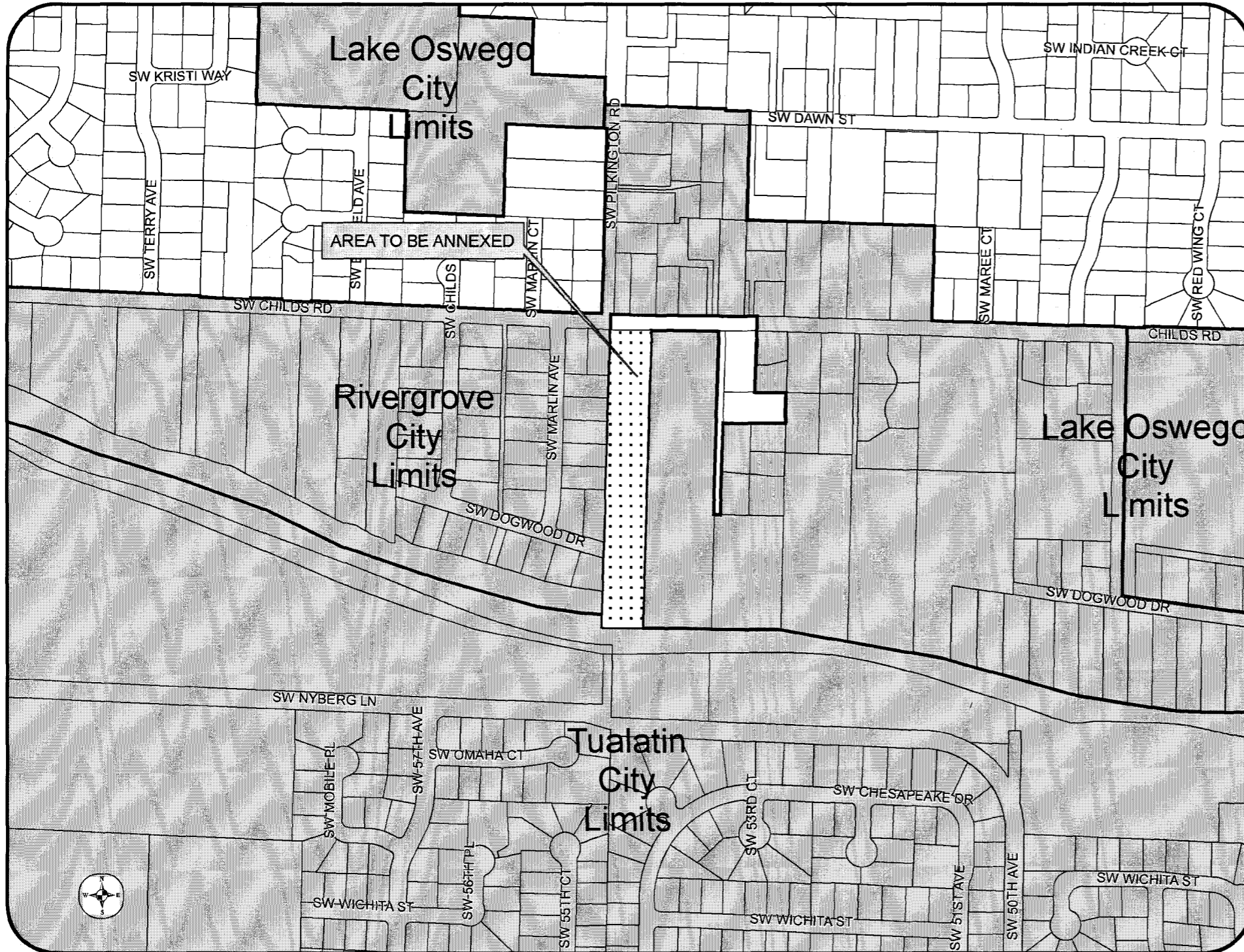

**CLACKAMAS COUNTY
VOTERS' PAMPHLET**

**SPECIAL ELECTION
November 8, 2005**

Ballots must be returned to
Clackamas County Elections
825 Portland Avenue
Gladstone, OR 97027
by 8:00 p.m.,
November 8, 2005

Measure text, explanatory
statement and arguments
are printed as filed.

SHERRY HALL
County Clerk



STYLE 3

VOTER INFORMATION

YOU MAY REGISTER TO VOTE IF:

1. You are a resident of Oregon;
2. You will be 18 or older on election day, and
3. You are a United States citizen.

YOU MUST UPDATE YOUR REGISTRATION IF:

1. Your residence or mailing address changes;
2. Your name changes, or
3. You wish to change political affiliation.

To be eligible to vote, you must be registered by the close of business on the 21st day before an election. If you have any questions on registration or updating your registration, contact the Elections Division at 503.655.8510.

BALLOT DROP SITES

Your voted ballot must be received in any county election office or drop site location by 8:00 p.m. on election night, Tuesday, November 8. Remember: The postmark does not count. If you prefer, instead of mailing your ballot, you may take it to one of the Drop Site Locations, listed below. A complete list of drop sites can be found at <http://www.co.clackamas.or.us/elections/dropsite/locations.htm>.

Lake Oswego Library

706 S.W. 4th Street, Lake Oswego

Phone: 503.636.7628

Mon -- Thur 10:00 am -- 9:00 pm

Fri, Sat 10:00 am -- 6:00 pm

Sun 1:00 pm -- 6:00 pm

Tue 11/8 10:00 am -- 8:00 pm

Clackamas County Elections

825 Portland Ave., Gladstone

Phone: 503.655.8510

Mon -- Fri 8:30 am -- 5:00 pm

Election Day 7:00 am -- 8:00 pm

Ballot drop slot (front of building, to the right of the front door) is available 24 hours every day.

Measure No. 26-75

RIVERDALE SCHOOL (JT)

FIVE-YEAR LOCAL OPTION TAX FOR DISTRICT OPERATIONS

QUESTION: Shall the District levy \$1.07 per \$1000 of assessed value each year for five years beginning 2006-2007 for operations?

SUMMARY: This measure may be passed only at an election with at least a 50 percent voter turnout. This measure authorizes Riverdale School District No. 51J, Multnomah and Clackamas Counties, Oregon, to levy a property tax in the amount of \$1.07 per \$1000 of assessed value each year for five years. The taxes would be used to help finance District operations. Without the additional revenue, the District will have to reduce staff and services.

An estimate of the total amount to be raised each fiscal year is: \$460,000 in 2006-2007; \$460,000 in 2007-2008; \$460,000 in 2008-2009; \$460,000 in 2009-2010; and \$460,000 in 2010-2011.

EXPLANATORY STATEMENT

What is this Local Option measure?

- A renewal of the existing Local Option levy approved by Riverdale School District voters in 2000 and an increase in the levy rate as allowed by the State Legislature.

Why does the Riverdale School District need Local Option revenues?

- Measures 5 and 50 and the shift from local to State funding of school districts in the 1990s reduced the amount of money our school District receives for each student.
- Nine years ago Riverdale received \$7,467 per student, and this year we will receive approximately \$5,000 per student.

- To distribute the cost of a Riverdale education to all property owners in our community, as we all benefit from the existence of exceptional neighborhood schools.

What will the renewal of this measure do?

- Provides a predictable, stable source of dollars to support our five-year financial plan.
- Generates approximately \$460,000 per year over five years, 100% of which will be used for our kids.
- Allows our neighborhood to fund programs and services that are no longer feasible with the current State School funding formula.
- Allows our entire neighborhood to support excellence in our staffing, programs, and services, as our exceptional schools benefit the entire community.
- Allows the District to offset a portion of the loss of nearly \$500,000 from the expiration of the Multnomah County Income Tax (I-Tax) in the spring of 2006.

How will Local Option dollars be used?

- To maintain our current exceptional core academic programs and services.
- To help maintain our low student-to-staff ratio.

What would happen if this levy fails?

- Loss of approximately \$460,000 per year (\$278,000 current levy + \$182,000 levy increase).
- The inevitable loss of \$500,000 from the expiration of the I-Tax in 2006 combined with the loss of levy revenues will result in an overall loss to the district of \$778,000 (\$278,000 current levy + \$500,000 I-Tax).
- A reduction of staff, programs, and services. A \$460,000 loss is the equivalent of 6 certified teachers (i.e. programs).

How much is the continuation of the levy expected to cost?

- This measure will impact property owners within the school District boundaries.
- Property owners can find their current Local Option costs by looking at the "Riverdale SD #51 Loc Opt" line on their property tax statement. This renewal will moderately increase this amount.
- The current levy rate is \$0.655 per \$1,000 of assessed value. The renewal and increase will result in a levy rate of \$1.07 per \$1,000 of assessed value.
- The exact amount varies from property to property, based on Ballot Measure 5 limitations. For a home assessed at \$750,000 and taxed at the maximum Local Option tax rate of \$1.07 per \$1,000 of assessed value, the cost would be approximately \$802.50 a year.

Furnished by:
Dr. Thomas Hagerman
Superintendent

ARGUMENT IN FAVOR

Riverdale School District 51J is renowned for providing an exceptional, state- and federally-recognized program of academic studies at the elementary and secondary levels.

Riverdale's success is attracting many families to Dunthorpe, helping to make it one of the most desirable neighborhoods in Oregon. The schools' outstanding academic reputation has also contributed to a substantial elevation in the property value of neighborhood homes.

A tradition of community support has helped Riverdale maintain its program of academic excellence even as state support has declined. Nine years ago Riverdale received roughly \$7,500 per student; today, Riverdale receives just \$5,000 per student.

(continued over)

To maintain its high quality educational programs, Riverdale is seeking to renew the Local Option approved by Riverdale School District voters in 2000, with a small increase in the levy rate, as allowed by the State Legislature.

Your support for the Local Option levy will help to generate \$460,000 per year over the next five years – with 100 percent of community resources staying in Riverdale to maintain educational services. This support is critical given the expiration of the Multnomah County I–Tax in 2005, which provides Riverdale with \$500,000 per year. Passage of the Local Option levy will offset a portion of this loss. And since the Local Option levy is a renewal, its passage will add only a modest amount to your tax bill.

Exceptional schools are essential not only for the kids who attend them, but also for the community. Exceptional schools also lead to a stable community and increased property values.

We believe that a strong Riverdale School District benefits all of us, and we join the School Board in supporting Measure 26-75.

Please support your community: Keep Riverdale Schools Exceptional.

Please vote YES for the Riverdale School District 5 I J Local Option.

Phil/Gainor Arzt
Robert/Shirley Berselli
William/Susan Bourque
Brent/Barbara Chalmers
Paul Duden
Sylvia Breed Gates
Steve/Stephanie Jewell
Steven/Kathryn Johnson
Douglas/Selby Key
Gerry/Kim Langelier
Jean Stoll
Peter / Tracy Stoloff
Ron Vandehey
Robert/Barbara Coit Yeager
Mark Zusman

**NO ARGUMENTS AGAINST THIS
MEASURE WERE FILED.**

The printing of this argument does not constitute an endorsement by Clackamas County, nor does the county warrant the accuracy or truth of any statement made in the argument.

**CLACKAMAS COUNTY
VOTERS' PAMPHLET**

**SPECIAL ELECTION
November 8, 2005**

Ballots must be returned to
Clackamas County Elections
825 Portland Avenue
Gladstone, OR 97027
by 8:00 p.m.,
November 8, 2005

Measure text, explanatory
statement and arguments
are printed as filed.

SHERRY HALL
County Clerk



STYLE I



Clackamas County Voters' Pamphlet



Style 4

SPECIAL ELECTION

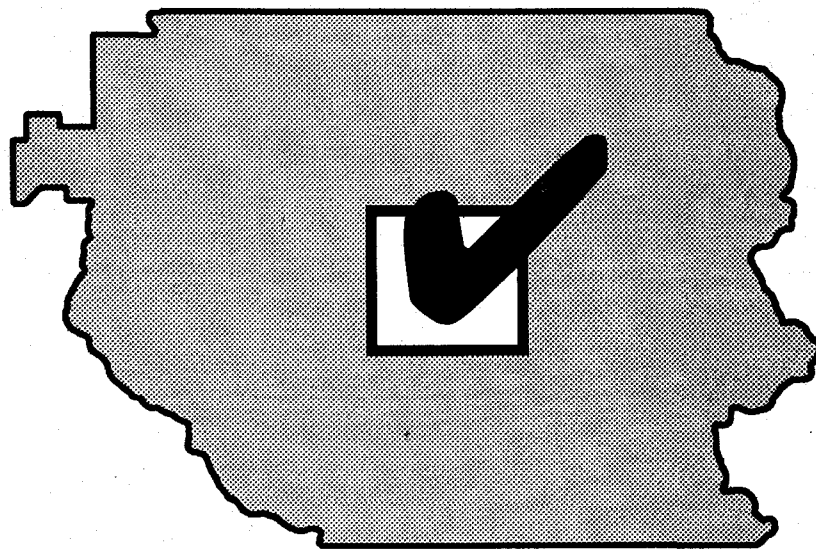

November 8, 2005

ELECTIONS DIVISION

825 Portland Avenue
Gladstone, OR 97027

SHERRY HALL,
County Clerk

**Measure Text,
Explanatory Statements
and Arguments
are printed as filed.**

Visit us on the Internet:
www.co.clackamas.or.us/elections



Please recycle this pamphlet with your newspapers

VOTING IS AS EASY AS 1 - 2 - 3

[Instructions for Completing Your Ballot]

1

Examine your Official Ballot

Locate the candidate or measure response (YES or NO) of your choice for each contest. To vote, you must completely darken the oval to the left of the response of your choice with black / blue ink or pencil.

To vote for a write-in candidate, one whose name does not appear on the Official Ballot, completely darken the oval (●) to the left of the dotted line (-----) provided for the office and write the full name of the candidate on the dotted line.

Remember: If you vote for more than the number of candidates allowed for an office, or you vote both YES and NO on a measure, it is called an overvote, and your vote for that candidate or measure will not be counted.

2

Review your Official Ballot

Ensure you have correctly marked your choice for each contest. Your official ballot may contain contests printed on both front and back. **Remember to vote both sides, if applicable.**

If you make an error on your ballot, spoil it in any way or lose it, contact the Clackamas County Elections Division at 503.655.8510 / TTY 503.655.1685 to request a replacement.

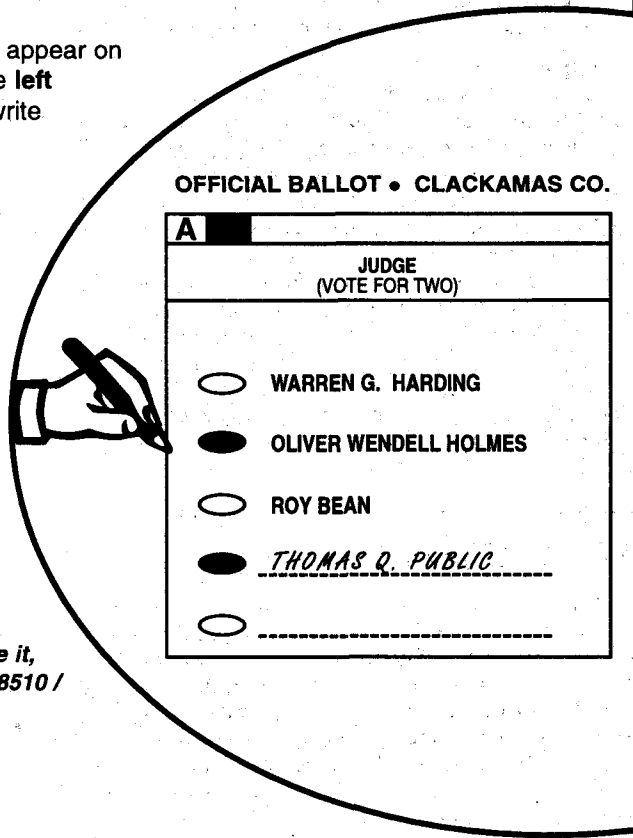

3

Return your Official Ballot

Place your voted Official Ballot in the ballot secrecy envelope and seal the envelope. Place the sealed secrecy envelope in the return identification envelope (white with colored edge) and seal it.

Remember: Read and sign the Voter's Statement on the return identification envelope. Your ballot will not be counted if the return identification envelope is not signed.

By mail:

- Attach sufficient first-class postage to the **signed** and sealed return identification envelope. Mail it as soon as possible to arrive at the Clackamas County Elections Division no later than 8:00 p.m. on Tuesday, November 8, 2005.
The postmark does not count!

In person:

- Deliver the **signed** and sealed return identification envelope to any official drop site location (listed on page 7 of this voters' pamphlet) no later than 8:00 p.m. on Tuesday, November 8, 2005. **Postage is NOT required if delivered to a drop site location!**

**Questions? Need assistance in voting due to a permanent or temporary disability?
Please call the Elections Division at 503.655.8510 / TTY 503.655.1685.**

CITY OF CANBY

Measure No. 3-194**BALLOT TITLE**

MEASURE APPROVING ANNEXATION OF 9.74 ACRES INTO CITY OF CANBY

QUESTION: Shall 9.74 acres located south of SE 13th Avenue and west of Tofte Farms Subdivision be annexed into Canby?

SUMMARY: Annexation is the legal process to bring property into the City limits. Willow Creek Estates, Inc., has filed an application on behalf of the owner, A. Wayne Scott, asking the City to bring 9.74 acres of property into the City limits. The legal description of the property is Tax Lot 4700 of Tax Map 4-1E-4DA. The parcel is located east of S. Ivy Street, on the south side of SE 13th Avenue across from Ackerman Middle School and west of Tofte Farms Subdivision. This application has previously been approved by the City Council following a public hearing on August 17, 2005. The property is vacant farmland and contains no buildings. It is currently zoned Exclusive Farm Use (EFU) by Clackamas County. The City's Comprehensive Plan calls for Low Density Residential (R-1) zoning designation for the property upon annexation. Any future development requires City review and must comply with land use laws.

application, and the Canby City Council voted unanimously voted to approve the application and refer it to a vote of the Canby electorate.

Furnished by
Kimberly Scheafer
Canby City Recorder - Pro tem

EXPLANATORY STATEMENT

This measure would approve the annexation of 9.74 acres into the city limits of the City of Canby. The property which would be included within the City boundaries is known as Tax Lot 4700 of Tax Map 4-1E-4DA and is located generally in the south, central part of the City. Tax Lot 4700 is currently zoned EFU (Exclusive Farm Use) under County zoning. If annexation into the City is approved by the voters, the parcel would be rezoned to R-1, Low Density Residential, as required under the City's Comprehensive Land Use Plan (Comp Plan).

Tax Lot 4700 is owned by A. Wayne Scott. Willow Creek Estates, Inc., has filed the application for annexation on behalf of the owner. The City, following its Charter, has put this matter before the voters for approval.

The property is located east of S. Ivy Street, on the south side of SE 13th Avenue, across the street from Ackerman Middle School and west of Tofte Farms Subdivision. The 9.74 acres is presently vacant with no existing buildings on the site. Adjacent properties to the north and east are already within city limits, zoned for Low Density Residential. Properties to the west and south are outside of City limits, but within the City's urban growth boundary. Under the R-1 zoning regulations, the applicant could develop a 39-lot subdivision for the construction of single family homes. However, annexation alone does not set the future uses to be built on the property. Any further development would have to comply with state and local land use laws and would be subject to public review.

The Canby Comp Plan also designates properties for annexation as Priority "A", "B" or "C". Priority "A" properties shall generally be annexed prior to those areas shown as Priority "B" which, in turn, shall generally be annexed prior to those areas shown as Priority "C". The property is priority "A". The Canby Planning Commission voted unanimously to approve the

CITY OF CANBY

Measure No. 3-194

ARGUMENT IN FAVOR

This annexation makes sense for the City of Canby. The City of Canby's comprehensive plan designates this site as priority "A" land, the first lands to be annexed into the city. The site is surrounded by established residential homes and public buildings. Its proximity to these non-agricultural developments makes long term agricultural use impractical.

The City of Canby currently has approximately a one (1) year supply of platted, low density residential land available. This is significantly less than the three (3) year supply considered sufficient, therefore establishing an overall need for the annexation of this land.

The approval of this annexation will have a positive economic impact on the community as a whole. Countless jobs and opportunities for the citizens of Canby will be provided through the development of this site. When finished, the development will add approximately \$15 million to our local tax base. By increasing our local tax base, more funding becomes available to our city, schools, police department, fire department, parks and library.

Our local programs and services are continuously faced with increasing expenses and rely on the additional revenue provided by growth and development. Flat or declining revenue means fewer dollars and reductions in those same programs and services that our citizens have come to expect.

As citizens of Canby, we have the responsibility to make educated decisions regarding our city's long term economic future. By allowing growth at a manageable rate, the entrance of new residents will ensure the prosperity of local businesses, public services, and civic activities; preserving the essence of the community that we value so highly in Canby.

VOTE YES! Preserve Canby's future.

Furnished by
Thomas Scott
S.T.J., LLC

**NO ARGUMENTS IN OPPOSITION TO
THIS MEASURE WERE FILED.**

The printing of this argument does not constitute an endorsement by Clackamas County, nor does the county warrant the accuracy or truth of any statements made in the argument.

Registering to Vote

(SOME FREQUENTLY-ASKED QUESTIONS)

WHO MAY REGISTER TO VOTE?

Anyone who is: (1) a resident of Oregon; (2) a United States citizen; and (3) 18 years of age or older.

HOW MAY I REGISTER?

By mail-in registration form, in person at any county elections office, or at a designated state agency, including the Department of Motor Vehicles and some public assistance agencies.

WHEN MAY I REGISTER & WHAT IS THE REGISTRATION DEADLINE?

You may register at any time. However, your voter registration form must be received or postmarked no later than the 21st day before the election at which you intend to vote.

WHERE CAN I FIND VOTER REGISTRATION FORMS?

Post offices, public libraries, city halls, schools, the DMV, and Clackamas County Elections, 825 Portland Avenue in Gladstone. There is a copy of the form in the Qwest Telephone Directory, Blue Government Pages. You can download and print out a form in PDF format from the Secretary of State's web site at the Oregon Voter Registration link. Find it at www.sos.state.or.us/elections/elecchp.htm.

WHAT INFORMATION IS REQUIRED WHEN REGISTERING?

In October 2002, the "Help America Vote Act" was signed into law. The Act changes voter registration requirements nationwide for voting in federal elections. A person registering to vote is asked to provide identification **only** if they are a new registrant in the county in which they are registering, and they are mailing the registration card via the U.S. Postal Service. Identification is **not** required for updates within the same county, or for any new registrations delivered in person or by means other than mail via the U.S. Postal Service.

Sufficient identification is: a copy of a current, valid photo identification (such as driver's license), or a copy of a paycheck stub, utility bill, bank statement or other government document showing the registrant's name and address.

WHAT IF I TURN 18 AFTER THE REGISTRATION DEADLINE?

If you will turn 18 years of age during the 20-day period immediately before an election, you must register by the 21st day prior to the election.

HOW DO I KNOW IF I AM PROPERLY REGISTERED?

Call the Elections Division at 503.655.8510 / TTY 503.655.1685.

MEASURE 3-194 City of Canby

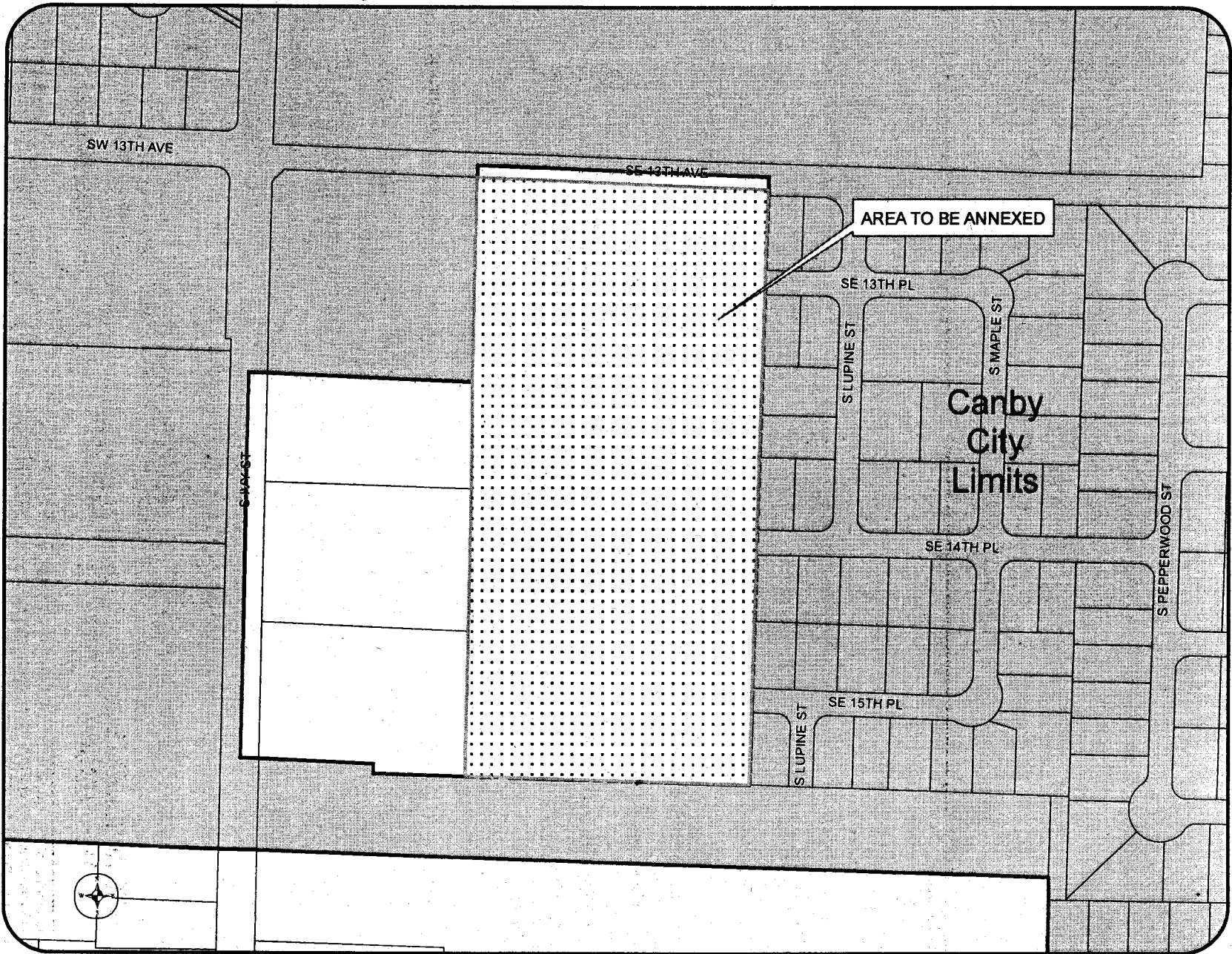

CITY OF CANBY

Measure No. 3-194

CONTINUED

CITY OF CANBY

Measure No. 3-195

BALLOT TITLE

MEASURE APPROVING ANNEXATION OF 1.7 ACRES INTO CITY OF CANBY

QUESTION: Shall 1.7 acres located at 1203 NE Territorial Road, east of N. Pine Street, be annexed into Canby?

SUMMARY: Annexation is the legal process to bring property into the City limits. S.T.J., LLC, has filed an application asking the City to bring 1.7 acres of property into the City limits. The legal description of the property is Tax Lot 1300 of Tax Map 3-1E-27CB. The parcel is located at 1203 NE Territorial Road, east of N. Pine Street and west of the Logging Road Trail. This application has previously been approved by the City Council following a public hearing on August 17, 2005. The property contains one single-family residence. It is currently zoned Rural Residential Farm and Forest (RRFF 5) by Clackamas County. The City's Comprehensive Plan calls for High Density Residential (R-2) zoning designation for the property upon annexation. Any future development requires City review and must comply with land use laws.

The Canby Planning Commission unanimously voted to approve the application and the Canby City Council unanimously voted to approve the application and refer it to a vote of the Canby electorate.

Furnished by
Kimberly Scheafer
Canby City Recorder - Pro tem

EXPLANATORY STATEMENT

This measure would approve the annexation of 1.7 acres into the city limits of the City of Canby. The property which would be included within the City boundaries is known as Tax Lot 1300 of Tax Map 3-1E-27CB and is located generally in the northeast part of the City. Tax Lot 1300 is currently zoned Rural Residential Farm and Forest (RRFF-5) under County zoning. If annexation into the City is approved by the voters, the parcel would be rezoned to R-2, High Density Residential, as required under the City's Comprehensive Land Use Plan (Comp Plan).

Tax Lot 1300 is owned by S.T.J., LLC. S.T.J., LLC has filed the application for annexation into the City of Canby. The City, following its Charter, has put this matter before the voters for approval.

The address of the property is 1203 NE Territorial Road. The parcel is located on the south side of NE Territorial Road, east of N. Pine Street and west of the Logging Road Trail. The 1.7 acres contains one single family residence. Adjacent properties on all sides are within city limits, zoned for High Density Residential. Under the R-2 zoning regulations, the applicant proposes to develop an 23-unit townhouse development. However, annexation alone does not set the future uses to be built on the property. Any further development would have to comply with state and local land use laws and would be subject to public review.

The Canby Comp Plan also designates properties for annexation as Priority "A", "B" or "C". Priority "A" properties shall generally be annexed prior to those areas shown as Priority "B" which, in turn, shall generally be annexed prior to those areas shown as Priority "C". The property is priority "A".

CITY OF CANBY

Measure No. 3-195**ARGUMENT IN FAVOR**

This annexation makes sense for the City of Canby. The City of Canby's comprehensive plan designates this site as priority "A" land, the first lands to be annexed into the city. The site is a small tract of non-productive farm land, surrounded by other developed property. The size and location of the site make productive farm use impractical.

The approval of this annexation will have a positive economic impact on the community as a whole. Countless jobs and opportunities for the citizens of Canby will be provided through the development of this site. More affordable housing will become available to our local residents. When finished, the development will add approximately \$5 million to our local tax base. By increasing our local tax base, more funding becomes available to our city, schools, police department, fire department, and library.

Our local programs and services are continuously faced with increasing expenses and rely on the additional revenue provided by growth and development. Flat or declining revenue means fewer dollars and reductions in those same programs and services that our citizens have come to expect.

As citizens of Canby, we have the responsibility to make educated decisions regarding our city's long term economic future. By allowing growth at a manageable rate, the entrance of new residents will ensure the prosperity of local businesses, public services, and civic activities; preserving the essence of the community that we value so highly in Canby.

VOTE YES! Preserve Canby's future.

Furnished by
Thomas Scott
S.T.J., LLC

**NO ARGUMENTS IN OPPOSITION TO
THIS MEASURE WERE FILED.**

The printing of this argument does not constitute an endorsement by Clackamas County, nor does the county warrant the accuracy or truth of any statements made in the argument.

Drop Site Locations

Ballots may be deposited at any of the following locations during regular business hours beginning Saturday, October 22, and continuing until 8:00 p.m. on Tuesday, November 8 (Election Day).

Ballots will not be accepted after 8 p.m. on Election Day.

Postage is not required on ballots returned to drop site locations.

Canby Library

292 N. Holly, Canby
Phone: 503.266.3394

Mon 3:00 pm -- 8:00 pm
Tue -- Thur 12:00 pm -- 8:00 pm
Fri, Sat 10:00 am -- 6:00 pm
Sun 12:30 pm -- 5:00 pm

Estacada Library

475 SE Main St., Estacada
Phone: 503.630.8273

Mon -- Thur. . . . 10:00 am -- 7:00 pm
Fri, Sat 10:00 am -- 5:00 pm
Sun CLOSED
Tue 11/8 10:00 am -- 8:00 pm

Lake Oswego Library

706 S.W. 4th St., Lake Oswego
Phone: 503.636.7628

Mon -- Thur. . . . 10:00 am -- 9:00 pm
Fri, Sat 10:00 am -- 6:00 pm
Sun 1:00 pm -- 6:00 pm
Tue 11/8 10:00 am -- 8:00 pm

Clackamas County Elections

825 Portland Ave., Gladstone
Phone: 503.655.8510

Mon -- Fri 8:30 am -- 5:00 pm
Election Day 7:00 am -- 8:00 pm

Ballot drop slot (front of building, to the right of the front door) is available 24 hours every day.

MEASURE 3-195 City of Canby

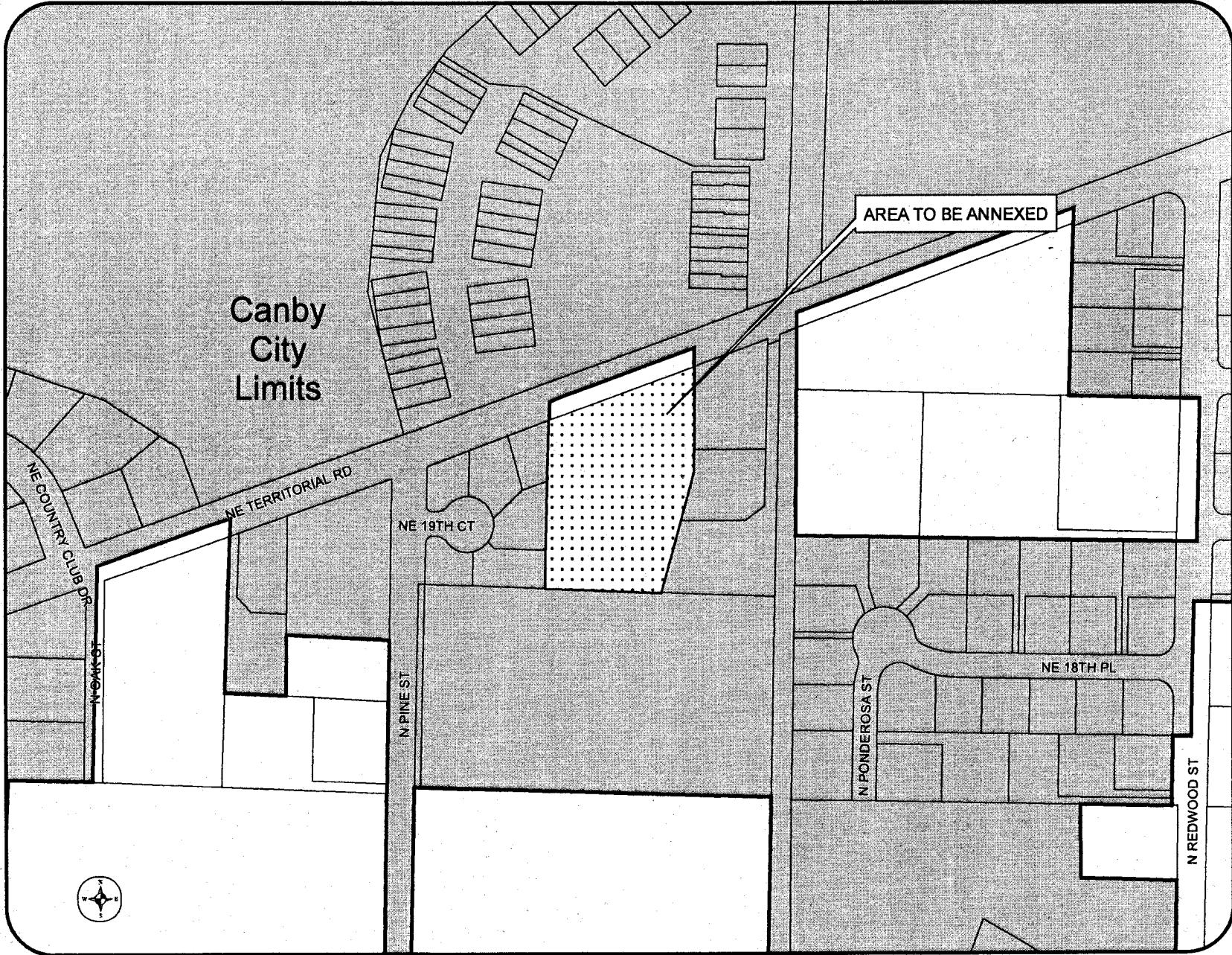

Measure No. 3-195

CITY OF CANBY

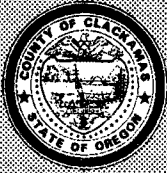

Clackamas County Voters' Pamphlet



Style 2

SPECIAL ELECTION

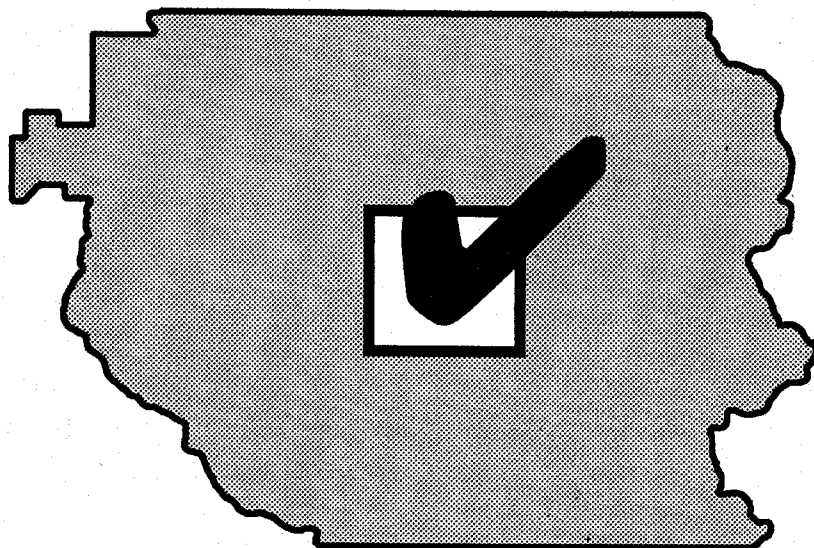

November 8, 2005

ELECTIONS DIVISION

825 Portland Avenue
Gladstone, OR 97027

SHERRY HALL,
County Clerk

Measure Text and
Explanatory Statements
are printed as filed.

Visit us on the Internet:
www.co.clackamas.or.us/elections



Please recycle this pamphlet with your newspapers

VOTING IS AS EASY AS 1 - 2 - 3

[Instructions for Completing Your Ballot]

1

Examine your Official Ballot

Locate the candidate or measure response (YES or NO) of your choice for each contest. To vote, you must completely darken the oval to the left of the response of your choice with black / blue ink or pencil.

To vote for a write-in candidate, one whose name does **not** appear on the Official Ballot, completely darken the oval (●) to the **left** of the dotted line (-----) provided for the office and write the full name of the candidate on the dotted line.

Remember: If you vote for more than the number of candidates allowed for an office, or you vote both YES and NO on a measure, it is called an overvote, and your vote for that candidate or measure will not be counted.

2

Review your Official Ballot

Ensure you have correctly marked your choice for each contest. Your official ballot may contain contests printed on both front and back. **Remember to vote both sides, if applicable.**

If you make an error on your ballot, spoil it in any way or lose it, contact the Clackamas County Elections Division at 503.655.8510 / TTY 503.655.1685 to request a replacement.

3

Return your Official Ballot

Place your voted Official Ballot in the ballot secrecy envelope and seal the envelope. Place the sealed secrecy envelope in the return identification envelope (white with colored edge) and seal it.

Remember: Read and sign the Voter's Statement on the return identification envelope. Your ballot will not be counted if the return identification envelope is not signed.

By mail:

- Attach sufficient first-class postage to the **signed** and sealed return identification envelope. Mail it as soon as possible to arrive at the Clackamas County Elections Division no later than 8:00 p.m. on Tuesday, November 8, 2005.
The postmark does not count!

In person:

- Deliver the **signed** and sealed return identification envelope to any official drop site location (listed on page 8 of this voters' pamphlet) no later than 8:00 p.m. on Tuesday, November 8, 2005. **Postage is NOT required if delivered to a drop site location!**

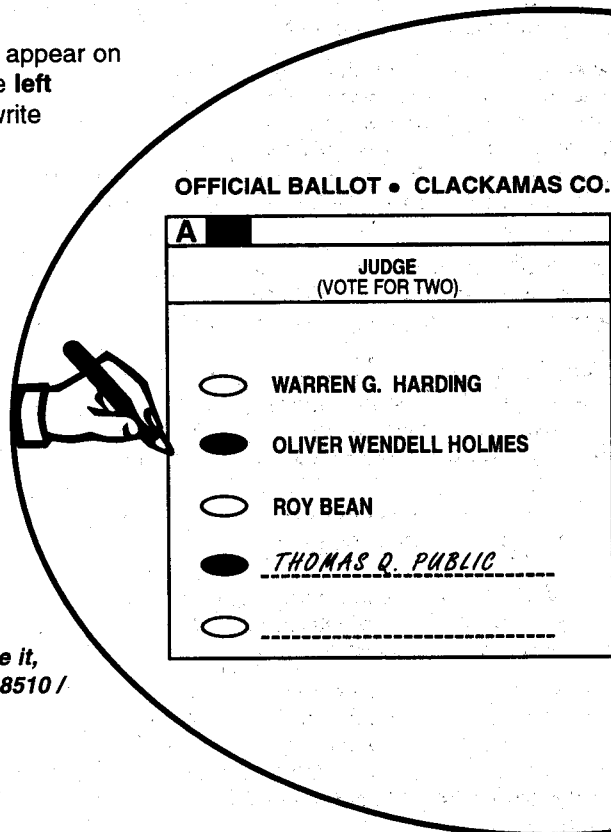

**Questions? Need assistance in voting due to a permanent or temporary disability?
Please call the Elections Division at 503.655.8510 / TTY 503.655.1685.**

CITY OF ESTACADA

Measure No. 3-192**BALLOT TITLE****ANNEXATION OF 154.42 ACRES INTO THE ESTACADA CITY LIMITS**

QUESTION: Shall 154.42 acres off of Cemetery Road be annexed into the City of Estacada?

SUMMARY: Approval of this measure would bring into the Estacada city limits 154.42 acres (5 tax lots), located on the east side of Cemetery Road, south of Duus Road, and north of the Hill Way intersection. The western boundary of the area has frontage on Cemetery Road. The eastern boundary of the area borders the Valley View Airport. This annexation was requested by landowner petition.

Property to be annexed must touch existing city limits, and there must be adequate city services such as schools, water, and roads to serve the property. The Estacada City Council has determined that these requirements are met, and submits the question of annexation of the territory to the voters as required by the Estacada City Charter. If annexed, the described property will become subject to the City's permanent property tax rate limit and will be eligible to receive services from the City.

EXPLANATORY STATEMENT

This ballot measure is one of two proposed annexation measures being submitted by the City of Estacada for this election. A separate vote is required on each ballot measure.

Annexation is the procedure used to add land to the corporate boundaries of a city. Approval of an annexation measure will bring that property within the City limits. Once the land is annexed, the annexed territory is subject to the City's permanent property tax rate, and becomes eligible to receive city services.

As required by the Estacada City Charter, the City of Estacada submits to voters a ballot measure proposing annexation of the following territory into the City.

154.42 acres (5 tax lots) located on the east side of Cemetery Road, south of Duus Road, and north of the Hill Way intersection. The western boundary of the area has frontage on Cemetery Road. The eastern boundary of the area borders the Valley View Airport.

This annexation was requested by landowner petition. The Estacada City Council has determined that the petition meets the City Code requirements for annexation. All properties are within the City's urban growth boundary and are contiguous to property already within the City limits. Clackamas County currently zones four tax lots on the property RRFF-5, and the fifth is zoned EFU. If annexed into the City, the property will be zoned Low Density Residential, in accordance with the City Comprehensive Plan.

Furnished by
Eileen Eakins
City of Estacada

**NO ARGUMENTS IN FAVOR OF OR IN
OPPOSITION TO THIS MEASURE WERE FILED.**

CITY OF ESTACADA

Measure No. 3-192

MEASURE 3-192 City of Estacada

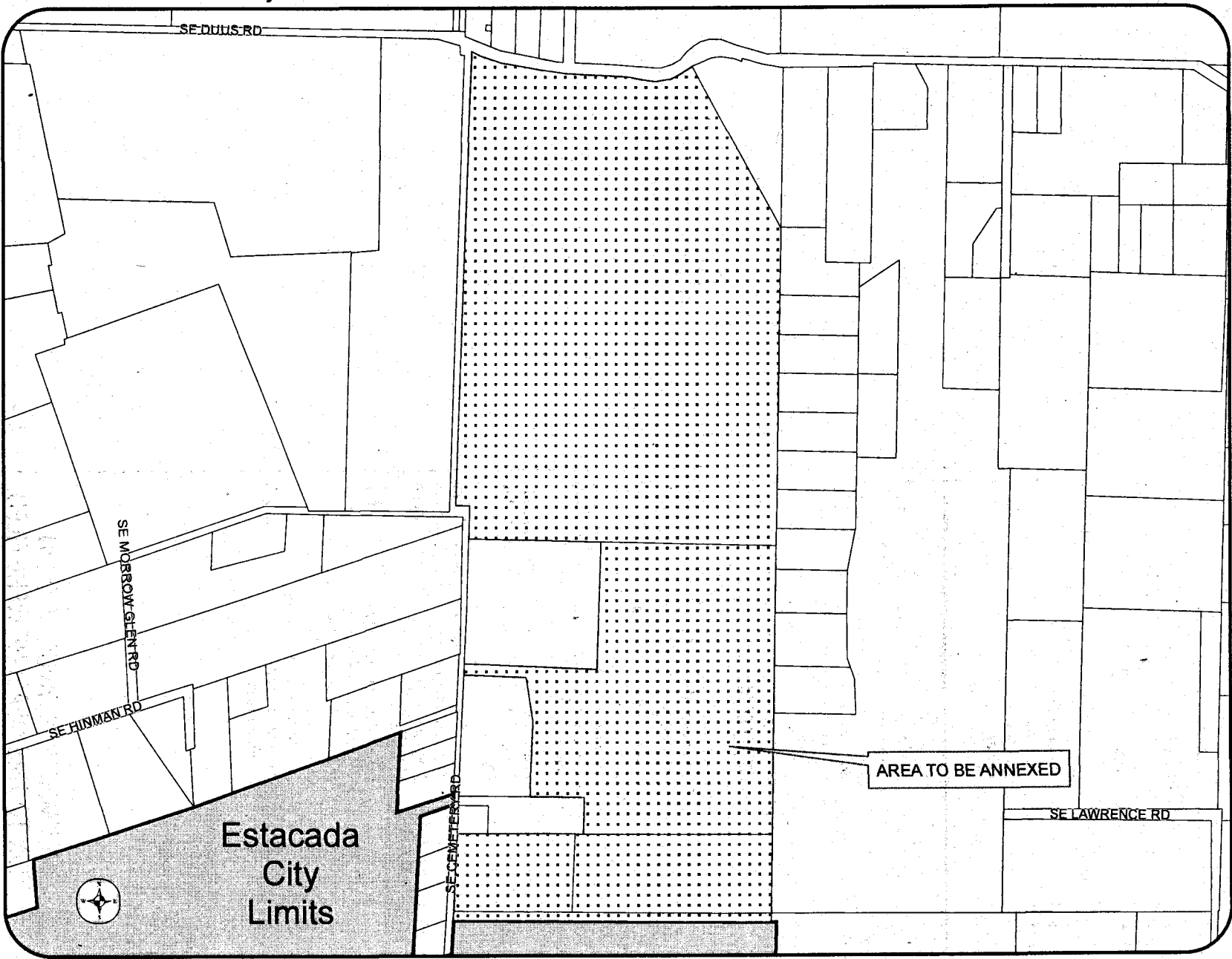

CITY OF ESTACADA

Measure No. 3-193**BALLOT TITLE**

ANNEXATION OF 38.90 ACRES INTO THE ESTACADA CITY LIMITS

QUESTION: Shall 38.90 acres off of Eagle Creek Road be annexed into the City of Estacada?

SUMMARY: Approval of this measure would bring into the Estacada city limits 38.90 acres of territory, located on the east and west side of Eagle Creek Road, north of River Mill Road and Hinman Avenue. The western boundary of the area has frontage on State Hwy. 224. The eastern boundary has frontage on Wren Road. This annexation was requested by landowner petition.

If annexed, the described property will become subject to the City's permanent property tax rate and will be eligible to receive services from the City. Property to be annexed must touch existing city limits, and there must be adequate city services such as schools, water, and roads to serve the property. The Estacada City Council has determined that these requirements are met, and submits the question of annexation of the territory to the voters as required by the Estacada City Charter.

EXPLANATORY STATEMENT

This ballot measure is one of two proposed annexation measures being submitted by the City of Estacada for this election. A separate vote is required on each ballot measure.

Annexation is the procedure used to add land to the corporate boundaries of a city. Approval of an annexation measure will bring that property within the City limits. Once the land is annexed, the annexed territory is subject to the City's permanent property tax rate, and becomes eligible to receive city services.

As required by the Estacada City Charter, the City of Estacada submits to voters a ballot measure proposing annexation of the following territory into the City:

38.90 acres (12 tax lots) located on the east and west side of Eagle Creek Road, north of River Mill Road and Hinman Avenue. The western boundary of the area has frontage on State Hwy. 224. The eastern boundary has frontage on Wren Road.

This annexation was requested by landowner petition. The Estacada City Council has determined that the petition meets the City Code requirements for annexation. The territory is within the City's urban growth boundary and is contiguous to property already within the City limits. Clackamas County currently zones this territory RRF-5. If annexed into the City, the property will be zoned Light Industrial, in accordance with the City Comprehensive Plan.

Furnished by
Eileen Eakins
City of Estacada

**NO ARGUMENTS IN FAVOR OF OR IN
OPPOSITION TO THIS MEASURE WERE FILED.**

Measure No. 3-193

MEASURE 3-193 City of Estacada

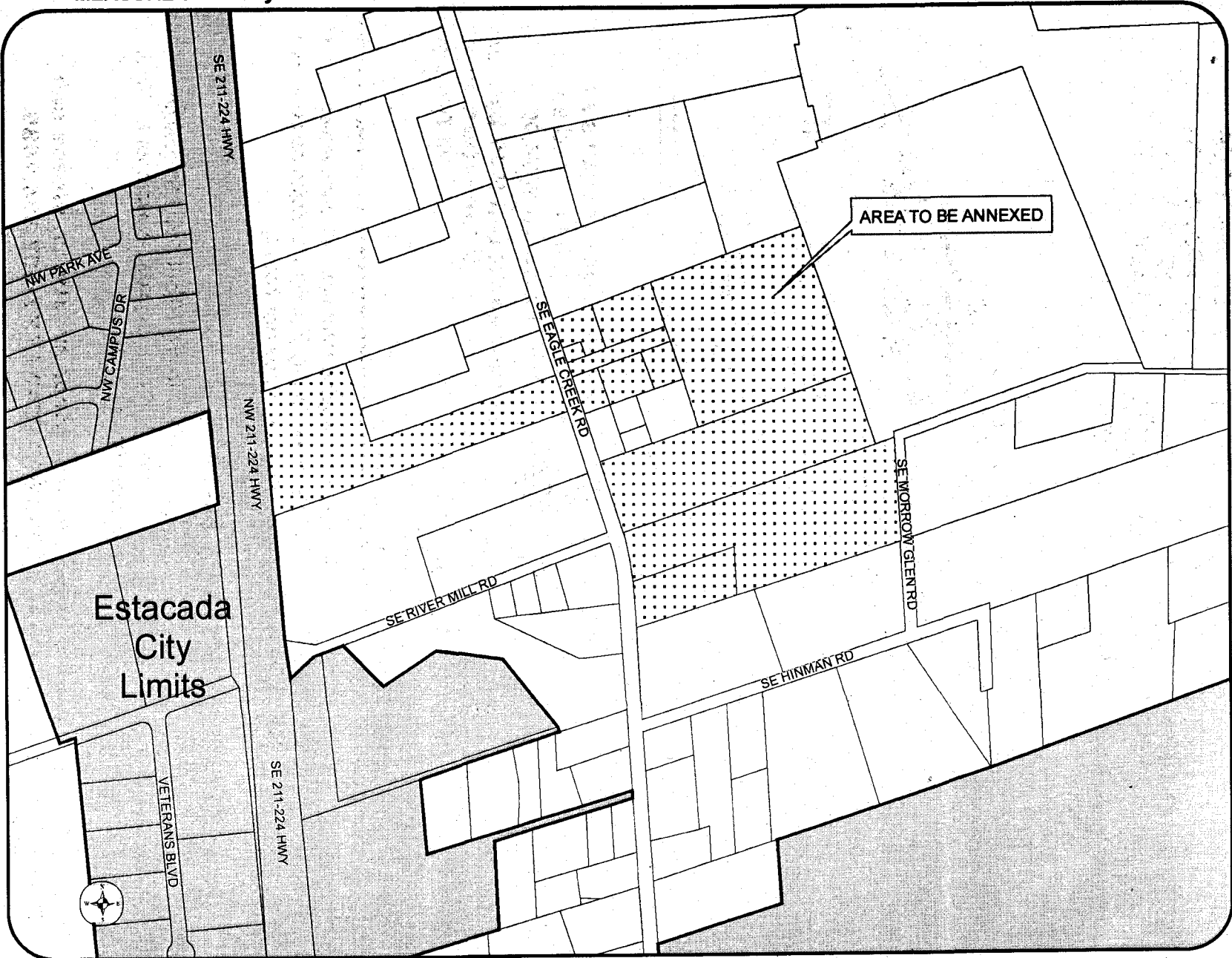

To Ensure Your Ballot Will Be Counted:

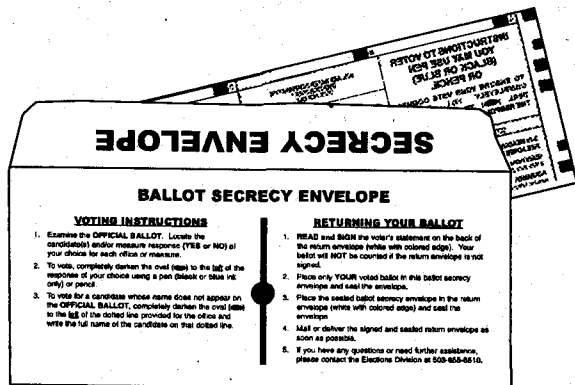

Place only **YOUR** voted ballot in the secrecy envelope and seal it.

1

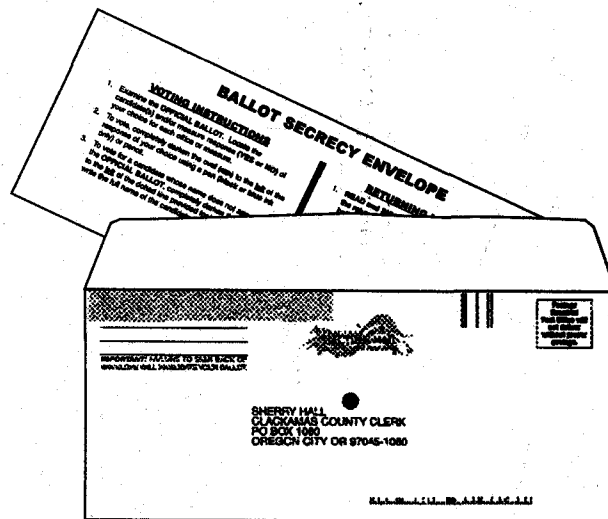

Place the sealed secrecy envelope in the white (with colored edge) return identification envelope and seal the return envelope.

2

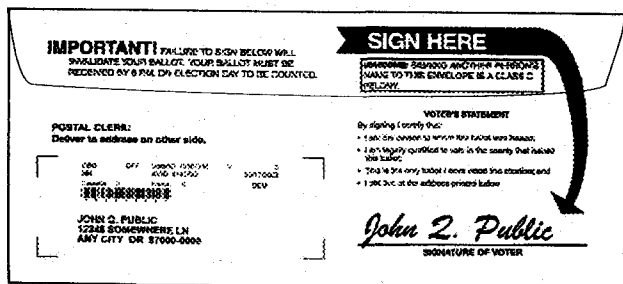

Read and sign the voter's statement on the white (with colored edge) return identification envelope.

3

Your ballot will NOT be counted if the return envelope is not signed.

Attach sufficient first-class postage to the signed and sealed return identification envelope and mail it as soon as possible to arrive at the Clackamas County Elections Division no later than 8:00 p.m., Tuesday, November 8, 2005. **The postmark does not count!**

OR

Deliver the signed and sealed return identification envelope to any official drop site location (listed on page 8 of this voters' pamphlet) no later than 8:00 p.m., Tuesday, November 8, 2005. **Postage is NOT required if delivered to a dropsite location.**

If you need assistance or have any other questions, please call the Elections Division at 503.655.8510 / TTY 503.655.1685.

Registering to Vote

(SOME FREQUENTLY-ASKED QUESTIONS)

WHO MAY REGISTER TO VOTE?

Anyone who is:

- ★ A resident of Oregon;
- ★ A United States citizen; and
- ★ 18 years of age or older.

HOW MAY I REGISTER?

By mail-in registration form or in person at any county elections office or at a designated state agency, including the Department of Motor Vehicles and some public assistance agencies.

WHEN MAY I REGISTER & WHAT IS THE REGISTRATION DEADLINE?

You may register at any time. However, your voter registration form must be received or postmarked no later than the 21st day before the election at which you intend to vote.

WHERE CAN I FIND VOTER REGISTRATION FORMS?

Post offices, public libraries, city halls, schools, the DMV, and Clackamas County Elections, 825 Portland Avenue in Gladstone. There is a copy of the form in the Qwest Telephone Directory, Blue Government Pages. You can download and print a form in PDF format from the Secretary of State's web site at the Oregon Voter Registration link <http://www.sos.state.or.us/elections/elechp.htm>.

WHAT INFORMATION IS REQUIRED WHEN REGISTERING?

In October 2002, the "Help America Vote Act" was signed into law. The Act changes voter registration requirements nationwide for voting in federal elections. A person registering to vote is asked to provide identification **only** if they are a new registrant in the county in which they are registering, and they are mailing the registration card via the U.S. Postal Service. Identification is **not** required for updates within the same county, or for any new registrations delivered in person or by means other than mail via the U.S. Postal Service.

Sufficient identification is: a copy of a current, valid photo identification (such as driver's license), or a copy of a paycheck stub, utility bill, bank statement or other government document showing the registrant's name and address.

If identification is not provided at the time of registration, it will be requested by elections officials in order for the person to vote at the next federal election. When filling out the registration card, you must furnish your full name, residence address (and mailing address, if different), date of birth, political party preference, and signature. Your residence address must be the physical address where you reside - not a post office box.

DO I HAVE TO RE-REGISTER FOR EACH ELECTION?

No. You only need to update your registration when your residence (even moving to a different apartment within a complex) or mailing address changes; your name changes; or you wish to change your political party affiliation.

WHAT IF I TURN 18 AFTER THE REGISTRATION DEADLINE?

If you will turn 18 years of age during the 20-day period immediately before an election, you must register by the 21st day prior to the election.

DO I HAVE TO REGISTER BY PARTY?

No. If you do not wish to be affiliated with a political party, you may check the box that states "not a member of a party." You may not designate or change a party affiliation after the 21st day before a primary election.

HOW DO I KNOW IF I AM PROPERLY REGISTERED?

Call the Elections Division at 503.655.8510 / TTY 503.655.1685.

Drop Site Locations

Ballots may be deposited at any of the following locations during regular business hours beginning Saturday, October 22, and continuing until 8:00 p.m. on Tuesday, November 8 (Election Day).

Ballots will not be accepted after 8 p.m. on Election Day.

Postage is not required on ballots returned to drop site locations.

Canby Library

292 N. Holly, Canby
Phone: 503.266.3394

Mon 3:00 pm -- 8:00 pm
Tue -- Thur 12:00 pm -- 8:00 pm
Fri, Sat 10:00 am -- 6:00 pm
Sun 12:30 pm -- 5:00 pm

Estacada Library

475 SE Main St., Estacada
Phone: 503.630.8273

Mon -- Thur. . . . 10:00 am -- 7:00 pm
Fri, Sat 10:00 am -- 5:00 pm
Sun CLOSED
Tue 11/8 10:00 am -- 8:00 pm

Lake Oswego Library

706 S.W. 4th St., Lake Oswego
Phone: 503.636.7628

Mon -- Thur. . . . 10:00 am -- 9:00 pm
Fri, Sat 10:00 am -- 6:00 pm
Sun 1:00 pm -- 6:00 pm
Tue 11/8 10:00 am -- 8:00 pm

Clackamas County Elections

825 Portland Ave., Gladstone
Phone: 503.655.8510

Mon -- Fri 8:30 am -- 5:00 pm
Election Day 7:00 am -- 8:00 pm

Ballot drop slot (front of building, to the right of the front door) is available 24 hours every day.