

POURED IN PLACE MANHOLE-BASE

NOTE:

CONCRETE TO EXTEND 12" OUTSIDE OF MH WALL AND 6" ABOVE THE BOTTOM OF THE BASE SECTION

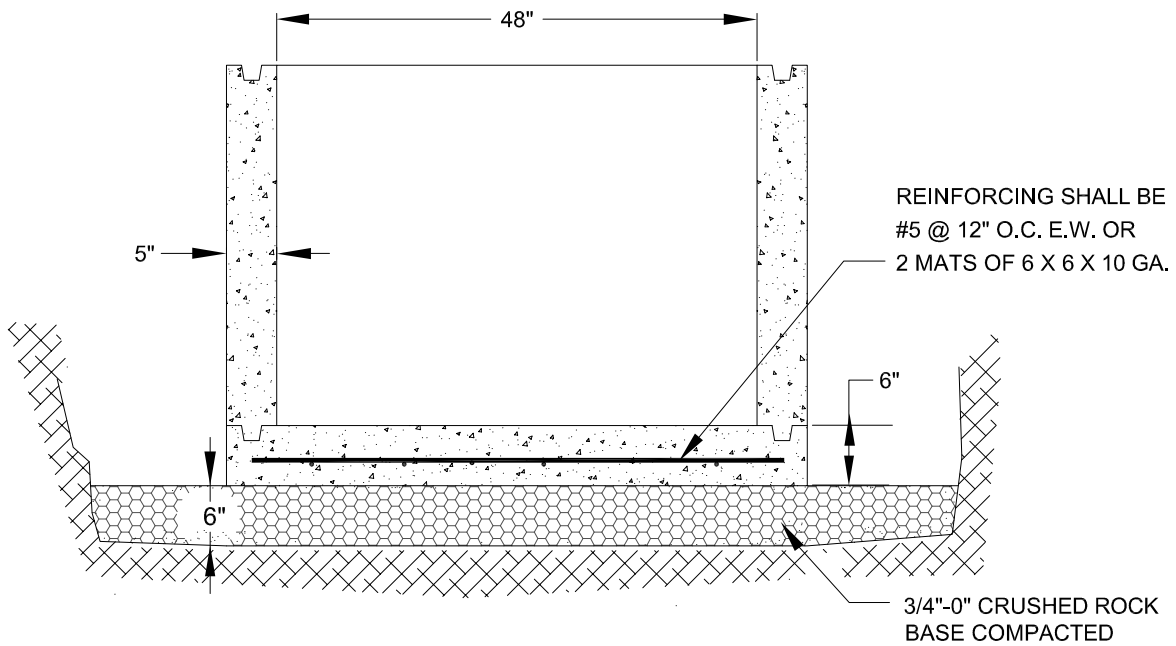

PRECAST MANHOLE-BASE

REINFORCING SHALL BE #5 @ 12" O.C. E.W. OR 2 MATS OF 6 X 6 X 10 GA.

3/4"-0" CRUSHED ROCK BASE COMPACTED