

JOIN OUR
WAITLIST!

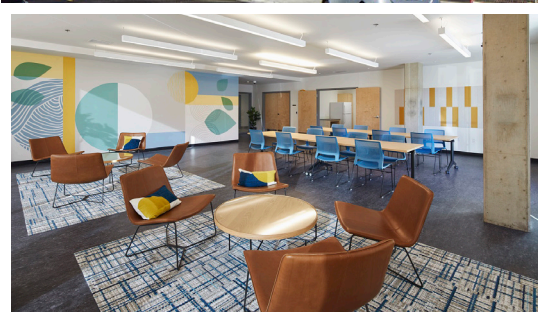

Fuller Station is your new affordable housing option in Clackamas County, OR. Bringing 100 apartment homes to the area, Fuller Station is directly adjacent to the MAX Green Line and close to it all. The six-story building is dedicated to serving low-income families and individuals with a mix of one-, two-, and three-bedroom floorplans. Residents will enjoy community rooms, open-air nature playgrounds, community gardens, on-site parking, secure bike storage, excellent public transit, and space available to local community groups for on-site services.

APARTMENT FEATURES

- Large Windows
- Large Closets
- Air Conditioner
- Plank Flooring
- Dishwasher
- Disposal
- Refrigerator
- Electric Stove/Oven

COMMUNITY FEATURES

- Community Rooms, Classroom, Computer Lab
- Nature Playground
- Community Gardens
- Laundry Facilities
- On-site Parking, EV Charging Stations
- Secure Bike Storage with Washing Station
- Package Lockers
- Adjacent to the MAX Green Line, I-205, and 82nd Avenue

60% AMI household income limits listed by household size:

1	2	3	4	5	6	7
\$44,760	\$51,120	\$57,540	\$63,900	\$69,060	\$74,160	\$79,260



9730 SE Fuller Road | Happy Valley, OR 97086
971.383.2737 | fullerstation.com

Professionally Managed By
GUARDIAN