



Procurement Division
Public Services Building
2051 Kaen Road
Oregon City, OR 97045
(503) 742-5444 (Office)

REQUEST FOR QUOTES (RFQ) #2018-43

Issue Date: April 25, 2018

Project Name:	Tualatin River Bridge Approach Repair Project		
Quote Due Date/Time:	May 15, 2:00 PM		
Procurement Analyst:	Ryan Rice	Phone:	503-742-5446
		Email:	rrice@clackamas.us

**SUBMIT QUOTES VIA EMAIL TO PROCUREMENT@CLACKAMAS.US
OR MAIL/HAND DELIVERY TO THE ABOVE ADDRESS**

**PLEASE NOTE: EMAIL SUBMISSIONS SHOULD HAVE
“RFQ #2018-43 TUALATIN RIVER BRIDGE APPROACH REPAIR”
IN THE SUBJECT LINE**

1. ANNOUNCEMENT AND SPECIAL INFORMATION

Quoters are required to read, understand, and comply with all information contained within this Request for Quotes (“RFQ”). All quotes are binding upon Quoter for sixty (60) days from the Quote Due Date/Time. Quotes received after the Quote Due Date/Time may not be considered. If authorized in the RFQ and resulting contract, travel and other expense reimbursement will only be reimbursed in accordance with the Clackamas County Travel Reimbursement Policy in effect at the time the expense is incurred. The Policy may be found at www.clackamas.us/bids/terms.html.

It will be the responsibility of potential Quoters to refer daily to the Bids and Contract Information Page (www.clackamas.us/bids/index.html) to check for any available addenda, response to clarifying questions, cancellations or other information pertaining to this RFQ.

All questions regarding this RFQ are to be directed to the Procurement Analyst named above. Quoters may not communicate with County employees or representatives about the RFQ during the procurement process until the Procurement office has notified Quoters of the selected Quoter. Communication in violation of this restriction may result in rejection of a Quoter.

2. SCOPE

The purpose of this RFQ is for the construction of the Tualatin River (SW Petes Mountain Road) Bridge Approach Repair. Scope will include all work to repair the bridge approaches at the Tualatin River Bridge.

Work includes but is not limited to the following: Cold plane pavement removal, saw cutting & match existing pavement, installation of sediment barrier, removal of existing AC ramp, installation of sidewalk ramp, and installation of aggregate shoulders.

Prequalification:

To be eligible for award under this Request for Quotes (“RFQ”), Quoters (prime contractors) must submit a Prequalification application to the County at least two business days prior to the RFQ Closing. County will reject quotes from Quoters who are not prequalified for the class of work indicated prior to the RFQ Closing.

Quoters must be prequalified in Asphalt Concrete Paving and Oiling (ACP).

Performance and Payment Bonds

Quotes in excess of \$50,000 the Contractor must obtain and pay for performance and payment bonds which shall be a required part of the Contract.

Bid Bond:

Quotes in excess of \$100,000.00 will require a bid bond with submitted quote.

The County may reject a quote that does not comply with prescribed public contracting procedures and requirements, including the requirement to demonstrate the Quoters responsibility under ORS 279C.375(3)(b), and the County may reject for good cause all quotes after finding that doing so is in the public's interest.

Quoter must be actively licensed with the Oregon Construction Contractor's Board at the time of Quote submission and throughout any performance of work if awarded a contract.

The Scope further includes the following Plans, Specifications and Drawings:

- SPECIAL PROVISIONS FOR HIGHWAY CONSTRUCTION DEPARTMENT OF TRANSPORTATION AND DEVELOPMENT TUALATIN RIVER (SW PETES MOUNTAIN RD) BRIDGE APPROACH REPAIR CONSTRUCTION, dated April 2018.
- Tualatin River (SW Petes Mountain Rd) Bridge Approach Repair Project Drawing Set: Drawing Sheet No. 1; 1A; 2A; 2B; 2B-2; 2B-3; 2B-4; 3; 4; SS-1; SS-2; SS-3; SS-4; and SS-5.

Prevailing Wage

Prevailing Wage Rates requirements apply to this project because the maximum compensation for all owner-contracted work is more than \$50,000. The selected contractor and all subcontractors shall comply with the provision of ORS 279C.800 through 279C.870, relative to the Prevailing Wage Rates and the required public works bond.

PREVAILING WAGE RATES for Public Works Contracts in Oregon, January 1, 2018, as amended on April 1, 2018 which can be downloaded at the following web address: http://www.oregon.gov/boli/WHD/PWR/Pages/pwr_state.aspx.

The Work will take place in Clackamas County, Oregon.

Engineers Estimate: \$98,000.00

Key Dates:

Notice to Proceed ("NTP") does not all access to the site. The work site will not be available to the contractor until July 1, 2018.

Substantial Completion: August 30, 2018

Final Completion: December 31, 2018

Liquidated Damages:

Time is of the essence for this Project. Note the Liquidated Damages requirements as described in the 00180.85(b) of the Special Provisions for Highway Construction Department of Transportation and Development Tualatin River (SW Petes Mountain Rd) Bridge Approach Repair Construction.

3. Sample Contract

Submission of a Quote in response to this RFQ indicates Quoter's willingness to enter into a contract containing substantially the same terms of the Public Improvement Contract, which can be found at: <http://www.clackamas.us/bids/terms.html>, with the below indicated requirements. No action or

response to the sample contract is required under this RFQ. ***The following insurance requirements will be applicable:***

- ☐ Professional Liability: combined single limit, or the equivalent, of not less than \$1,000,000 per occurrence, with an annual aggregate limit of \$2,000,000 for damages caused by error, omission or negligent acts.
- ☒ Commercial General Liability: combined single limit, or the equivalent, of not less than \$1,000,000 per occurrence, with an annual aggregate limit of \$2,000,000 for Bodily Injury and Property Damage.
- ☒ Automobile Liability: combined single limit, or the equivalent, of not less than \$500,000 per occurrence for Bodily Injury and Property Damage.

4. Quote

Quotes should be short and concise with the following information:

- A. Prequalification in Asphalt Concrete Paving and Oiling;
- B. Not-to-exceed price to complete the project- Provide attached Schedule of Prices;
- C. Clackamas County Certifications Form; and
- D. Any additional information that Clackamas County should take into consideration for the project or qualifications.

5. Evaluation

The quote received from the lowest responsive responsible Quoter will be awarded a contract. The "lowest responsive responsible Quoter" is the lowest Quoter who has substantially complied with all requirements of the Request for Quote and who can be expected to deliver promptly and perform reliably in the determination of Clackamas County.

CLACKAMAS COUNTY CERTIFICATIONS
RFQ #2018-43

Each Quoter must read, complete and submit a copy of this Clackamas County Certification with their Quote. Failure to do so may result in rejection of Quote. By signature on this Certification the undersigned certifies that they are authorized to act on behalf of the Quoter and that under penalty of perjury the undersigned will comply with the following:

SECTION I. OREGON TAX LAWS

As required in ORS 279B.110(2)(3), the undersigned hereby certifies that, to the best of the undersigned's knowledge, the Quoter is not in violation of any Oregon Tax Laws. For purposes of this certification, "Oregon Tax Laws" means a state tax imposed by ORS 320.005 to 320.150 and 403.200 to 403.250 and ORS chapters 118, 314, 316, 317, 318, 321, 323, and elderly rental assistance program under ORS 310.630 to 310.706, and local taxes administered by the Department of Revenue under ORS 305.620, all as applicable. If a contract is executed, this information will be reported to the Internal Revenue Service. Information not matching IRS records could subject Quoter to 28% backup withholding.

SECTION II. NON-DISCRIMINATION

The undersigned hereby certifies that the Quoter has not and will not discriminate in its employment practices with regard to race, creed, age, religious affiliation, sex, disability, sexual orientation, national origin, or any other protected class. Nor has Quoter or will Quoter discriminate against a subcontractor in the awarding of a subcontract because the subcontractor is a disadvantaged business enterprise, a minority-owned business, a woman-owned business, a business that a service-disabled veteran owns or an emergency small business that is certified under ORS 200.055.

SECTION III. CONFLICT OF INTEREST

The undersigned hereby certifies that no elected official, officer, agency or employee of Clackamas County is personally interested, directly or indirectly, in any resulting contract from this RFQ, or the compensation to be paid under such contract, and that no representation, statements (oral or in writing), of the County, its Commissioners, officers, agents, or employees had induced Quoter to submit this Quote. In addition, the undersigned hereby certifies that this proposal is made without connection with any person, firm, or corporation submitting a quote for the same material, and is in all respects fair and without collusion or fraud.

SECTION IV. COMPLIANCE WITH SOLICITATION

The undersigned further agrees and certifies that they:

1. Have read, understand and agree to be bound by and comply with all requirements, instructions, specifications, terms and conditions of the RFQ (including any attachments); and
2. Are an authorized representative of the Quoter, that the information provided is true and accurate, and that providing incorrect or incomplete information may be cause for rejection of the Quote or contract termination; and
3. Will furnish the designated item(s) and/or service(s) in accordance with the RFQ and Quote; and
4. Will use recyclable products to the maximum extend economically feasible in the performance of the contract work set forth in this RFQ.

Firm Name: _____ Date: _____

Signature: _____ Title: _____

Name: _____ Telephone: _____

Email: _____ OR CCB # (if applicable): _____

Business Designation (check one):

☐ Corporation ☐ Partnership ☐ Sole Proprietorship ☐ Non-Profit ☐ Limited Liability Company

☐ Resident Quoter, as defined in ORS 279A.120

☐ Non-Resident Quote. Resident State: _____

Oregon Business Registry Number: _____

CLACKAMAS COUNTY INSTRUCTIONS TO QUOTERS

Quotes are subject to the applicable provisions and requirements of the Clackamas County Local Contract Review Board Rule C-047-0270 (Intermediate Procurements) and Oregon Revised Statutes.

QUOTE PREPARATION

1. **QUOTE FORMAT:** Quotes must be submitted as indicated in the RFQ. Quotes may be submitted in writing to Clackamas County via e-mail, mail or in person.
2. **CONFORMANCE TO RFQ REQUIREMENTS:** Quotes must conform to the requirements of the RFQ. Unless otherwise specified, all items quoted are to be new, unused and not remanufactured in any way. Any requested attachments must be submitted with the quote and in the required format. Quote prices must be for the unit indicated on the quote. Failure to comply with all requirements may result in quote rejection.
3. **ADDENDA:** Only documents issued as addenda by Clackamas County serve to change the RFQ in any way. No other directions received by the Quoter, written or verbal, serve to change the RFQ document. NOTE: IF YOU HAVE RECEIVED A COPY OF THE RFQ, YOU SHOULD CONSULT THE CLACKAMAS COUNTY BIDS AND CONTRACT INFORMATION WEBSITE (www.clackamas.us/bids/index.html) TO ENSURE THAT YOU HAVE NOT MISSED ANY ADDENDA OR ANNOUNCEMENTS. QUOTERS ARE NOT REQUIRED TO RETURN ADDENDUMS WITH THEIR QUOTE. HOWEVER, QUOTERS ARE RESPONSIBLE TO MAKE THEMSELVES AWARE OF, OBTAIN AND INCORPORATE ANY CHANGES MADE IN ANY ADDENDA ISSUED, AND TO INCORPORATE ANY CHANGES MADE BY ADDENDUM INTO THEIR FINAL QUOTE. FAILURE TO DO SO MAY, IN EFFECT, MAKE THE QUOTER'S QUOTE NON-RESPONSIVE, WHICH MAY CAUSE THE QUOTE TO BE REJECTED.
4. **USE of BRAND or TRADE NAMES:** Any brand or trade names used by Clackamas County in the specifications are for the purpose of describing and establishing the standard of quality, performance and characteristics desired and are not intended to limit or restrict competition. Quoters may submit quotes for substantially equivalent products to those designated unless the RFQ provides that a specific brand is necessary because of compatibility requirements, etc. All such brand substitutions shall be subject to approval by Clackamas County.
5. **PRODUCT IDENTIFICATION:** Quoters must clearly identify all products quoted. Brand name and model or number must be shown. Clackamas County reserves the right to reject any quote when the product information submitted with the quote is incomplete.
6. **FOB DESTINATION:** Unless specifically allowed in the RFQ, ***QUOTE PRICE MUST BE F.O.B. DESTINATION with all transportation and handling charges included in the Quote.***
7. **DELIVERY:** Delivery time must be shown in number of calendar days after receipt of purchase order.
8. **EXCEPTIONS:** Any deviation from quote specifications, or the form of sample contract referenced in this RFQ, may result in quote rejection at County's sole discretion.
9. **SIGNATURE ON QUOTE:** Quotes must be signed by an authorized representative of the Quoter. Signature on a quote certifies that the quote is made without connection with any person, firm or corporation making a quote for the same goods and/or services and is in all respects fair and without collusion or fraud. Signature on a quote also certifies that the Quoter has read and fully understands all quote specifications, and the sample contract referenced in this RFQ (including insurance requirements). No consideration will be given to any claim resulting from quoting without comprehending all requirements of the RFQ.
10. **QUOTE MODIFICATION:** Quotes, once submitted, may be modified in writing before the time and date set for quote closing. Any modifications should be signed by an authorized representative, and state that the new document supersedes or modifies the prior quote. Quoters may not modify quotes after quote closing time.
11. **QUOTE WITHDRAWALS:** Quotes may be withdrawn by request in writing signed by an authorized representative and received by Clackamas County prior to the Quote Due Date/Time. Quotes may also be withdrawn in person before the Quote Due Date/Time upon presentation of appropriate identification.

- 12. QUOTE SUBMISSION:** Quotes may be submitted by returning to Clackamas County Procurement Division in the location designated in the introduction of the RFQ via email, mail or in person; however, no oral or telephone quotes will be accepted. Envelopes, or e-mails containing Quotes should contain the RFQ Number and RFQ Title.

QUOTE EVALUATION AND AWARD

- 1. PRIOR ACCEPTANCE OF DEFECTIVE PROPOSALS:** Due to limited resources, Clackamas County generally will not completely review or analyze quotes which fail to comply with the requirements of the RFQ or which clearly are not the best quotes, nor will Clackamas County generally investigate the references or qualifications of those who submit such quotes. Therefore, neither the return of a quote, nor acknowledgment that the selection is complete shall operate as a representation by Clackamas County that an unsuccessful quote was complete, sufficient, or lawful in any respect.
- 2. DELIVERY:** Significant delays in delivery may be considered in determining award if early delivery is required.
- 3. CASH DISCOUNTS:** Cash discounts will not be considered for award purposes unless stated in the RFQ.
- 4. PAYMENT:** Quotes which require payment in less than 30 days after receipt of invoice or delivery of goods, whichever is later, may be rejected.
- 5. INVESTIGATION OF REFERENCES:** Clackamas County reserves the right to investigate references and or the past performance of any Quoter with respect to its successful performance of similar services, compliance with specifications and contractual obligations, and its lawful payment of suppliers, sub-contractors, and workers. Clackamas County may postpone the award or execution of the contract after the announcement of the apparent successful Quoter in order to complete its investigation. Clackamas County reserves the right to reject any quote or to reject all quotes at any time prior to Clackamas County's execution of a contract if it is determined to be in the best interest of Clackamas County to do so.
- 6. METHOD OF AWARD:** Clackamas County reserves the right to make the award by item, groups of items or entire quote, whichever is in the best interest of Clackamas County.
- 7. QUOTE REJECTION:** Clackamas County reserves the right to reject any and all quotes.
- 8. QUOTE RESULTS:** Quoters who submit a quote will be notified of the RFQ results. Awarded quote files are public records and available for review by submitting a public records request or by appointment.

SCHEDULE OF PRICES - RFQ #2018-43

Tualatin River (SW Petes Mountain Rd) Bridge Approach Repair Project						
Spec No.	Item No.	ITEM DESCRIPTION	UNIT	AMOUNT	UNIT PRICE	TOTAL PRICE
MOBILIZATION AND TRAFFIC CONTROL						
0196	1	EXTRA WORK AS AUTHORIZED	FA	-	-	\$15,000.00
0210	2	MOBILIZATION	LS	ALL		
TRAFFIC CONTROL						
0225	3	TEMPORARY WORK ZONE TRAFFIC CONTROL, COMPLETE	LS	1		
EROSION CONTROL						
0280	4	EROSION CONTROL	LS	1		
0280	5	SEDIMENT BARRIER, TYPE 8	FOOT	285		
0290	6	POLLUTION CONTROL PLAN	LS	1		
ROADWORK						
0310	7	REMOVAL OF STRUCTURES AND OBSTRUCTIONS	LS	1		
0310	8	ASPHALT PAVEMENT SAW CUTTING	FOOT	100		
331	9	12 INCH SUBGRADE STABILATION	SY	50		
334	10	PREPARATION OF SHOULDERS	LS	1		
BASES						
0620	11	COLD PLANE PAVEMENT REMOVAL, 2 INCH DEEP	SQYD	258		
0620	12	COLD PLANE PAVEMENT REMOVAL, 9 INCH DEEP	SQYD	220		
0620	13	COLD PLANE PAVEMENT REMOVAL, 12 INCH DEEP	SQYD	210		
0640	14	3/4 INCH - 0 AGGREGATE BASE	TON	30		
WEARING SURFACES						
0744	15	LEVEL 3, 1/2 INCH DENSE HMAC MIXTURE @ 2" DEEP (Wearing Course)	TON	80		
0744	16	LEVEL 3, 1/2 INCH DENSE HMAC MIXTURE @ 7-10" DEEP (Base / Leveling Course)	TON	200		
759	17	CONCRETE WALKS	SF	70		
759	18	TRUNCATED DOMES ON NEW SURFACES	EA	2		
759	19	EXTRA FOR NEW SIDEWALK RAMPS	EA	2		
PERMANENT TRAFFIC CONTROL AND GUIDANCE DEVICES						
855	20	BI-DIRECTIONAL YELLOW TYPE I MARKERS, RECESSED	EA	17		
865	21	THERMOPLASTIC, EXTRUDED OR SPRAYED, SURFACE, NON- PROFIED	FOOT	3,700		

PROPOSED COST BID SCHEDULE _____
(Numerically)

PROPOSED COST BID SCHEDULE _____
(Written in Words)

COMPANY NAME _____

AUTHORIZED SIGNATURE _____



**CLACKAMAS COUNTY
PUBLIC IMPROVEMENT CONTRACT**

BID BOND

Project Name: #2018-43 Tualatin River Bridge Approach Repair

We, _____, as "Principal,"
(Name of Principal)

and _____, an _____ Corporation,
(Name of Surety)

authorized to transact Surety business in Oregon, as "Surety," hereby jointly and severally bind ourselves, our respective heirs, executors, administrators, successors and assigns to pay unto Clackamas County ("Obligee") the sum of (\$_____)

_____ dollars.

WHEREAS, the condition of the obligation of this bond is that Principal has submitted its proposal or bid to an agency of the Obligee in response to Obligee's procurement document (No. _____) for the project identified above which proposal or bid is made a part of this bond by reference, and Principal is required to furnish bid security in an amount equal to ten (10%) percent of the total amount of the bid pursuant to the procurement document.

NOW, THEREFORE, if the Obligee shall accept the bid of the Principal and the Principal shall enter into a Contract with the Obligee in accordance with the terms of such bid, and give such bond or bonds as may be specified in the bidding or Contract Documents with good and sufficient surety for the faithful performance of such Contract and for the prompt payment of labor and material furnished in the prosecution thereof, or in the event of the failure of the Principal to enter such Contract and give such bond or bonds, if the Principal shall pay to the Obligee the difference not to exceed the penalty hereof between the amount specified in said bid and such larger amount for which the Obligee may in good faith contract with another party to perform the Work covered by said bid, then this obligation shall be null and void, otherwise to remain in full force and effect.

IN WITNESS WHEREOF, we have caused this instrument to be executed and sealed by our duly authorized legal representatives this _____ day of _____, 20____.

Principal: _____ Surety: _____

By: _____ By: Attorney-In-Fact
Signature

_____ Name
Official Capacity

Attest: _____ Address
Corporation Secretary

_____ City State Zip

_____ Phone Fax

**SPECIAL PROVISIONS
FOR HIGHWAY CONSTRUCTION**

**DEPARTMENT OF TRANSPORTATION
AND DEVELOPMENT
CLACKAMAS COUNTY, OREGON**

**TUALATIN RIVER (SW PETES MOUNTAIN RD) BRIDGE
APPROACH REPAIR CONSTRUCTION**

ASPHALT CONCRETE PAVING AND OILING

APRIL 2018

TABLE OF CONTENTS FOR SPECIAL PROVISIONS

SECTION 00110 – ORGANIZATION, CONVENTIONS, ABBREVIATIONS AND DEFINITIONS	1
SECTION 00120 – BIDDING REQUIREMENTS AND PROCEDURES	5
SECTION 00130 – AWARD AND EXECUTION OF CONTRACT	7
SECTION 00140 – SCOPE OF WORK	8
SECTION 00160 – SOURCE OF MATERIALS	13
SECTION 00165 – QUALITY OF MATERIALS	14
SECTION 00170 – LEGAL RELATIONS AND RESPONSIBILITIES	15
SECTION 00180 – PROSECUTION AND PROGRESS	17
SECTION 00190 – MEASUREMENT OF PAY QUANTITIES	20
SECTION 00195 – PAYMENT	21
SECTION 00196 – PAYMENT FOR EXTRA WORK	23
SECTION 00197 – PAYMENT FOR FORCE ACCOUNT WORK	24
SECTION 00199 – DISAGREEMENTS, PROTESTS AND CLAIMS	25
SECTION 00210 - MOBILIZATION	27
SECTION 00220 - ACCOMMODATIONS FOR PUBLIC TRAFFIC.....	27
SECTION 00225 - WORK ZONE TRAFFIC CONTROL	27
SECTION 00280 - EROSION AND SEDIMENT CONTROL	32
SECTION 00290 - ENVIRONMENTAL PROTECTION.....	33
SECTION 00310 - REMOVAL OF STRUCTURES AND OBSTRUCTIONS	33
SECTION 00330 - EARTHWORK	34
SECTION 00331 - SUBGRADE STABILIZATION	34
SECTION 00334 - PREPARATION OF SHOULDERS	34
SECTION 00350 - GEOSYNTHETIC INSTALLATION	35
SECTION 00620 - COLD PLANE PAVEMENT REMOVAL	35
SECTION 00640 - AGGREGATE BASE AND SHOULDERS	36
SECTION 00730 - EMULSIFIED ASPHALT TACK COAT	36
SECTION 00744 - ASPHALT CONCRETE PAVEMENT	36
SECTION 00759 - MISCELLANEOUS PORTLAND CEMENT CONCRETE STRUCTURES	36
SECTION 00850 - COMMON PROVISIONS FOR PAVEMENT MARKINGS	38
SECTION 00855 - PAVEMENT MARKERS	39
SECTION 00865 - LONGITUDINAL PAVEMENT MARKINGS - DURABLE	39
SECTION 02010 - PORTLAND CEMENT	39
SECTION 02050 - CURING MATERIALS	40
SECTION 02320 - GEOSYNTHETICS	40
SECTION 02510 - REINFORCEMENT	43
SECTION 02910 - SIGN MATERIALS	44

Specifications for Proposed Bridge Approach Repair
On Tualatin River (SW Petes Mountain Rd) Bridge Approach Repair Project

PROFESSIONAL OF RECORD CERTIFICATION(s):

 <p>REGISTERED PROFESSIONAL ENGINEER 86225PE OREGON MARCH 14, 2017 JONATHAN HANGARTNER EXPIRES 06-30-2019</p>	<p>I certify that the Special Provision Sections listed below were prepared by me or under my supervision.</p> <p>Sections: 00210, 00220, 00225, 00280, 00290, 00310, 00330, 00331, 00350, 00620, 00640, 00730, 00744, 00759, 00850, 00855, 00865, 02010, 02050, 02320, 02510, and 02910.</p>
<p>Date Signed: <u>4/4/18</u></p>	

SPECIAL PROVISIONS

APPLICABLE SPECIFICATIONS

The Specification that is applicable to the Work on this Project is the 2015 edition of the "Oregon Standard Specifications for Construction".

All number references in these Special Provisions shall be understood to refer to the Sections and subsections of the Standard Specifications and Supplemental Specifications bearing like numbers and to Sections and subsections contained in these Special Provisions in their entirety.

SECTION 00110 – ORGANIZATION, CONVENTIONS, ABBREVIATIONS AND DEFINITIONS

Comply with Section 00110 of the Standard Specifications supplemented and/or modified as follows:

00110.05(d) References to Laws, Acts, Regulations, Rules, Ordinances, Statutes, Orders, and Permits

Add the following to the first bullet (Statutes and Rules):

- Clackamas County's Local Contract Review Board (LCRB) Rules are accessible online on the County's website (<http://www.clackamas.us/code/documents/appendixc.pdf>).

00110.10 Abbreviations

Add the following:

CCDA -	Clackamas County Development Agency
DTD -	Clackamas County Department of Transportation and Development
LCRB -	Local Contract Review Board
ODFW -	Oregon Department of Fish and Wildlife
UNS -	Utility Notification System
WES -	Water Environment Services of Clackamas County

00110.20 Definitions

Add or modify definitions as follows:

Agreement Form – The written agreement between the Owner and Contractor covering the work to be performed under the contract.

Amendment – A contract modification for Additional Work, Changed Work, Extra Work, Field Directives, or other changes. An Amendment changes the contract value, scope, and/or time. Amendments require formal approval by the Board of County Commissioners, pursuant to LCRB Rule Division C-049-160, prior to approval of such work.

Approved Equal - Materials or services proposed by the contractor and approved by the County as equal substitutes for those materials or services specified.

Award – Same as “Notice to Intent to Award”.

BCC – The Clackamas County Board of County Commissioners

Bid - A written offer by a bidder on forms furnished by the County to do work stated in the bid documents at the prices quoted. "Bid" is synonymous with "proposal" in these bid documents.

Bid Closing - The date and time for Bid Closing is the same as the date and time for Bid Opening.

Bid Documents- The following documents together comprise the Bid Documents:

- Invitation to Bid, Instructions to Bidders, Bid Form, Bid Proposal, Schedule of Prices, Bid
- Bond, Performance Bond
- Certificate of Insurance, Prevailing Wage Rates
- The "Oregon Standard Specifications for Construction" by ODOT and APWA, 2015 edition.
- Plans and drawings
- Other bid documents included or referenced in the bid documents
- Addenda, if any
- The Agreement Form and Special Provisions

Bonds - The bond or surety bond is a written document given by the surety and principal to the obligee to guarantee a specific obligation.

Change Order - A price agreement for Extra Work, Changed Work, field directives, or other changes. A Change Order does not change the contract value, scope, or time until it is incorporated into an Amendment. Change Orders will be agreed upon, in writing, by the County Project Manager and the Contractor's designated representative.

Contract - The written contract agreement, including amendments, signed by the Contractor and Clackamas County, which describes the work to be done, the contract amount, and defines the relationships and obligations of the Contractor and the County.

Contract Documents - The Invitation to Bid, the Instructions to Bidders, the accepted Bid Proposal and Schedule of Prices, the Subcontractor List, the Bid Bond, the Performance and Payment Bond, the Certificate of Insurance, the Prevailing Wage Rates, the Standard Specifications and Special Provisions, Amendments, the Plans and Drawings, the Agreement, as well as all documents incorporated by reference therein, and any and all addenda prepared by or at the direction of and adopted by the County and further identified by the signature of the parties and all modifications thereof incorporated in the documents before their execution.

County - The term "County" shall mean Clackamas County, including the Board of County Commissioners, employees and agents of the County authorized to administer the conditions of these contract documents.

Department – A subdivision of the Agency.

Engineer - The County's Project Manager either acting directly or through an authorized representative(s). When referring to approval of extra work or other Contract modifications, "Engineer" also refers to the County's legal authority according to the LCRB rules.

Invitation to Bid - The public announcement (Notice to Contractors) inviting bids for work to be performed or materials to be furnished.

Legal Holiday - As defined in ORS 279C.540.

Lump Sum - A method of payment providing for one all-inclusive cost for the work or for a particular portion of the work.

Notice of Intent to Award - A written notice from the County notifying bidders that the County intends to award to the responsible bidder submitting lowest responsive bid.

ODOT Procurement Office – Clackamas County Purchasing Department.

Owner – Synonymous with Agency.

Plan Holder's List – A list of contractor's names, contact names, phone and fax numbers that the County's Purchasing Department creates during bidding of the Project.

Project Manager – The Owner's representative who directly supervises the engineering and administration of the contract.

Shop Drawings – Synonymous with Working Drawings.

Solicitation Document – Synonymous with Bid Documents.

Standard Drawings – The Agency-prepared detailed drawings for Work or methods of construction that normally do not change from project to project. The Standard Drawings include the ODOT Standard Drawings.

Standard Specifications - "Oregon Standard Specifications for Construction", current edition, published by the Oregon Department of Transportation and as amended by **the Agency**.

State - Where the term "State" or "State of Oregon" or "ODOT" appears in the contract documents it shall mean "Clackamas County", "State of Oregon", or "ODOT" as applicable because of context.

Work Day - Any and every calendar day from January 1 to December 31 of every year, excluding Saturdays, Sundays and Legal Holidays.

END OF SECTION

SECTION 00120 – BIDDING REQUIREMENTS AND PROCEDURES

Comply with Section 00120 of the Standard Specifications supplemented and/or modified as follows:

00120.00 Prequalification of Bidders - Delete and replace with the following:

See Instructions to Bidders.

00120.01 General Bidding Requirements – Delete and replace with the following:

See Instructions to Bidders.

00120.05 Request for Plans, Special Provisions, and Bid Booklets: – Delete and replace with the following:

See Notice of Public Improvement Contract and Instructions to Bidders.

Copies of the 2015 Oregon Standard Specifications for Construction and Supplements might be found on the Oregon Department of Transportation website at:

http://www.oregon.gov/ODOT/Business/Pages/Standard_Specifications.aspx

00120.15 Examination of Work Site and Solicitation Documents; Consideration of Conditions to be Encountered – Delete the third paragraph.

00120.17 Use of Agency-Owned Land for Staging or Storage Areas – Add the following:

If no County-owned adjacent property is available for the Contractor, no changes here are necessary. If there is County-owned adjacent property but it won't be available, a specific restriction should be mentioned in 00120.17 (b) and (c).

00120.30 Changes to Plans, Specifications, or Quantities before Opening of Bids - Delete and replace with the following:

See Instructions to Bidders.

00120.40 Preparation of Bids – Delete and replace this section with the following:

See Instructions to Bidders.

00120.45 Submittal of Bids - Delete and replace with:

See Instructions to Bidders.

00120.50 Submitting Bids for More than One Contract – Delete this subsection.

00120.60 Revision or Withdrawal of Bids - Delete and replace with the following:

See Instructions to Bidders.

Tualatin River (SW Petes Mountain Rd) Bridge Approach Repair Construction

00120.68 Mistakes in Bids – Delete and replace with the following:

See Instructions to Bidders.

00120.70 Rejection of Nonresponsive Bids – Delete and replace with the following:

See Instructions to Bidders.

00120.95 Opportunity for Cooperative Arrangement – Delete this section.

END OF SECTION

SECTION 00130 – AWARD AND EXECUTION OF CONTRACT

Comply with Section 00130 of the Standard Specifications supplemented and/or modified as follows:

00130.00 Consideration of Bids - Delete third paragraph.

00130.10 Award of Contract - Delete and replace with the following:

See Instructions to Bidders.

00130.15 Right to Protest Award – Delete and replace with the following:

See Instructions to Bidders.

00130.30 Contract Booklet – Add the following:

Other documents are part of the contract documents by reference. These include, but are not limited to:

- The "Oregon Standard Specifications for Construction", 2015 Edition, as published by the Oregon Department of Transportation (ODOT).
- "Oregon Standard Drawings" latest edition, as published by ODOT.
- Clackamas County Service District No. 1 "Surface Water Standard Specifications", latest edition.

00130.40 Contract Submittals - Delete and replace with the following:

See Instructions to Bidders.

00130.70 Release of Bid Guaranties – Delete and replace with the following:

See Instructions to Bidders.

00130.80 Project Site Restriction- Replace the paragraph that begins "Until the Agency sends...", with the following paragraph:

Until the Agency sends the Contractor written Notice to Proceed with the Work, and the Contractor has filed the public works bonds required in 00170.20, the Contractor shall not go onto the Project Site on which the Work is to be done, nor move Materials, Equipment or workers onto the Project Site.

END OF SECTION

SECTION 00140 – SCOPE OF WORK

Comply with Section 00140 of the Standard Specifications supplemented and/or modified as follows:

00140.30 Agency-Required Changes in the Work – Replace the last paragraph with the following:

Upon receipt of an Engineer's written order modifying the Work, the Contractor shall perform the Work as modified via Change Order, which may be subject to approval as an Amendment.

If an Amendment incorporating changes to the Work increases the Contract amount, the Contractor shall notify its Surety of the increase and shall provide the Agency with a copy of any resulting modification to bond documents. The Contractor's performance of Work pursuant to Amendments shall neither invalidate the Contract nor release the Surety. Payment for changes in the Work shall be made in accordance with 00195.20. Contract Time adjustments shall be made in accordance with 00180.80.

00140.31 "As-Built" Records - Add the following section:

Maintain a current and accurate record of the work completed during the course of this contract. This may be in the form of "as-built" drawings kept by accurately marking a designated set of the contract plans with the specified information as the Work proceeds. Accurate, complete and current "as-built" drawings are a specified requirement for full partial payment of the work completed. At project completion and as a condition of final payment, the Contractor shall deliver to the Project Manager a complete and legible set of "as-built" drawings.

The "as-built" drawings must show the information listed below. Where the term "locate" or "location" is used, it shall mean record of position with respect to both the construction vertical datum and either construction horizontal datum or a nearby permanent improvement.

- 1) Record location of underground services and utilities as installed.
- 2) Record location of existing underground utilities and services that are to remain and that are encountered during the course of the work.
- 3) Record changes in dimension, location, grade or detail to that shown on the plans.
- 4) Record changes made by change order.
- 5) Record details not in the original plans.
- 6) Provide fully completed shop drawings reflecting all revisions.

END OF SECTION

Section 00150 – Control of Work

Comply with Section 00150 of the Standard Specifications modified as follows:

00150.00 Authority of the Engineer – Delete and replace the first sentence with the following:

Except as indicated elsewhere in the Contract (e.g. Amendment approval by the BCC), the Engineer has full authority over the Work and its suspension.

00150.05 Cooperative Arrangements – Delete this section.

00150.10 Coordination of Contract Documents

(a) Order of Precedence – Delete this section and replace with the following:

The Engineer will resolve any discrepancies between these documents in the following order of precedence:

- Approved Amendments;
- Approved Change Orders
- Bid Schedule with Schedule of Prices;
- Permits from governmental agencies
- Special Provisions;
- Agency-prepared drawings specifically applicable to the Project and bearing the Project title;
- Reviewed and accepted, stamped Working Drawings;
- Agreement Form;
- Standard Drawings;
- Approved Unstamped Working Drawings;
- Standard Specifications;
- All other Contract Documents not listed above.

Notes on a drawing shall take precedence over drawing details.

Dimensions shown on the drawings, or that can be computed, shall take precedence over scaled dimensions.

00150.15(c) Contractor Responsibilities - Replace this subsection, except for the subsection number and title, with the following:

00150.50 Cooperation with Utilities: Add the following to the end of Paragraph (a):

There may be other utility servers who are not specifically listed in these Special Provisions or on the Plans that may be adjusting or inspecting their facilities within the project limits.

00150.50(c) Contractor Responsibilities – Add the following to the bulleted list:

- Hold a utility scheduling meeting and monthly utility coordination meetings (see also 00180.42);
- Maintain and re-establish utility location marks according to OAR 952-001-0090(2)(a). Coordinate re-establishment of the location marks with the associated Utility;
- Determine the exact location before excavating within the reasonable accuracy zone according to OAR 952-001-0090(2)(c);
- Backfill any exposed utilities as recommended and approved by the Utility representative. Obtain utility locate warning tape from the Utility and replace damaged or removed warning tape. Utility locate warning tape may not be present at all existing utilities;
- Stake, place warning tape, and maintain no work limits around critical Utility facilities as shown or directed by the Engineer and the Utility; and
- In addition to the notification required in OAR 952-001-0090(5), notify the Engineer and the Utility as soon as the Contractor discovers any previously unknown Utility conflicts or issues. Contrary to the OAR, stop excavating until directed by the Engineer and allow the Utility a minimum of two weeks to relocate or resolve the previously unknown utility issues.

The existing underground utilities shown on the Plans have been determined by as-built records and field surveys, but are not guaranteed to be complete or accurate. The Contractor shall be responsible for contacting the individual utility companies to mark locations, and arranging with them for any relocation work that should be required.

The Contractor shall make excavations and borings ahead of the work where necessary to determine the exact location of underground pipes or other features, which might interfere with construction. The Contractor shall support and protect pipes or other services where they cross the trench and shall be responsible for all damages incidental in interruptions of service that may be caused by Contractor operations. Where a new utility line crosses an existing pipeline or other conduit, the trench backfill shall be well compacted in a manner that provides for the required backfill and compaction standards while protecting the utility in question.

00150.50 Cooperation with Utilities - Add the following subsection:

(f) Utility Information:

There are no anticipated conflicts with the Utilities listed below. Contact those Utilities having buried facilities and request that they locate and mark them for their protection prior to construction.

Utility	Contact Person's Name and Phone Number
1. Portland General Electric	Howard Joham 503-849-7003
2. CenturyLink	Scott Miller 503-754-7289

Tualatin River (SW Petes Mountain Rd) Bridge Approach Repair Construction

- 3. NW Natural Rich Girard 360-921-0314
- 4. Comcast Randy Shields 360-301-1962
- 1. (NW Natural - "Gas Company")
(Rich Girard 360-921-0314)

Notify, in writing, NW Natural at least 14 Calendar Days (2 weeks) before beginning Work on the Project.

NW Natural has underground gas lines that may be within 15 feet of the excavation. There are no anticipated conflicts with this facility. However, due to the close proximity of the underground gas lines NW Natural will monitor, inspect, and protect.

- 2..(Portland General Electric - " Power Company ")
(Howard Joham, 503-849-7003)

Energized power lines overhang portions of the Work with a minimum vertical clearance of 18 feet. Contractor shall maintain at least 10 feet of safety clearance. Exceptions require written approval from Portland General and may require an On-Site safety watcher, at no cost to the Contractor. Provide the Engineer a copy of the written approval of exception before beginning work.

Energized power lines are located within the project limits. Contractor shall maintain at least 10 feet of safety clearance. Exceptions require written approval from Power Company and will require an On-Site safety watcher at no cost to the Contractor. Provide Engineer with a copy of the written approval of exception before beginning work.

Notify, in writing, Portland General Electric at least 14 Calendar Days (2 weeks) before beginning Work on the Project.

Portland General Electric operates a power facility within the Project limits within the roadway excavation limits along SW Petes Mountain Road. Notify, in writing, at least 14 Calendar Days (2 weeks) before beginning excavation. Allow Portland General Electric 14Calendar Days (2 weeks) to complete relocation (readjustment) work.

Coordinate with Portland General Electric to perform excavation within 10 feet of the aerial power line during times when Portland General Electric cannot de-energize their system.

- 3. (Comcast - "Telecommunication Company")
(Randy Shields 360-301-1962)

Notify, in writing, Comcast at least 14 Calendar Days (2 weeks) before beginning excavation within 10 feet of Comcast conduit. Allow Comcast 14 Calendar Days (14 weeks) to complete relocation (readjustment) work.

- 3. (CenturyLink - "Telecommunication Company")

Tualatin River (SW Petes Mountain Rd) Bridge Approach Repair Construction

(Scott Miller 503-754-7289)

Notify, in writing, CenturyLink at least 14 Calendar Days (2 weeks) before beginning excavation within 10 feet of Comcast conduit. Allow CenturyLink 14 Calendar Days (14 weeks) to complete relocation (readjustment) work.

00150.60(a) Load and Speed Restrictions for Construction Vehicles and Equipment - Add the following bullet to the end of the bullet list:

- The Contractor shall restrict the combined weights of construction vehicles, Equipment, and Materials on Bridges according to 00220.45.

If there are no private improvements that may be damaged during construction, no modification to Section 00150.70 is required.

END OF SECTION

SECTION 00160 – SOURCE OF MATERIALS

Comply with Section 00160 of the Standard Specifications supplemented and/or modified as follows:

00160.05 Qualified Products List (QPL) - Replace this subsection, except for the subsection number and title, with the following:

The QPL is a listing of manufactured products available on the market (shelf items) that ODOT has evaluated and found suitable for a specified use in highway construction. The QPL is available from ODOT's Construction Section website at:

<http://www.oregon.gov/ODOT/Construction/Pages/Qualified-Products.aspx>

The most current published PDF version of the QPL on ODOT's Construction Section website at the time of Advertisement is the version in effect for the Project. The Engineer may approve for use a conditionally qualified product, or a product qualified for inclusion in a later edition of the QPL, if the Engineer finds the product acceptable for use on the Project.

Use of listed products shall be restricted to the category of use for which they are listed. The Contractor shall install all products as recommended by the manufacturer. The Contractor shall replace qualified products not conforming to Specifications or not properly handled or installed at no additional cost to the Agency.

00160.20(a) Buy America – Delete this section and replace with the following: Federal highway funds are NOT involved on this Project.

END OF SECTION

SECTION 00165 – QUALITY OF MATERIALS

Comply with Section 00165 of the Standard Specifications modified as follows:

00165.04 Costs of Testing – Replace this section with the following sentence: All testing required to be performed by the Contractor will be at the Contractor's expense.

00165.10(a) Field-Tested Materials – Add the following sentence: The County follows the MFTP on its projects:

00165.10(b) Nonfield-Tested Materials - Add the following sentence:

The County follows the NTMAG on its projects.

00165.91 Fabrication Inspection Expense - In the paragraph that begins "Fabrication of certain items...", replace the sentence that begins "Therefore, each time that..." with the following sentence:

Therefore, each time that inspection by or on behalf of the Agency is necessary, payment to the Contractor will be reduced by an amount computed at the following rates:

In the paragraph that begins "This Subsection applies to all...", replace the first sentence, but not the bullet list, with the following sentence:

This Subsection applies to all fabricated items or manufactured Materials that are inspected by or on behalf of the Agency, which include, but are not limited to:

END OF SECTION

SECTION 00170 – LEGAL RELATIONS AND RESPONSIBILITIES

Comply with Section 00170 of the Standard Specifications supplemented and/or modified as follows:

00170.00 General - Add the following two paragraphs after the paragraph that begins "In any litigation, the entire...":

The characterization of provisions of the Contract as material provisions or the failure to comply with certain provisions as a material breach of the Contract shall in no way be construed to mean that any other provisions of the Contract are not material or that failure to comply with any other provisions is not a material breach of the Contract.

All rights and remedies available to the Agency under applicable Laws are incorporated herein by reference and are cumulative with all rights and remedies under the Contract.

00170.01(a) Federal Agencies - Add the following to the list of Federal Agencies:

National Oceanic and Atmospheric Administration

00170.02 Permits, Licenses, and Taxes – Add the following:

This project is to be constructed in Clackamas County road right of way and streets. There are no separate road opening permits required from Clackamas County to perform the work required under this contract.

If the County has acquired all necessary rights of way for the project, no modification to Section 00170.03 is required.

00170.61(a) Workers' Compensation - In the paragraph, replace "00170.70(d)" with "the Agreement".

00170.65(a) General - Add the following paragraph to the end of this subsection:

As required by ORS 279C.520, compliance by the Contractor with the prohibitions in ORS 652.220 is a material element of the Contract and failure to comply is a material breach that entitles the Agency to exercise any remedies available under the Contract, including but not limited to termination for default. The Contractor shall not prohibit any of the Contractor's employees from, or retaliate against an employee for, discussing the employee's rate of wage, salary, benefits or other compensation with another employee or another person.

Add the following subsection:

00170.67 Fees - The fee required by ORS 279C.825(1) will be paid by the Agency to the Commissioner of the Oregon Bureau of Labor and Industries under the administrative rules of the Commissioner.

00170.70(a) Insurance Coverages - Add the following to the end of this subsection:

The following insurance coverages and dollar amounts are required pursuant to this subsection:

Tualatin River (SW Petes Mountain Rd) Bridge Approach Repair Construction

Insurance Coverages	Combined Single Limit per Occurrence	Annual Aggregate Limit
Commercial General Liability	\$1,000,000	\$2,000,000
Commercial Automobile Liability	\$1,000,000	(aggregate limit not required)

00170.70(c) Additional Insured - Add the following paragraph and bullets to the end of this subsection:

- Clackamas County and its officers, agents, and employees
- Clackamas County Board of Commissioners

00170.72 Indemnity/Hold Harmless – Delete and replace with the following:

Clackamas County Public Improvement Contract.

Extend indemnity and hold harmless to the Agency and the following:

- Clackamas County and its officers, agents, and employees
- Clackamas County Board of Commissioners

00170.85(b-1) Contractor Warranty for Specific Items – This subsection does not apply:

END OF SECTION

SECTION 00180 – PROSECUTION AND PROGRESS

Comply with Section 00180 of the Standard Specifications supplemented and/or modified as follows:

00180.06 Assignment of Funds Due Under the Contract - Delete first bulleted item.

00180.21 Subcontracting - Add the following to subsection (a):

All contracts with subcontractors or suppliers shall have provisions making the contract assignable to the County, at the option of the County, if the Contractor terminates, goes out of business, declares bankruptcy, or otherwise is unable to perform provided that the County gives the subcontractor notice of assignment within fourteen (14) days of learning of the inability of the Contractor to perform.

The Engineer may revoke consent to subcontract. If the Engineer revokes consent to subcontract, the subcontractor shall be immediately removed from the Project Site.

00180.22 Payments to Subcontractors and Agents of the Contractor - Replace the paragraph that begins "To the extent practicable..." with the following paragraph:

To the extent practicable, the Contractor shall pay in the same units and on the same basis of measurement as listed in the Schedule of Items for subcontracted Work or other Work not done by the Contractor's own organization. The Agency will not be responsible for any overpayment or losses resulting from overpayment by the Contractor to subcontractors and to its other agents, work providers, service providers, and trucking services providers.

00180.40 Limitation of Operations - Add the following to subsection:

The Contractor must provide, at a minimum, a 48-hour notice to the Clackamas County Project Manager in order to perform any work on Saturdays.

00180.40(b) On-Site Work - Add the following bullet:

Notice to proceed does not allow access to the site. The work site will not be available to the contractor until July 1st, 2018.

Add the following subsection:

00180.40(c) Specific Limitations - Limitations of operations specified in these Special Provisions include, but are not limited to, the following:

Limitations	Subsection
Opening Sections to Traffic	00744.51

Be aware of and subject to schedule limitations in the Standard Specifications that are not listed in this Subsection.

00180.41 Project Work Schedules – Add the following:

A Type "B" schedule as detailed in the Supplemental Specifications is required on this Contract. In addition, a three-week look ahead schedule shall be prepared by the Contractor on a weekly basis and submitted to the Engineer. It shall include all construction activities planned for the following three-week period. The three-week look ahead schedule can be hand-written and shall be in a format agreed upon by the Contractor and the Engineer.

00180.42 Preconstruction Conference - Add the following:

Before beginning On-Site Work and before meeting with the Engineer for the preconstruction conference, hold a group utilities scheduling meeting with representatives from the utility companies involved with this project. Incorporate the utilities time needs into the Contractor's schedule submitted prior to the preconstruction conference.

Submit the following during the preconstruction conference unless otherwise directed:

- The names, addresses, and telephone numbers of two or more persons employed by the Contractor who can be reached day or night to handle emergency matters.
- Subcontractor's list including contact list for each subcontractor with phone numbers and addresses and work to be performed.
- List of personnel authorized to sign change orders and receive progress payment warrants.
- Video recording of private properties affected by construction per 00150.70.

A representative of each subcontractor shall be required to attend the pre-construction conference.

00180.43 Commencement and Performance of Work - Add the following bullet item:

- Conduct the work at all times in a manner and sequence that will insure minimal interference with traffic. The Contractor shall not begin work that will interfere with work already started. If it is in the County's best interest to do so, the County may require the Contractor to finish a portion or unit of the project on which work is in progress or to finish a construction operation before work is started on an additional portion or unit of the project.

If there are no specific critical time periods, Section 00180.44 is not required.

Add the following subsection:

00180.50(h) Contract Time - Complete all Work to be done under the Contract before the earlier of 30 Calendar Days, or August 30, 2018.

Recording of Calendar Days will begin on the day the Contractor begins On-Site Work as defined in 00110.20.

00180.70 Suspension of Work - Add the following to the first bullet item:

If the Inspector has reason to believe that any safety provisions are not being adhered to, the Inspector will immediately notify the Contractor's site foreman and/or the appropriate person and the County Project Manager. The purpose of this discussion is to determine the validity of the alleged violation. This will also allow the Contractor a reasonable amount of time to correct or improve any of the provisions for the safety on this project. If the County Project Manager finds the problem still unresolved or uncorrected, they will notify the Contractor's Project Manager and the County's Risk Management Safety Analyst. If the County's Risk Management Safety Analyst finds that the job site contains any unresolved safety issues they will take appropriate action up to and including suspension of the Contractor's operations on all or part of the Work.

00180.85(b) Liquidated Damages - Add the following paragraph:

The liquidated damages for failure to complete the Work on time required by 00180.50(h) will be \$600 per Calendar Day *.

* Calendar Day amounts are applicable when the Contract time is expressed on the Calendar Day or fixed date basis.

Add the following subsection:

00180.85(c) Lane Closures and Road Closures - Lane closures and road closures beyond the limits specified will inconvenience the traveling public and will be a cost to the Agency.

(1) Lane Closures - It is impractical to determine the actual damages the Agency will sustain in the event traffic lanes are closed beyond the limits listed in 00220.40(e). Therefore, the Contractor shall pay to the Agency, not as a penalty, but as liquidated damages, \$500 per 15 minutes, or for a portion of 15 minutes, per lane, for any lane closure beyond the limits listed in 00220.40(e). In addition to the liquidated damages, all added cost for traffic control measures, including flagging, required to maintain the lane closures beyond the allowed time limits, will be at no additional cost to the Agency. The required traffic control measures will be as determined by the Engineer.

The Engineer will determine when it is safe to reopen lanes to traffic. Assessment of liquidated damages will stop when all lanes have been safely reopened. Any liquidated damages assessed under these provisions will be in addition to those listed in 00180.85(b).

END OF SECTION

SECTION 00190 – MEASUREMENT OF PAY QUANTITIES

Comply with Section 00190 of the Standard Specifications supplemented and/or modified as follows:

00190.20(g) Agency-Provided Weigh Technician: Delete and replace subsection (g) with the following:

The Contractor must provide a weigh technician. The Agency will not provide one for the Contractor.

END OF SECTION

SECTION 00195 – PAYMENT

Comply with Section 00195 of the Standard Specifications supplemented and/or modified as follows:

00195.10 Payment for Changes in Material Costs - Delete and replace with the following:

No asphalt cement cost adjustment shall be used on this project.

00195.12 Steel Material Price Escalation/De-Escalation Clause – Add the following sentence:

No steel material price escalation/de-escalations shall be used on this project. There is no option for Contractor participation.

00195.20(b) Significant Changed Work - Replace the paragraph that begins “Any such adjustments...” with the following paragraph:

Any adjustments may be less than, but will not be more than the amount justified by the Engineer on the basis of the established procedures set out in Section 00197 for determining rates. This does not limit the application of Section 00199.

Significant is defined as:

- a) An increase or decrease of more than 25 percent of the total cost of the Work calculated from the original proposal quantities and the unit contract prices; or,
- b) An increase or decrease of more than 25 percent in the quantity of any one major contract item.

For condition b) above, a major item is defined as any item that amounts to 10 percent or more of the original total contract price.

00195.50 Progress Payments and Retained Amounts - Modify as follows:

00195.50(a) Progress Payments - Modify as follows:

(1) Progress Estimates - Delete the first sentence and replace with the following:

At a regular period each month to be determined at the Preconstruction Conference, the Contractor will make an estimate of the amount and value of pay item work completed and in place. This estimate will be submitted to the Project Manager for review and approval.

(2) Value of Material on Hand - Delete the section and replace with the following:

(2) Value of Material on Hand - The Contractor will make an estimate of the amount and value of acceptable material to be incorporated in the completed work which has been delivered and stored as given in 00195.60(a) for review and approval.

(4) Limitations on Value of Work Accomplished - In the first sentence, change "Engineer's estimate" to "Contractor's reviewed estimate".

00195.50 (b) Retainage - Delete the first paragraph and replace with:

The amount to be retained from progress payments will be 5.0% of the value of payments made, and will be retained in one of the forms specified in Subsection (c) below. The County will withhold Retainage from all force account and change order work.

00195.50(c) Forms of Retainage – Delete first paragraph and replace with:

Forms of acceptable retainage are set forth below in Subsections (1) through (3). “Cash, Alternate A” or “Cash, Alternate B” (Retainage Surety Bond) are the Agency-preferred forms of retainage. Unless the Contractor notifies the County otherwise in writing, the County will automatically hold retainage per paragraph (2) “Cash, Alternate B (No Interest Earned). If the Agency incurs additional costs as a result of the Contractor’s election to use “Bonds and Securities”, the Agency may recover such costs from the Contractor by a reduction of the final payment.

Delete and replace paragraph (2) with the following:

(2) Cash, Alternate B (No Interest Earned) – Retainage will be deducted from progress payments and held by the Agency until final payment is made in accordance with 00195.90, unless otherwise specified in the Contract.

00195.50(d) Release of Retainage – Delete this section and replace with the following:

(d) Release of Retainage - As the Work progresses, release of the amounts to be retained under (b) of this Subsection will only be considered for Pay Items that have been satisfactorily completed. For purposes of this Subsection, a Pay Item will be considered satisfactorily completed only if all of the Work for the Pay Item is complete and all contractual requirements pertaining to the Pay Item and Work have been satisfied. Work not included in a Pay Item, or which constitutes part of an uncompleted Pay Item, will not be regarded as satisfactorily completed Work for the purposes of this Subsection.

When the Work is 50% completed and upon written application of the Contractor and written approval of the Surety, the Engineer or Project Manager may reduce or eliminate retainage on remaining progress payments if the Work is progressing satisfactorily.

A determination of satisfactory completion of Pay Items or Work or release of retainage shall not be construed as acceptance or approval of the Work and shall not relieve the Contractor of responsibility for defective Materials or workmanship or for latent defects and warranty obligations.

END OF SECTION

SECTION 00196 – PAYMENT FOR EXTRA WORK

Comply with Section 00196 of the Standard Specifications supplemented and/or modified as follows:

00196.91 Extra Work Allowance – Add the following new section:

The Bid schedule of prices contains a bid item for a pre-determined amount of Engineer ordered extra work. All Bidders shall reflect this same amount in their total Bid. No Bidder shall presume in the preparation of the bid or in the course of contract work that there will be a certain payment under that item or a certain order for extra work.

END OF SECTION

SECTION 00197 – PAYMENT FOR FORCE ACCOUNT WORK

Comply with Section 00197 of the Standard Specifications modified as follows:

00197.20(a) General - Replace the paragraph that begins "Except as modified by these..." with the following paragraph:

Except as modified by these provisions, Equipment use approved by the Engineer will be paid at the rental rates given in the most current edition of the Equipment Watch Cost Recovery (Blue Book) published by Equipment Watch, a division of Penton Business Media, Inc., and available from Equipment Watch (phone 1-800-669-3282) (<http://equipmentwatch.com>).

00197.20(c-3) Rate Adjustment Factor - Replace this subsection, except for the subsection number and title, with the following:

The rate adjustment factor used above will be determined by applying only the Model Year Adjustment to the Blue Book Rates. The Regional and User Defined Ownership/Operating Adjustments shall not apply.

00197.20(c-5) Limitations - Delete the paragraph that begins "The Blue Book..."

END OF SECTION

SECTION 00199 – DISAGREEMENTS, PROTESTS AND CLAIMS

Comply with Section 00199 of the Standard Specifications supplemented and/or modified as follows:

00199.40 Claim Decision; Review; Exhaustion of Administrative Remedies - Delete the entire section and replace with the following:

The Contractor must properly submit a claim as detailed in 00199.30.

(a) Engineer Claim Review - The Engineer or Project Manager will, as soon as practicable, consider and investigate a Contractor's properly submitted claim for additional compensation, Contract Time, or for a combination of additional compensation and Contract Time. Once the Engineer or Project Manager determines the Agency is in receipt of a properly submitted claim, the Engineer or Project Manager will arrange a meeting, within 28 Calendar Days, or as otherwise agreed by the parties, with the Contractor in order to present the claim for formal review and discussion. A person authorized by the Contractor to execute Change Orders on behalf of the Contractor must be present and attend all claim meetings.

If the Engineer or Project Manager determines that the Contractor must furnish additional information, records, or documentation to allow proper evaluation of the claim, the Engineer will schedule a second meeting, to be held within 14 calendar days, or as otherwise agreed by the parties, at which the Contractor shall present the requested information, records and documentation.

The Engineer or Project Manager will advise the Contractor of the decision to accept or reject the claim. If the Engineer or Project Manager finds the claim has merit, an equitable adjustment will be offered. If the Engineer or Project Manager finds the claim has no merit, no offer of adjustment will be made and the claim will be denied. The County intends to resolve claims at the lowest possible level.

If, at any step in the claim decision or review process, the Contractor fails to promptly submit requested information or documentation that the Agency deems necessary to analyze the claim, the Contractor is deemed to have waived its right to further review, and the claim will not be considered properly filed and preserved.

If the Engineer or Project Manager has denied a claim, in full or in part, for Contract Time only according to 00180.80, or has denied a claim, in full or in part, for correction of final compensation according to 00195.95, those disputed claims may then be resolved, in full or in part, at either of the two progressive steps of claim review procedure as specified in this Subsection. For all claims, all of the actions and review under each step of the review process shall occur before the review can be advanced to the next higher step.

(b) Director Claim Review - Upon request by the Contractor, the Department Director will review the Engineer or Project Manager's decision on the claim and advise the Contractor of the decision in writing. If the Director finds the claim has merit, and equitable adjustment will be offered. If the Director finds the claim has no merit, no offer of adjustment will be made and the claim will be denied.

Once the Engineer determines the Agency is in receipt of a properly submitted claim, the Engineer will arrange a meeting, within 21 Calendar Days or as otherwise agreed by the parties, with the Contractor in order to present the claim for formal review and discussion.

If the Engineer determines that the Contractor must furnish additional information, records or documentation to allow proper evaluation of the claim, the Engineer will schedule a second meeting, to be held within 14 Calendar Days or as otherwise agreed by the parties, at which the Contractor shall present the requested information, records and documentation.

The Director shall evaluate the claim based on the information provided by the Contractor to the Engineer or Project Manager. However, if the Department Director (or designee) determines that the Contractor must furnish additional information, records or documentation to allow proper evaluation of the claim, the Department Director (or designee) will schedule a meeting, to be held within 14 Calendar Days, or as otherwise agreed by the parties, at which the Contractor shall present the requested information, records and documentation.

The claim is subject to records review, if not all of the records requested by the Department Director (or designee) were furnished. If applicable, advancement of the claim is subject to the provisions regarding waiver and dismissal of the claim or portions of the claim.

The decision of the Department Director shall be the final decision of the Agency.

(c) Commencement of Litigation - If the Contractor does not accept the Director's decision, then the Contractor shall commence any suit or action to collect or enforce any claim filed in accordance with 00199.30 within a period of one (1) year following the mailing of the decision or within one (1) year following the date of "Second Notification", whichever is later. If said suit or action is not commenced in said one (1) year period, the Contractor expressly waives any **and** all claims for additional compensation and any and all causes of suit or action for the enforcement thereof that he might have had.

The Contractor must follow each step in order, and exhaust all available administrative remedies before resorting to litigation. Litigation of a claim that cannot be resolved through the process described above shall be initiated by filing a complaint in the Clackamas County Circuit Court for the State of Oregon.

In any litigation, the entire text of any order or permit issued by the County or any other governmental or regulatory authority, as well as any documents referenced or incorporated therein by reference, shall be admissible for purposes of Contract interpretation.

The Contract shall not be construed against either party regardless of which party drafted it. Other than as modified by the Contract, the applicable rules of contract construction and evidence shall apply. This Contract shall be governed by and construed according to the laws of the State of Oregon without regard to principles of conflict of laws.

The Contractor shall comply with 00170.00.

00199.50 Mediation - Delete the entire section.

00199.60 Review of Determination Regarding Records - Delete the entire section.

END OF SECTION

SECTION 00210 - MOBILIZATION

Comply with Section 00210 of the Standard Specifications.

SECTION 00220 - ACCOMMODATIONS FOR PUBLIC TRAFFIC

Comply with Section 00220 of the Standard Specifications modified as follows:

00220.02 Public Safety and Mobility - Add the following bullet to the end of the bullet list:

- When performing trench excavation or other excavation across or adjacent to a Traffic Lane on a roadway having a pre-construction posted speed greater than 35 mph, backfill the excavation, install surfacing, and open the roadway to traffic by the end of each work shift. Install a "BUMP" (W8-1-48) sign approximately 100 feet before the backfilled area and a "ROUGH ROAD" (W8-8-48) sign approximately 500 feet ahead of the "BUMP" sign. If this requirement is not met, maintain all necessary lane or shoulder closures and provide additional TCM, including flagging, at no additional cost to the Agency. Do not use temporary steel plating to reopen the roadway.

Add the following subsection:

00220.41 Bridge Work - Before starting any grading or pavement removal at bridge ends or removal of pavement from bridge decks, arrange so that all equipment, labor, and materials required to complete the pavement replacement work and bridge deck waterproofing work are on hand or are guaranteed to be delivered. Once grading and pavement removal begins, vigorously prosecute and complete this work. Complete paving and membrane waterproofing work in the shortest possible time.

Temporarily taper or bevel longitudinal and transverse grade changes or drop-offs resulting from grading and pavement removal and membrane waterproofing work with asphalt concrete mixture to provide a smooth and safe transition. Construct tapers according to 00620.40.

SECTION 00225 - WORK ZONE TRAFFIC CONTROL

Comply with Section 00225 of the Standard Specifications modified as follows:

00225.01(b) Definitions - Replace the "Traffic Control Plan" definition with the following definition:

Traffic Control Plan - A written and drawn plan used to describe traffic control measures for facilitating road users through or around a work zone area, while offering protection for workers and incident responders.

Add the following definition:

Protection Vehicle - A vehicle placed in advance of short-duration or mobile work activities for the protection of workers and equipment in the activity area. A protection vehicle is equipped with flashing warning lights, and vehicle-mounted warning signs or a changeable message sign. A protection vehicle may be fitted with a truck mounted impact attenuator.

00225.01(c) Standards - Replace the bullet list with the following bullet list:

- Oregon Department of Transportation's "Sign Policy and Guidelines for the State Highway System"
- The Manual on Uniform Traffic Control Devices (MUTCD)
- The latest versions of the 1990 Americans with Disabilities Act (ADA), and the Public Right of Way Accessibility Guidelines (PROWAG).
- FHWA "Standard Highway Signs" manual
- ODOT "Oregon Temporary Traffic Control Handbook for Operations of 3 Days or Less" when directed by the Engineer only for mobile pavement marking operations or surveying work, available on the ODOT Traffic Control Plans Unit Website
- ODOT "Oregon Portable Changeable Message Sign Handbook", available on the ODOT Traffic Control Plans Unit website
- ODOT "Traffic Control Plans Design Manual", available on the ODOT Traffic Control Plans Unit website.

00225.02 General Requirements - In the paragraph that begins "Work may be suspended...", replace the sentence that begins "Costs for work performed..." with the following sentence:

Costs for work performed by the Agency may be deducted from monies due the Contractor.

Replace the paragraph that begins, "Do not use an open traffic lane on a freeway..." with the following paragraph:

Do not use an open Traffic Lane on a freeway or multi-lane facility as an acceleration or deceleration lane for construction vehicles. Provide additional surfacing or width within the work area or, if allowed, extend the length of a closed Traffic Lane for construction vehicle acceleration or deceleration. Do not use a flagger to allow construction vehicles to access an open traffic lane on a freeway or a multi-lane facility.

Add the following to the end of this subsection:

Install a 54 inch "TRUCKS LEAVING HIGHWAY XXXX FT" sign in advance of each entrance point to the work area at sign spacing "A" from the "TCD Spacing Table" shown on the standard drawings. Install a 54 inch "TRUCKS ENTERING HIGHWAY XXXX FT"

sign in advance of each exit point from the work area at sign spacing "A" from the "TCD Spacing Table" shown on the standard drawings.

Install "ROAD WORK AHEAD" (W20-1-48) signs with "FINES DOUBLE" (R2-6-36) rider on SW Petes Mountain Road, according to the "TCD Spacing Table" shown on the standard drawings or as modified by the supplemental drawings except do not install the "FINES DOUBLE" rider on concrete barrier mounted signs.

Install beyond each end of the Project, facing outgoing traffic, an "END ROAD WORK" (CG20-2A-24) sign a distance of $(A \div 2)$ according to the "TCD Spacing Table" shown on the standard drawings or as modified by the supplemental drawings.

When the horizontal clearance for the roadway is less than 19 feet, install horizontal clearance (CW21-12-48) signs, identifying the narrowest width of the roadway. Locate these horizontal clearance signs as shown or as directed.

Install beyond each end of the Project, facing ingoing traffic, a "ROAD WORK ???DAY - ???DAY," 54 inch post mounted sign one week (7 calendar days) before beginning of onsite work.

00225.10 General - In the paragraph that begins "Evaluate the condition...", replace the first sentence with the following sentence:

Evaluate the condition of TCD using the criteria shown in the most current version in effect of the American Traffic Safety Services Association (ATSSA) publication titled "Quality Guidelines for Temporary Traffic Control Devices and Features", available from the ATSSA website at www.atssa.com.

00225.11(c-1) Temporary Signs - Replace the bullet that begins "Type 2 riprap geotextile..." with the following bullet:

- Geotextile fabric

00225.27(a) Flagger Equipment - Replace the bullet that begins "Portable, self-contained two-way..." with the following bullet:

- Portable, self-contained two-way radio and repeaters, as required, with a range suitable for communications throughout each work zone, unless otherwise directed.

00225.41(b-4) Temporary Sign Supports - Replace the bullet list with the following bullet list:

- When signs are needed at a single location for more than 48 consecutive hours.
- When not practicable to post mount due to location or when utility conflicts exists.
- Do not tip over any TSS that is exposed to traffic, unless approved by the Engineer or the TSS is protected from traffic by a barrier system.
- Position TSS as shown on the standard drawing or in the TCP.
- When not in use, locate TSS as far from public traffic as practicable and turn away from traffic, or cover the sign. Do not cover reflective sheeting on the TSS posts.

00225.41(c) Sign Flag Boards and Sign Flags - Replace this subsection, including subsections 00225.41(c-1) and 00225.41(c-2), with the following subsection:

00225.41(c) Sign Flag Boards - Install two sign flag boards, as shown or specified.

00225.41(e) Inconsistent Temporary Signs - Replace the paragraph that begins "Ensure that all temporary..." with the following paragraph:

Ensure that all temporary signs are properly used and consistent with the work zone. Cover all inconsistent temporary signing until the sign messages are applicable to the Work that is beginning. When signage is no longer required for staging or shift Work, remove all temporary signs, sign flag boards, supports, sign covers, and ballast associated with the staging or shift Work.

00225.43(e) Pavement Markers - Replace the paragraph that begins "Temporary pavement markers shall..." with the following paragraph:

Temporary pavement markers shall remain in place until the permanent markings are complete. Replace damaged or missing markers when directed by the Engineer. On the final pavement wearing course and along final alignment, place permanent markings a maximum of 28 Calendar Days after placing temporary pavement markers, or as directed.

00225.43(f) Temporary Tape - Replace the paragraph that begins "Replace damaged or missing..." with the following paragraph:

Replace damaged or missing tape. Remove temporary tape without damaging the roadway surface.

00225.43(g) Temporary Pavement Markings - Replace the paragraph that begins "Before opening roadways to traffic, unless..." with the following paragraph:

Before opening roadways to traffic, unless otherwise specified in 00225.43(h), apply temporary pavement markings on pavement base courses, wearing courses, and new bridge deck surfaces at locations shown, or as directed. Immediately remove all unacceptable pavement markings and replace with acceptable markings before opening roadways to traffic and at no additional cost to the Agency.

00225.62(b) Temporary Impact Attenuators - In the paragraph that begins "Complete repair of damaged..." replace the last sentence with the following sentence:

Complete repair of damaged narrow site systems within 6 hours of discovering or being notified of the damage.

In the paragraph that begins "When impact attenuator, truck mounted...", replace both occurrences of the word "on-site" with the words "on hand".

00225.63 Temporary Traffic Delineation - Replace this subsection, except for the subsection number and title, with the following:

Tualatin River (SW Petes Mountain Rd) Bridge Approach Repair Construction

Evaluate and maintain or immediately replace all unacceptable temporary tubular and conical markers, plastic drums, surface mounted tubular markers, and traffic delineators with acceptable materials.

Temporary pavement markings shall remain in place until the permanent markings are complete. Replace missing or damaged temporary markings when directed by the Engineer. On the final pavement wearing course and along final alignment, place permanent markings a maximum of 28 Calendar Days after placing temporary pavement markings, or as directed.

If permanent pavement markings are not placed within 28 Calendar Days after placing temporary pavement markings, missing or damaged temporary pavement markings on wearing course and along final alignment shall be replaced at no additional cost to the Agency, unless otherwise directed.

When removing damaged delineation from the pavement surface, remove adhesives, hardware, damaged delineation fragments or other materials using a method that will not damage the pavement surface. Repair any damaged surfaces to the Engineer's satisfaction at no additional cost to the Agency.

00225.82(e) Temporary Impact Attenuator Repair - Replace the bullet that begins "Sand barrel systems will..." with the following bullet:

- For sand barrel systems, each replacement of a damaged sand module (individual barrel) will be counted.

00225.83 Temporary Traffic Delineation - Add the following paragraph to the beginning of this subsection:

Measurement of temporary pavement markings (paint, temporary tape, pavement markers) will include missing or damaged temporary pavement markings replaced according to 00225.63 or as directed by the Engineer.

END OF SECTION

SECTION 00280 - EROSION AND SEDIMENT CONTROL

Comply with Section 00280 of the Standard Specifications modified as follows:

00280.00 Scope - Add the following paragraph to the end of this subsection:

The Agency's NPDES 1200-CA Permit is applicable to the Project.

00280.15(f) Compost Filter Sock - Replace this subsection, except for the subsection number and title, with the following:

Furnish filter sock material, compost, and stakes meeting the following requirements:

Filter Sock Material - 5 mil thick woven tubular mesh netting with 1/8 to 3/8 inch openings, and consisting of continuous HDPE filament or polypropylene material or 100 percent biodegradable mesh netting from the QPL. Furnish filter sock material with a diameter of 12 inches.

Compost - Commercially manufactured coarse compost material meeting the requirements of Section 03020.

Stakes - 2 inch by 2 inch (nominal) untreated wood stakes.

00280.16(d) Inlet Protection - Replace the "**Type 7:**" bullet and the two sub-bullets with the following bullet and sub-bullets:

- **Type 7:**
 - Filter sock material, compost, and stakes conforming to 00280.15(f).
 - Sand bags conforming to 00280.15(a).

00280.16(e) Sediment Barriers - Replace the "**Type 8:**" bullet and the two sub-bullets with the following bullet:

- **Type 8** - Filter sock material, compost, and stakes conforming to 00280.15(f).

00280.30 Erosion and Sediment Control Manager - Replace the paragraph that begins "Designate and provide an ESCM..." with the following paragraph:

If the Agency's NPDES 1200-CA Permit is applicable to the Project, designate and provide an ESCM that possesses a valid ODOT ESCM certificate or has successfully completed an erosion control training that is acceptable to the Engineer.

00280.90 Payment - Replace pay itemr with the following pay item(s):

(s) Sediment Barrier, Type 8 Foot

Add the following paragraph(s) after the paragraph that begins "Item (b) includes protecting...":

In item (s), the type will be inserted in the blank.

Add the following paragraph to the end of this subsection:

No separate or additional payment will be made for constructing laps, seams, joints, wraps, overlaps, joint overlaps, or patches unless the Engineer orders additional amounts in excess of the minimum. For laps, wraps, or overlaps that have been ordered by the Engineer and exceed the minimum or specified length or width, payment will be made for the added lap, overlap, or wrap length or width at the Contract unit price.

SECTION 00290 - ENVIRONMENTAL PROTECTION

Comply with Section 00290 of the Standard Specifications modified as follows:

00290.30(a) Pollution Control Measures - Add the following subsections and bullets:

(7) Water Quality:

- Do not discharge contaminated or sediment-laden water, including drilling fluids and waste, or water contained within a work area isolation, directly into any waters of the State or U.S. until it has been satisfactorily treated (for example: bioswale, filter, settlement pond, pumping to vegetated upland location, bio-bags, dirt-bags). Treatment shall meet the turbidity requirements below.
- .
- If monitoring or inspection shows that the erosion and sediment controls are ineffective, mobilize work crews immediately to make repairs, install replacements, or install additional controls as necessary.
- Implement containment measures adequate to prevent pollutants or construction and demolition materials, such as waste spoils, fuel or petroleum products, concrete cured less than 24 hours, concrete cure water, silt, welding slag and grindings, concrete saw cutting by-products and sandblasting abrasives, from entering waters of the state or U.S.
- The Project Manager retains the authority to temporarily halt or modify the Project in case of excessive turbidity or damage to natural resources.

00290.30(b) Pollution Control Plan - Replace the bullet that begins "Include the waste determination..." with the following bullet:

- Include the waste determination results from 00290.20(c-1). Provide reuse, recycle, and disposal options and the reasons for selecting those alternatives.

Add the following subsection:

SECTION 00310 - REMOVAL OF STRUCTURES AND OBSTRUCTIONS

Comply with Section 00310 of the Standard Specifications modified as follows:

00310.80 Measurement - Add the following to the end of the length and area bullet:

Asphalt pavement cutting will be the length of the actual cut based on a depth of 6 inches. If the depth is greater than 6 inches, the length will be adjusted by converting to an equivalent number of feet on a proportionate length basis.

00310.92 Separate Item Basis - Add the following pay item to the pay item list:

(g) Asphalt Pavement Saw Cutting Foot

Add the following paragraph to the end of this subsection:

Item (g) applies to asphalt pavement saw cutting when shown.

SECTION 00330 - EARTHWORK

Comply with Section 00330 of the Standard Specifications modified as follows:

00330.03 Basis of Performance - Add the following paragraph to the end of this subsection:

Perform all earthwork under this Section on the excavation basis.

00330.41(a-9) Excavation Below Grade - Delete subsection 00330.41(a-9-c).

00330.70 General - Replace the bullet that begins "Finish the subgrade to be..." with the following bullet:

- Finish the subgrade to be within a tolerance of plus or minus 0.06 foot from the established line, grade, and cross section and to be free of ruts, depressions and irregularities.

00330.91(d) General Excavation - Delete the bullet that begins "Includes unsuitable material...".

- Earthwork required for driveways and road approaches. Earthwork for driveways and road approaches will be that which is outside the neat line limits shown on the typical sections.

SECTION 00331 - SUBGRADE STABILIZATION

Comply with Section 00331 of the Standard Specifications.

SECTION 00334 - PREPARATION OF SHOULDERS

Section 00334, which is not a Standard Specification, is included in this Project by Special Provision.

Description

Tualatin River (SW Petes Mountain Rd) Bridge Approach Repair Construction

00334.00 Scope - This work consists of blading, leveling, and compacting shoulders as required to bring the shoulder subgrade to the required widths, grade, and condition to receive the pavement as shown.

Construction

00334.40 General - Haul offsite all material resulting from shoulder preparation.

Measurement

00334.80 Measurement - No measurement of quantities will be made for work performed under this Section.

It is estimated that 230 shoulder feet of shoulder preparation will be performed.

Payment

00334.90 Payment - The accepted quantities of shoulder preparation will be paid for at the Contract lump sum amount for the item "Preparation of Shoulders".

Payment will be payment in full for furnishing all equipment, labor, and incidentals necessary to complete the work as specified.

No separate or additional payment will be made for watering.

SECTION 00350 - GEOSYNTHETIC INSTALLATION

Comply with Section 00350 of the Standard Specifications modified as follows:

00350.10 Materials - Add the following to the end of this subsection:

Provide manufacturer's certifications complying with 02320.10(c) for the following geosynthetic(s):

Geotextile	Certification	
	Level A	Level B
Tensar, Type 2 or equivalent	X	

SECTION 00620 - COLD PLANE PAVEMENT REMOVAL

Comply with Section 00620 of the Standard Specifications modified as follows:

00620.40(a) General - Replace this subsection, except for the subsection number and title, with the following:

Remove the existing pavement to the depth, width, grade and cross section shown or as directed. The use of a heating device to soften the pavement is not allowed.

Remove existing pavement from bridge end panels according to Section 00503.

00620.43 Maintenance Under Traffic - Replace this subsection, except for the subsection number and title, with the following:

Traffic is not allowed on the cold planed surface. Before opening the area to traffic, pave the surface according to 00744.51.

SECTION 00640 - AGGREGATE BASE AND SHOULDERS

Comply with Section 00640 of the Standard Specifications modified as follows:

00640.44 Surface Tolerance - Replace the paragraph that begins "The finished surface and the surface of each underlying..." with the following paragraph:

The finished surface and the surface of each underlying layer of the aggregate shall parallel the established grade and cross section for the finished surface within 0.04 foot.

SECTION 00730 - EMULSIFIED ASPHALT TACK COAT

Comply with Section 00730 of the Standard Specifications modified as follows:

00730.90 Payment - Replace this subsection, except for the subsection number and title, with the following:

No separate or additional payment will be made for emulsified asphalt tack coat. Approximately 0.70 tons of emulsified asphalt in tack coat will be required on this Project.

SECTION 00744 - ASPHALT CONCRETE PAVEMENT

Comply with Section 00744 of the Standard Specifications modified as follows:

00744.11(a) Asphalt Cement - Add the following to the end of this subsection:

Provide PG64-22 grade asphalt cement for this Project.

Add the following subsection:

00744.51 Opening Sections to Traffic - Schedule work so that, during the same shift, the surfaces being paved are paved full width and length through the wearing course before opening to traffic.

SECTION 00759 - MISCELLANEOUS PORTLAND CEMENT CONCRETE STRUCTURES

Comply with Section 00759 of the Standard Specifications modified as follows:

00759.00 Scope - Add the following to the end of this subsection:

This work consists of removing existing concrete sidewalks, curbs, and sidewalk ramps, and constructing new portland cement concrete sidewalk ramps with curbs.

Add the following subsections:

00759.02 Required Submittals - Before the preplacement conference, submit the following:

(a) **Working Drawings** - Before the preplacement conference, submit six copies of unstamped working drawings according to 00150.35 for all sidewalk ramp work. Include field verification of each ramp location, and all dimensions and grades necessary to demonstrate compliance with the Standard Drawings and Plans. Notify the Engineer of any deficiencies or non-compliance with the Standard Drawings or Plans. The Engineer will provide additional or modified Plans as needed.

(b) **Sidewalk Ramp Plan** - At least 21 Calendar Days before the sidewalk ramp work is scheduled to begin, submit a plan for accomplishing all phases of the sidewalk ramp work, including the following:

- Surface preparation
- Compliance with working drawings and details submitted under 00759.02
- Compliance with current Standard Drawings and Plans
- Waste handling and disposal
- All other pertinent information

Do not begin any sidewalk ramp work before the plan for completing the work has been approved.

Material ordered or work done before the Engineer reviews and returns the documents will be at the Contractor's risk.

Add the following subsection:

00759.03 Preplacement Conference - Before beginning any sidewalk ramp work, meet with the Contractor's supervisory personnel and quality control manager, any sidewalk ramp subcontractors' supervisory personnel, and the Engineer at a mutually agreed upon time.

If the Contractor's personnel change, or if the Contractor proposes a significant revision to the plan for accomplishing the sidewalk ramp work, the Engineer may require additional preplacement conferences.

Add the following subsection:

00759.22 Smart Level - Slopes will be verified with the use of a 24-inch SmartTool level model 92379 or model 92500, and a 6-inch SmartTool level model 92346. The 6-inch level will only be used to measure counter slope when there is a concrete gutter. All other locations will use a 24-inch level to measure slopes.

00759.46 Concrete - Add the following sentence after the first sentence:

Tualatin River (SW Petes Mountain Rd) Bridge Approach Repair Construction

Before placing concrete, verify that forms are correctly positioned to produce sidewalk ramps with proper slopes and dimensions to comply with the Standard Drawings and Plans.

00759.50(c) Driveways, Walks, and Surfacing - Add the following paragraph to the end of this subsection:

In addition, finish concrete surfaces of sidewalk ramps to be within the established slopes and dimensions allowed by the Standard Drawings and Plans. Repair or remove and replace sidewalk ramps not meeting the Standard Drawings and Plans at no additional cost to the Agency.

00759.80 Measurement - Add the following sentence(s) to the bullet that begins "Area Basis - Measurement...":

Measurement of concrete walks will include the total area of concrete walk, including the area of new concrete sidewalk ramps within the footprint of the concrete walk.

00759.90 Payment - Add the following pay items:

Pay Item	Unit of Measurement
(n) <i>Extra for New Sidewalk Ramps Each</i>	
(o) <i>Truncated Domes on New Surfaces</i>	<i>Each</i>

Replace the paragraph that begins "Items (e) and (f) include..." with the following paragraph:

Items (e) and (f) include the area of new concrete sidewalk ramps within the footprint of the Concrete Walks or Monolithic Curb and Sidewalks.

Add the following paragraph(s) after the paragraph that begins "In item (k)...":

Item (n) includes the additional work required to construct a new sidewalk ramp in a new concrete sidewalk or monolithic curb and sidewalk. Payment for the area of the new sidewalk ramp will be made under the concrete walk or sidewalk pay item.

Item (o) includes installation of truncated domes on a new concrete or asphalt surface.

Add the following paragraph to the end of this subsection:

No separate or additional payment will be made for Sidewalk Ramp Working Drawings, Sidewalk Ramp Plan, Preplacement Conference, concrete form verification, and any necessary repair or removal and replacement of Sidewalk Ramps.

SECTION 00850 - COMMON PROVISIONS FOR PAVEMENT MARKINGS

Comply with Section 00850 of the Standard Specifications.

SECTION 00855 - PAVEMENT MARKERS

Comply with Section 00855 of the Standard Specifications.

SECTION 00865 - LONGITUDINAL PAVEMENT MARKINGS - DURABLE

Comply with Section 00865 of the Standard Specifications modified as follows:

00865.45 Installation -

Replace the bullet that begins "**Method A: Extruded Markings...**" and the two sub-bullets with the following bullets:

- **Method A: Extruded Markings** - Apply markings with an extrusion or ribbon type process and according to the following:
 - For grooved markings, grind the slot depth as shown. Apply the specified marking material centered in the slot as shown. The top of the marking shall be flat or slightly convex.
 - For profiled markings, place lines and bumps straight and square.

Add the following paragraph to the end of the bullet that begins "**Method B: Spray Markings...**":

Thermoplastic spray markings may be installed in one application at the total specified thickness if approved by the Engineer and after a successful performance test according to 00865.40. Apply spray markings in two applications if installing yellow colored markings over rumble strips.

SECTION 02010 - PORTLAND CEMENT

Comply with Section 02010 of the Standard Specifications modified as follows:

02010.10(b) Specifications - Replace this subsection, except the subsection number and title, with the following:

Portland cement shall conform to the requirements of AASHTO M 85 or ASTM C150 for low alkali cement except as follows:

- Cement shall have a total alkali content (sodium and potassium oxide calculated as $\text{Na}_2\text{O} + 0.658 \text{ K}_2\text{O}$) not exceeding 0.60 percent.
- All cement types shall contain a maximum of 8 percent tricalcium aluminate (C_3A).
- The time-of-setting tests will be by either the Gillmore test or the Vicat test.
- Types I and II maximum fineness (specific surface) as determined by AASHTO T153 air permeability test shall be 430 m^2/kg . If $\text{C}_3\text{S} + 4.75 \text{ C}_3\text{A}$ is less than or equal to 90, the fineness criteria does not apply.

02010.20 Blended Hydraulic Cement - Replace this subsection, except for the subsection number and title, with the following:

Blended hydraulic cement shall be either Type IS-portland blast-furnace slag cement, Type IP-portland-pozzolan cement, Type IL-portland-limestone cement, or Type IT-ternary blended cement according to AASHTO M 240.

Furnish blended hydraulic cement from the QPL.

SECTION 02050 - CURING MATERIALS

Comply with Section 02050 of the Standard Specifications modified as follows:

02050.00 Scope - Replace this subsection, except for the subsection number and title, with the following:

This Section includes the requirements for liquid compounds, polyethylene films, and curing blankets used to cover concrete and other surfaces to retain moisture and to cure.

02050.10 Liquid Compounds - Replace this subsection, except for the subsection number and title, with the following:

Furnish liquid membrane-forming curing compounds from the QPL and meeting the requirements of ASTM C309, except that testing will be done according to ODOT TM 721.

All compounds shall be Type 1-D or Type 2, Class A or B.

Only Type 2, Class B resins will be allowed for the following concrete pavement applications:

- Plain concrete pavement repair.
- Continuously reinforced concrete pavement.
- Plain concrete pavement.
- Reinforced concrete pavement repair.

Before using liquid compounds, submit one quart samples of each lot for testing, except samples are not required for commercial grade concrete.

02050.40 Liquid Evaporation Reducer Compounds - Delete this subsection.

SECTION 02320 - GEOSYNTHETICS

Comply with Section 02320 of the Standard Specifications modified as follows:

02320.20 Geotextile Property Values - Replace Table 02320-1 through Table 02320-6 with the following tables:

Tualatin River (SW Petes Mountain Rd) Bridge Approach Repair Construction

Table 02320-1 Geotextile Property Values for Drainage Geotextile ^{1, 2}

Geotextile Property	ASTM Test Method	Units	Geotextile Property Requirements			
			Type 1		Type 2	
			Woven	Nonwoven	Woven	Nonwoven
Grab Tensile Strength (minimum) Machine and Cross Machine Directions	D 4632	lb	180	115	250	160
Grab Failure Strain (minimum) Machine and Cross Machine Directions	D 4632	%	< 50	≥ 50	< 50	≥ 50
Tear Strength (minimum)	D 4533	lb	67	40	90	56
Puncture Strength (minimum)	D 6241	lb	370	220	495	310
Apparent Opening Size (AOS) (maximum) U.S. Standard Sieve	D 4751	—	40	40	40	40
Permittivity (minimum)	D 4491	sec ⁻¹	0.5	0.5	0.5	0.5
Ultraviolet Stability Retained Strength (minimum)	D 4355 (at 500 hours)	%	50	50	50	50
¹ All geotextile properties are Minimum Average Roll Values (MARV). The test results for any sampled roll in a lot shall meet or exceed the values shown in the table. ² Woven slit film geotextiles (geotextiles that are made from yarns of a flat, tape-like character) are not acceptable.						

Table 02320-2 Geotextile Property Values for Riprap Geotextile ^{1, 2}

Geotextile Property	ASTM Test Method	Units	Geotextile Property Requirements			
			Type 1		Type 2	
			Woven	Nonwoven	Woven	Nonwoven
Grab Tensile Strength (minimum) Machine and Cross Machine Directions	D 4632	lb	250	160	315	200
Grab Failure Strain (minimum) Machine and Cross Machine Directions	D 4632	%	< 50	≥ 50	< 50	≥ 50
Tear Strength (minimum)	D 4533	lb	90	56	110	80
Puncture Strength (minimum)	D 6241	lb	495	310	620	430
Apparent Opening Size (AOS) (maximum) U.S. Standard Sieve	D 4751	—	40	40	40	40
Permittivity (minimum)	D 4491	sec ⁻¹	0.5	0.5	0.5	0.5
Ultraviolet Stability Retained Strength (minimum)	D 4355 (at 500 hours)	%	70	70	70	70
¹ All geotextile properties are Minimum Average Roll Values (MARV). The test results for any sampled roll in a lot shall meet or exceed the values shown in the table. ² Woven slit film geotextiles (geotextiles that are made from yarns of a flat, tape-like character) are not acceptable.						

Tualatin River (SW Petes Mountain Rd) Bridge Approach Repair Construction

Table 02320-3 Geotextile Property Values for Sediment Fence ¹

Geotextile Property	ASTM Test Method	Units	Geotextile Property Requirements		
			Supported	Unsupported	
			—	Elongation ² ≥ 50%	Elongation ² ≤ 50%
Grab Tensile Strength (minimum) Machine and Cross Machine Directions	D 4632	lb	90 90	120 100	120 100
Apparent Opening Size (AOS) (maximum) U.S. Standard Sieve	D 4751	—	30	30	30
Permittivity (minimum)	D 4491	sec ⁻¹	0.05	0.05	0.05
Ultraviolet Stability Retained Strength (minimum)	D 4355 (at 500 hours)	%	70	70	70
¹ All geotextile properties are Minimum Average Roll Values (MARV). The test results for any sampled roll in a lot shall meet or exceed the values shown in the table.					
² Measured according to ASTM D 4632.					

Table 02320-4 Geotextile Property Values for Subgrade Geotextile (Separation) ¹

Geotextile Property	ASTM Test Method	Units	Geotextile Property Requirements	
			Woven	Nonwoven
Grab Tensile Strength (minimum) Machine and Cross Machine Directions	D 4632	lb	180	113
Grab Failure Strain (minimum) Machine and Cross Machine Directions	D 4632	%	< 50	≥ 50
Tear Strength (minimum)	D 4533	lb	68	41
Puncture Strength (minimum)	D 6241	lb	371	223
Apparent Opening Size (AOS) (maximum) U.S. Standard Sieve	D 4751	—	30	30
Permittivity (minimum)	D 4491	sec ⁻¹	0.05	0.05
Ultraviolet Stability Retained Strength (minimum)	D 4355 (at 500 hours)	%	50	50
¹ All geotextile properties are Minimum Average Roll Values (MARV). The test results for any sampled roll in a lot shall meet or exceed the values shown in the table.				

Table 02320-5 Geotextile Property Values for Embankment Geotextile ¹

Geotextile Property	ASTM Test Method	Units	Geotextile Property Requirements	
			Woven	Nonwoven
Grab Tensile Strength (minimum) Machine and Cross Machine Directions	D 4632	lb	315	200
Grab Failure Strain (minimum) Machine and Cross Machine Directions	D 4632	%	< 50	≥ 50
Tear Strength (minimum)	D 4533	lb	110	80
Puncture Strength (minimum)	D 6241	lb	620	430
Apparent Opening Size (AOS) (maximum) U.S. Standard Sieve	D 4751	—	30	30
Permittivity (minimum)	D 4491	sec ⁻¹	0.02	0.02
Ultraviolet Stability Retained Strength (minimum)	D 4355 (at 500 hours)	%	50	50
¹ All geotextile properties are Minimum Average Roll Values (MARV). The test results for any sampled roll in a lot shall meet or exceed the values shown in the table.				

Table 02320-6 Geotextile Property Values for Pavement Overlay Geotextile ¹

Geotextile Property	ASTM Test Method	Units	Geotextile Property Requirements
			Nonwoven
Grab Tensile Strength (minimum) Machine and Cross Machine Directions	D 4632	lb	100
Grab Failure Strain (minimum) Machine and Cross Machine Directions	D 4632	%	≥ 50
Asphalt Retention (minimum)	D 6140	oz./sq.ft.	2.8
Melting Point (minimum)	D 276	°F	300
¹ All geotextile properties are Minimum Average Roll Values (MARV). The test results for any sampled roll in a lot shall meet or exceed the values shown in the table.			

SECTION 02510 - REINFORCEMENT

Comply with Section 02510 of the Standard Specifications modified as follows:

02510.40 Welded Wire Reinforcement - Replace this subsection, except for the subsection number and title, with the following:

Welded wire reinforcement and deformed welded wire reinforcement shall conform to the requirements of ASTM A1064.

02510.60 Wire Reinforcement - Replace this subsection, except for the subsection number and title, with the following:

Wire reinforcement and deformed wire reinforcement shall conform to the requirements of ASTM A1064.

SECTION 02910 - SIGN MATERIALS

Comply with Section 02910 of the Standard Specifications modified as follows:

02910.02 Types of Signs - Replace this subsection, except for the subsection number and title, with the following:

Traffic signs are classified by sign type as follows:

- "B"** Blue Type III or Type IV sheeting background with silver-white Type III or Type IV permanent or removable legend, or silver-white Type III or Type IV sheeting overlaid with blue electronically cuttable film background with legend cut out.
- "B2"** Blue Type III or Type IV sheeting background with white Type IX removable legend.
- "B3"** White Type IX sheeting overlaid with blue electronically cuttable film background with legend cut out.
- "B4"** Blue Type III or Type IV sheeting background with yellow Type III or Type IV permanent legend, or yellow Type III or Type IV sheeting overlaid with blue electronically cuttable film with legend cut out or blue transparent paste background with retroreflective yellow screened legend or yellow Type III or Type IV permanent legend (County Route Shield).
- "C"** Brown Type III or Type IV sheeting background with silver-white Type III or Type IV permanent or removable legend, or silver-white Type III or Type IV sheeting overlaid with brown electronically cuttable film background with legend cut out.
- "C1"** Brown Type III or Type IV sheeting background with white Type IX removable legend.
- "C2"** White Type IX sheeting overlaid with brown electronically cuttable film background with legend cut out.
- "F"** Silver-white Type III or Type IV sheeting background overlaid with red and blue electronically cuttable film with legend cut out or red and blue transparent paste background with retroreflective silver-white screened legend or silver-white Type III or Type IV permanent legend.
- "F1"** White Type IX sheeting background overlaid with red and blue electronically cuttable film with legend cut out or red and blue transparent paste background with white Type IX permanent legend.

Tualatin River (SW Petes Mountain Rd) Bridge Approach Repair Construction

- "G"** Green Type III or Type IV sheeting background with silver-white Type III or Type IV permanent or removable legend, or silver-white Type III or Type IV sheeting overlaid with green electronically cuttable film background with legend cut out.
- "G1"** Green Type III or Type IV sheeting background with white Type IX removable legend.
- "G2"** White Type IX sheeting overlaid with green electronically cuttable film background with legend cut out.
- "G5"** Green Type III or Type IV sheeting background with white Type IX permanent legend and symbol, or white Type IX sheeting overlaid with green electronically cuttable film background with legend cut out and white Type IX symbol (Combination Lane-use / Destination Overhead Guide Sign).
- "OO"** Orange Type III or Type IV sheeting background with black nonreflective permanent or removable legend.
- "O3"** Fluorescent orange Type VIII or Type IX sheeting background with black nonreflective permanent legend and red retroreflective symbol (Stop or Yield Ahead Symbol Sign).
- "O4"** Fluorescent orange Type VIII or Type IX sheeting background with black nonreflective permanent legend.
- "O5"** Fluorescent orange Type VIII or Type IX sheeting background with black nonreflective removable legend.
- "O6"** Fluorescent orange Type VIII or Type IX sheeting background with black nonreflective permanent legend and red, yellow, and green Type VIII and Type IX circles. (Signal Ahead Symbol Sign)
- "O8"** Fluorescent orange Type VIII or Type IX sheeting background with black nonreflective screened or cut-out permanent legend and silver-white Type VIII or Type IX symbol. (Speed Reduction Symbol Sign)
- "R"** Silver-white Type III or Type IV sheeting background overlaid with red transparent paste background with silver-white Type III or Type IV permanent legend or red electronically cuttable film with legend cut out. (Stop Sign, Wrong Way, Do Not Enter.)
- "R1"** White Type IX sheeting background overlaid with red transparent paste background with white Type IX permanent legend or red electronically cuttable film with legend cut out.
- "R2"** Silver-white Type III or Type IV sheeting background overlaid with red electronically cuttable film with legend and triangle cut out or screened red transparent paste triangle and legend or red Type III or Type IV triangle and permanent legend. (Yield Sign)

Tualatin River (SW Petes Mountain Rd) Bridge Approach Repair Construction

- "R3"** White Type IX sheeting background overlaid with red electronically cuttable film with legend and triangle cut out or screened red transparent paste triangle and permanent legend.
- "R4"** Rubber STOP flap made of natural rubber with a red background and white lettering.
- "R5"** Red Type III or Type IV sheeting background overlaid with black nonreflective screened or cut-out permanent legend (OM4-2 Object Marker).
- "W1"** Silver-white Type III or Type IV sheeting background with black nonreflective screened, cut out permanent or removable legend.
- "W2"** Silver-white Type III or Type IV sheeting background with a screened black nonreflective legend overlaid with a screened red transparent paste circle and continuous diagonal bar. (Prohibition)
- "W3"** Silver-white Type III or Type IV sheeting background with transparent brown screened legend or brown Type III or Type IV cut-out permanent legend.
- "W4"** Silver-white Type III or Type IV sheeting background with transparent red screened legend or red Type III or Type IV cut-out permanent legend.
- "W5"** Silver-white Type III or Type IV sheeting background with transparent green screened legend or green Type III or Type IV cut-out permanent legend.
- "W6"** White Type IX sheeting background with a screened or cut-out black nonreflective legend overlaid with a screened red transparent paste circle and continuous diagonal bar. (Prohibition sign overhead)
- "W7"** White Type IX sheeting background with black nonreflective screened or cut-out permanent legend.
- "W8"** Silver-white Type III or Type IV sheeting background with blue transparent screened legend or blue Type III or Type IV cut-out permanent legend.
- "W9"** Silver-white Type III or Type IV sheeting background with blue nonreflective screened or cut-out permanent legend.
- "W10"** White Type IX sheeting background with black nonreflective removable legend.
- "W11"** Silver-white Type III or Type IV sheeting background with black nonreflective screened or cut out permanent legend with red Type III or Type IV symbol.
- "W12"** Silver white Type III or Type IV sheeting background with transparent green screened legend or green Type III or Type IV cut out permanent legend with blue Type III or Type IV symbol.

Tualatin River (SW Petes Mountain Rd) Bridge Approach Repair Construction

- "W13"** Silver white Type III or Type IV sheeting background with red Type III or Type IV screened or cut-out permanent legend and black nonreflective screened or cut-out permanent legend overlaid with a red transparent paste circle and continuous diagonal bar (Parking Prohibition Symbol Signs).
- "W14"** Silver white Type III or Type IV sheeting background with black nonreflective screened or cut-out permanent legend overlaid with a green transparent paste circle (Permissive Trucks and Hazardous Material Symbol Signs).
- "W15"** Silver white Type III or Type IV sheeting background with green Type III or Type IV screened or cut-out permanent legend and black nonreflective screened or cut-out permanent legend overlaid with a green transparent paste circle (Permissive Parking Symbol Signs).
- "W16"** Agency supplied silver-white Type III or Type IV sheeting decal, with multi-colored Oregon State Parks logo, direct applied to sheet aluminum or HDO plywood substrate (Oregon State Parks shield).
- "W17"** Silver-white Type III or Type IV sheeting background overlaid with brown transparent paste or electronically cuttable film background, and silver-white Type III or Type IV sheeting background with yellow transparent paste or electronically cuttable film background and black non-reflective screened or cut-out permanent legend and logo (Oregon Trail or California Trail Route Markers). Digital files of the logo graphics may be available on the ODOT Sign Design Information website at:
<http://www.oregon.gov/ODOT/HWY/TS/Pages/signing.aspx>
- "W18"** Silver-white Type III or Type IV sheeting background overlaid with blue transparent paste background with retroreflective silver-white screened legend or blue electronically cuttable film with legend cut out, and silver-white Type III or Type IV sheeting background with black non-reflective screened or cut-out permanent legend and multi-colored Scenic Byway logo Oregon Scenic Byway Signs). Digital files of the logo graphics may be available on the ODOT Sign Design Information website at:
<http://www.oregon.gov/ODOT/HWY/TS/Pages/signing.aspx>
- "W19"** Silver-white Type III or Type IV sheeting background with plum transparent screened legend or plum Type III or Type IV cut-out permanent legend and multi-colored Tour Route logo (Oregon Tour Route Signs). Digital files of the logo graphics may be available on the ODOT Sign Design Information website at:
<http://www.oregon.gov/ODOT/HWY/TS/Pages/signing.aspx>
- "Y1"** Yellow Type III or Type IV sheeting background with black nonreflective screened, cut out permanent or removable legend.
- "Y2"** Yellow Type III or Type IV sheeting background with a screened or cut-out black nonreflective legend and red and green Type III or Type IV circles. The center yellow circle part shall be part of the background sheeting. (Signal Ahead Symbol Sign)

Tualatin River (SW Petes Mountain Rd) Bridge Approach Repair Construction

- "Y3"** Yellow Type IX sheeting background with black nonreflective screened, cut-out permanent or removable legend.
- "Y4"** Yellow Type III or Type IV sheeting background with black nonreflective screened or cut out permanent legend and red Type III or Type IV symbol. (Stop or Yield Ahead Symbol Sign)
- "Y5"** Fluorescent yellow Type IX sheeting background with black nonreflective screened, cut out permanent or removable legend.
- "Y6"** Fluorescent yellow Type IX sheeting background with black nonreflective screened or cut out permanent legend and red and green Type IX circles. The center yellow circle shall be part of the background sheeting. (Signal Ahead Symbol Sign overhead)
- "Y7"** Fluorescent yellow Type IX sheeting background with black nonreflective screened or cut out permanent legend and red Type IX symbol. (Stop or Yield Ahead Symbol Sign)
- "Y8"** Yellow Type III or Type IV sheeting background with black nonreflective screened or cut out permanent legend and silver-white Type III or Type IV symbol. (Speed Reduction Symbol Sign)
- "YG"** Fluorescent yellow-green Type IX sheeting background with black non-reflective legend or cut out permanent legend.
- "YG1"** Fluorescent yellow-green Type IX sheeting background with black nonreflective screened or cut out permanent legend and red Type IX symbols (School Bus Stop Ahead Symbol Sign).
- "YG2"** Fluorescent yellow-green Type IX sheeting background with black nonreflective screened or cut out permanent legend and fluorescent yellow-green and white Type IX symbol (Reduced School Speed Limit Ahead Symbol Sign).
- "YGW"** Fluorescent yellow-green Type IX sheeting background with black nonreflective screened or cut out permanent legend and silver-white Type III or Type IV sheeting background with black nonreflective screened or cut-out permanent legend and red Type III or Type IV symbol. (In Street Pedestrian Crossing Symbol Sign).
- "YGW1"** Fluorescent yellow-green Type IX sheeting background with black nonreflective screened or cut-out permanent legend, and silver-white Type III or Type IV sheeting background with black nonreflective screened or cut-out permanent legend (School / Speed Limit 20 Combination Sign).
- "YW"** Yellow Type III or Type IV sheeting background with black nonreflective screened or cut-out permanent legend, and white Type III or Type IV sheeting background with black nonreflective screened or cut-out permanent legend and red Type III or Type IV symbol.

Tualatin River (SW Petes Mountain Rd) Bridge Approach Repair Construction

"YW1" Yellow Type III or Type IV sheeting background with black nonreflective screened or cut-out permanent legend, and white Type III or Type IV sheeting background with black nonreflective screened or cut-out permanent legend.

"YW2" Yellow Type IX sheeting background with black nonreflective screened or cut-out permanent legend, and white Type IX sheeting background with black nonreflective screened or cut-out permanent legend and red Type IX symbol.

02910.33(d) Nonreflective Black Screened Legend - Replace this subsection, except for the subsection number and title, with the following:

Furnish material for nonreflective black screened legends that is compatible with the sign sheeting, as recommended by the sign sheeting manufacturer.

CLACKAMAS COUNTY
DEPARTMENT OF TRANSPORTATION AND DEVELOPMENT

Tualatin River (SW Petes Mountain Rd) Bridge
Approach Repair Project

PAVING AND STRIPING
CLACKAMAS COUNTY OREGON
SUMMER 2018

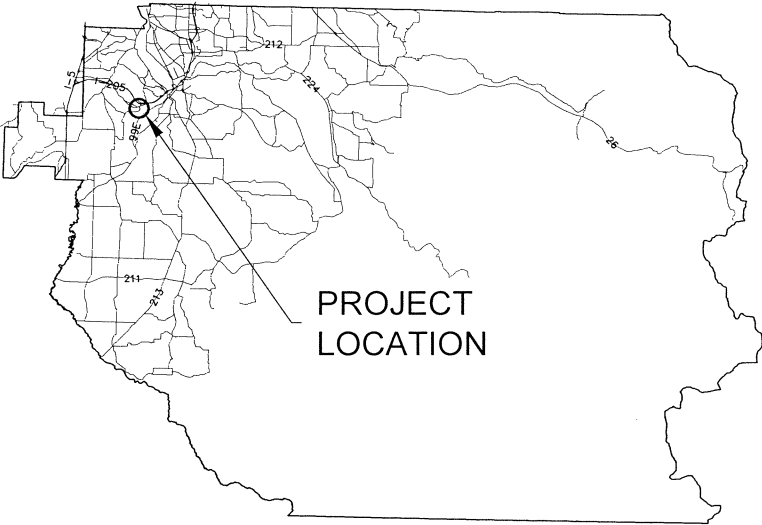

ATTENTION :
Oregon Law Requires You To Follow Rules
Adopted By The Oregon Utility Notification Center.
Those Rules Are Set Forth In OAR 952-001-0010 Through
OAR 952-001-0090. You May Obtain Copies Of The Rules From The Center.



T. 3S, R. 1E SEC. 01



INDEX OF SHEETS	
1	TITLE SHEET
1A	LEGEND
2A	TYPICAL SECTIONS
2B THRU 2B-4	CONSTRUCTION DETAILS
3 & 4	ALIGNMENT & GENERAL CONSTRUCTION
SS-1	PERMANENT STRIPING PLAN
SS-2 THRU SS-5	PERMANENT STRIPING DETAILS

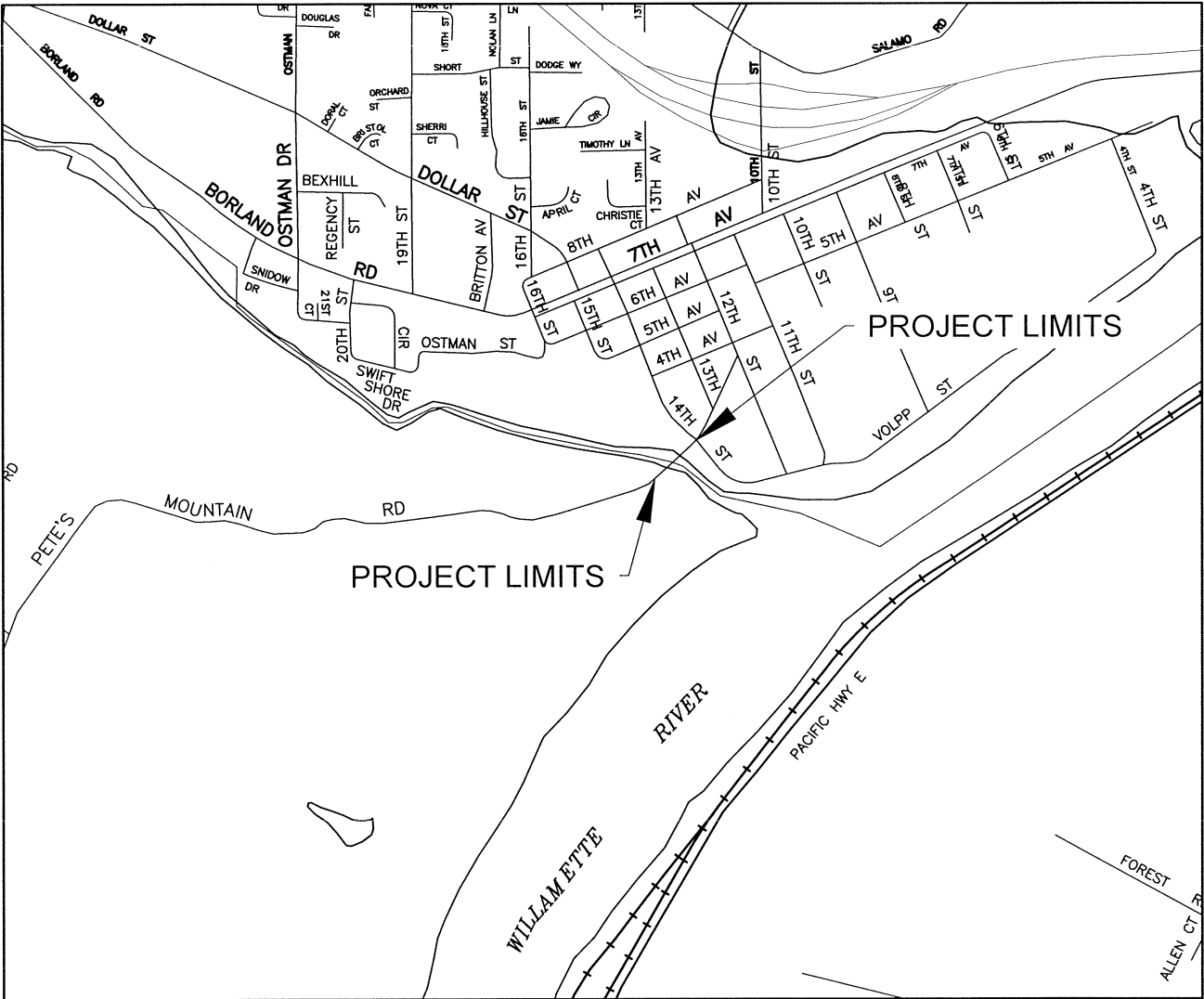

VICINITY MAP
NOT TO SCALE

TITLE SHEET

TUALATIN RIVER (SW PETES MOUNTAIN RD)
BRIDGE APPROACH REPAIR PROJECT

DATE: APRIL 2018

PROJECT NO.: CI-22259

CLACKAMAS COUNTY

DEPT. OF TRANSPORTATION
AND DEVELOPMENT
150 BEAVERCREEK ROAD
OREGON CITY, OR 97045

DIRECTOR
DAN JOHNSON

DESIGNED BY:
JH

DRAFTED BY:
JH

CHECKED BY:
DTD

REVISIONS

NO. DATE:

Sheet No. 1

EXISTING

PROPOSED

MAIL BOX

TELEPHONE RISER

TELEPHONE MANHOLE

UNIDENTIFIED UTILITY VAULT

TELEPHONE VAULT

POWER VAULT

UTILITY POLE, GUY ANCHOR

GB 2/GB-1 CATCH BASIN/CURB INLET

DRAINAGE MANHOLE

SANITARY MANHOLE

GAS METER

GAS VALVE

FIRE HYDRANT

WATER METER

WATER VALVE

DETECTOR LOOP

JUNCTION BOX

SIGNAL CONTROLLER

SIGNAL HEAD

VIDEO DETECTION

SIGNAL POLE BASE

STREET LITE 2

STREET LITE 1

PUSHBUTTON PED POLE

SINGLE SUPPORT SIGN

RAILROAD CROSSING SIGNAL

RAILROAD SIGNAL CONTROLLER

RAILROAD CROSSING GATE

AUDIBLE WARNING (CURB RAMP)

CONCRETE SURFACE

EDGE OF UNPAVED SURFACE

EDGE OF PAVED SURFACE

FENCE LINE

GUARDRAIL

EASEMENT LINE

CENTERLINE

ROAD RIGHT OF WAY

CITY BOUNDARY

COUNTY BOUNDARY

DLC BOUNDARY WIDTH

STORM PIPE

DITCH LINE

PUBLIC WATER LINE

SANITARY SEWER LINE

FIBER OPTIC LINE

UNDERGROUND TELEPHONE LINE

UNDERGROUND POWER LINE

CABLE TELEVISION LINE

GAS LINE

HIGH PRESSURE GAS

SIGNAL CONDUIT

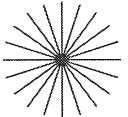
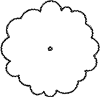
	PLANT/BUSH
	EVERGREEN TREE
	DECIDUOUS TREE

SYMBOLS

LINETYPES

ABBREVIATIONS

CB	CATCH BASIN (INLET)	EMB	EMBANKMENT	MIN	MINIMUM	Sq Ft	SQUARE FEET
C/L	CENTERLINE	EQUA	EQUATION	NE	NORTHEAST	STD	STANDARD
CTR	CENTER	EXC	EXCAVATION	NW	NORTHWEST	STA	STATION
COMP	COMPACTED	EXTG	EXISTING	No.	NUMBER	STL	STEEL
CONC	CONCRETE	FH	FIRE HYDRANT	OBL	OBLITERATE	ST	STREET
CONST	CONSTRUCT	FL	FLOW LINE	OH/P/T/C	OVERHEAD///UTILITIES	STRM	STORM
CONT	CONTINUOUS	FND	FOUND	P	POWER	STR, STRUCT	STRUCTURE
COR	CORNER	FDTN	FOUNDATION	PP	POWER (UTILITY) POLE	SURF	SURFACING
Cu.Yd.	CUBIC YARD	FT	FEET	PPL	POWER POLE W/ LIGHT	T(1-3)	TOWNSHIP
CULV	CULVERT	GA	GAGE	PER	PERPENDICULAR	T, TEL	TELEPHONE
DIA	DIAMETER	GALV	GALVANIZED	PL	PLATE	TEMP	TEMPORARY
DIST	DISTANCE	G V	GAS VALVE	R(1-7)	RANGE	THKN	THICKNESS
DLC	DONATION LAND CLAIM	GAR	GARAGE	REM	REMOVE	TYP SECT	TYPICAL SECTION
DWG	DRAWING	GEN	GENERAL	RT	RIGHT	VAR	VARIABLE
DR	DRIVE	HT	HEIGHT	R/W, ROW	RIGHT OF WAY	VERT	VERTICAL
DWY	DRIVEWAY	HWY	HIGHWAY	SAN	SANITARY	W M	WILLAMETTE MERIDIAN
EA	EACH	HORIZ	HORIZONTAL	SECT	SECTION	WAT	WATER
E	EAST	IE	INVERT ELEV	SEW	SEWER	WAT M	WATER METER
EASE	EASEMENT (ALL PURPOSES)	IN PL	IN PLACE	SL	SLOPE	WV	WATER VALVE
ELECT	ELECTRICAL	INST	INSTALL	S	SOUTH	W	WEST
ELEV	ELEVATION	IR	IRON ROD	SE	SOUTHEAST		
		MAX	MAXIMUM	SW	SOUTHWEST		

LEGEND

TUALATIN RIVER (SW PETES MOUNTAIN RD)
BRIDGE APPROACH REPAIR PROJECT

CLACKAMAS COUNTY
DEPT. OF TRANSPORTATION
AND DEVELOPMENT
150 BEAVERCREEK ROAD
OREGON CITY, OR 97045

DAN JOHNSON
DIRECTOR

DESIGNED BY: JH
DRAFTED BY: JH
CHECKED BY: DTD

REVISIONS

NO. DATE:

--	--	--	--	--

Sheet No. 1A

PROJECT NO.: CI-22259
DATE: APRIL 2018

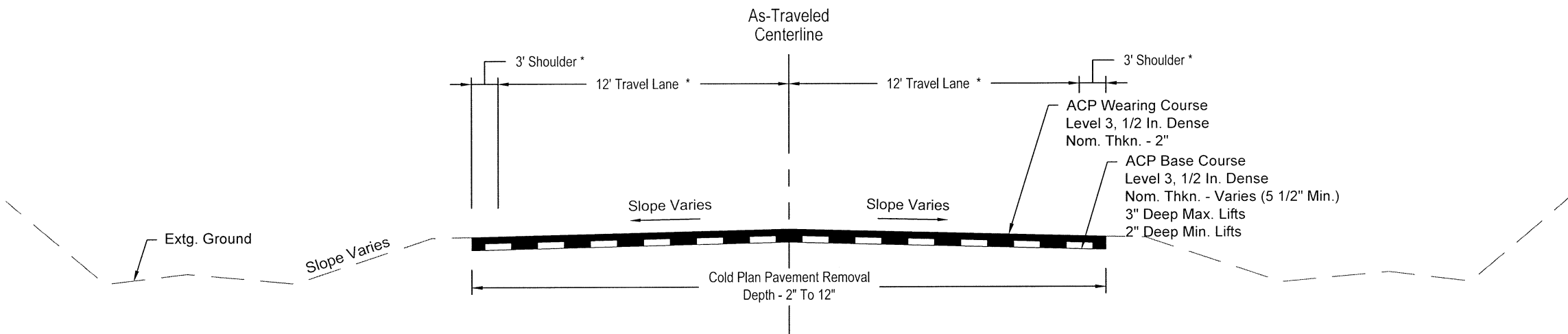

SW PETES MOUNTAIN RD
(MINOR ARTERIAL)
(Not To Scale)

* Travel Lane and Shoulder Widths Vary - See Sheets 3 & 4 For Cold Plane Pavement Removal and Paving Limits.



TYPICAL SECTIONS	
TUALATIN RIVER (SW PETES MOUNTAIN RD) BRIDGE APPROACH REPAIR PROJECT	
DATE: APRIL 2018 PROJECT NO.: CI-22259	
CLACKAMAS COUNTY DEPT. OF TRANSPORTATION AND DEVELOPMENT 150 BEAVERCREEK ROAD OREGON CITY, OR 97045	DIRECTOR DAN JOHNSON
DESIGNED BY: JH	DRAFTED BY: JH
CHECKED BY: DTD	
REVISIONS	
NO DATE:	
Sheet No.	2A

1. Locate As Directed By The Engineer.

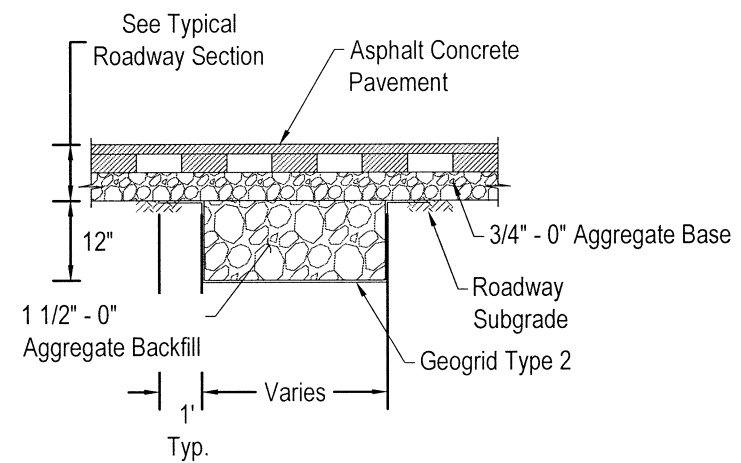

12 INCH SUBGRADE STABILIZATION
Not to Scale

REGISTERED PROFESSIONAL
ENGINEER
86225PE
Jonathan Hangartner
OREGON
MARCH 14, 2017
JONATHAN HANGARTNER
EXPIRES 06-30-2019

CONSTRUCTION DETAILS

TUALATIN RIVER (SW PETES MOUNTAIN RD))
BRIDGE APPROACH REPAIR PROJECT

DATE: APRIL 2018	PROJECT NO.: CI-22259
------------------	-----------------------

CLACKAMAS COUNTY
DEPT. OF TRANSPORTATION
AND DEVELOPMENT
150 BEAVERCREEK ROAD
OREGON CITY, OR 97045



DIRECTOR

DAN JOHNSON

DESIGNED BY:
JH

DRAFTED BY: _____ **JH**

JH

DRAFTED BY:

CHECKED BY:
DTD

REVISIONS

NO.	DATE:
-----	-------

Sheet No.

2B

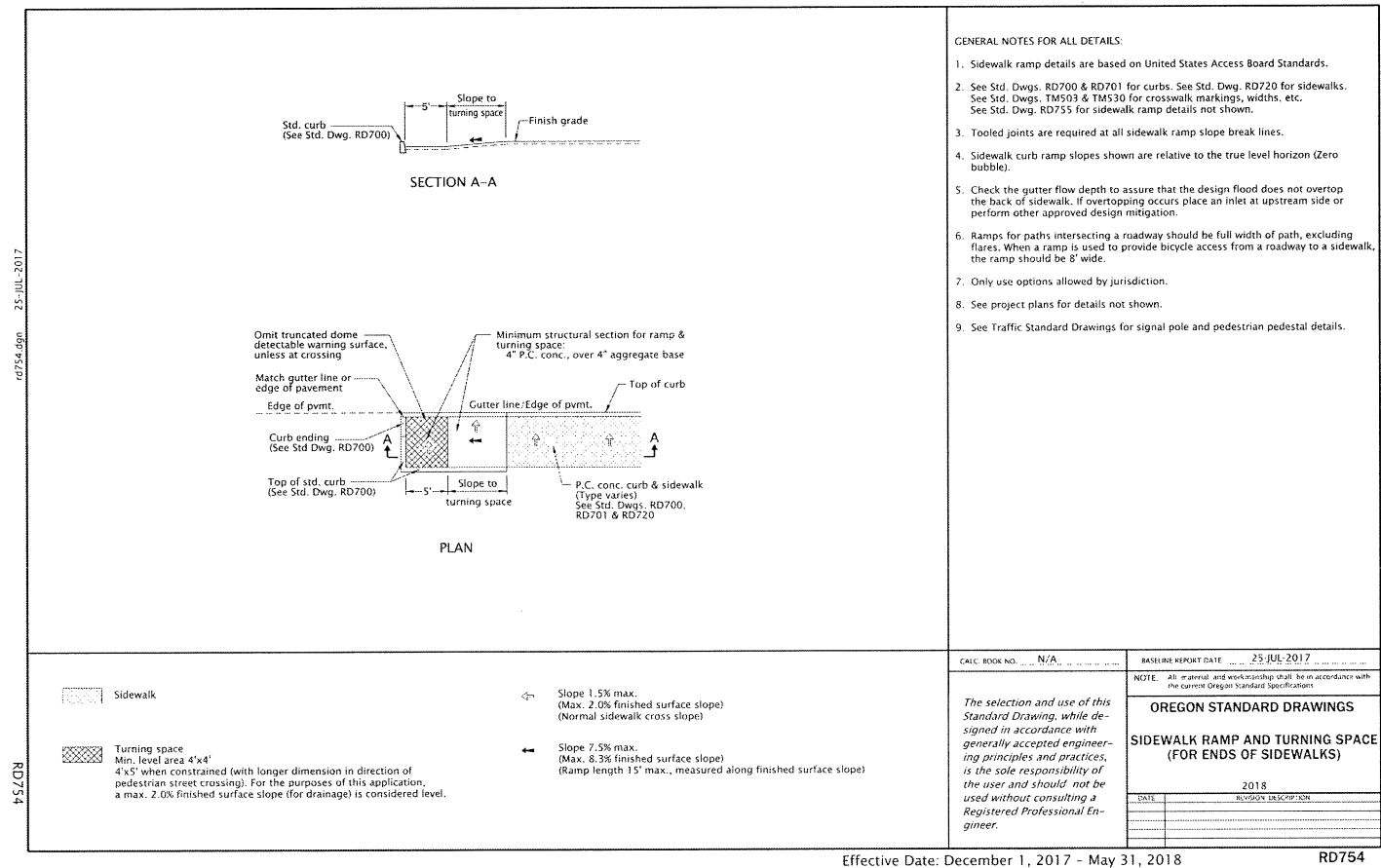
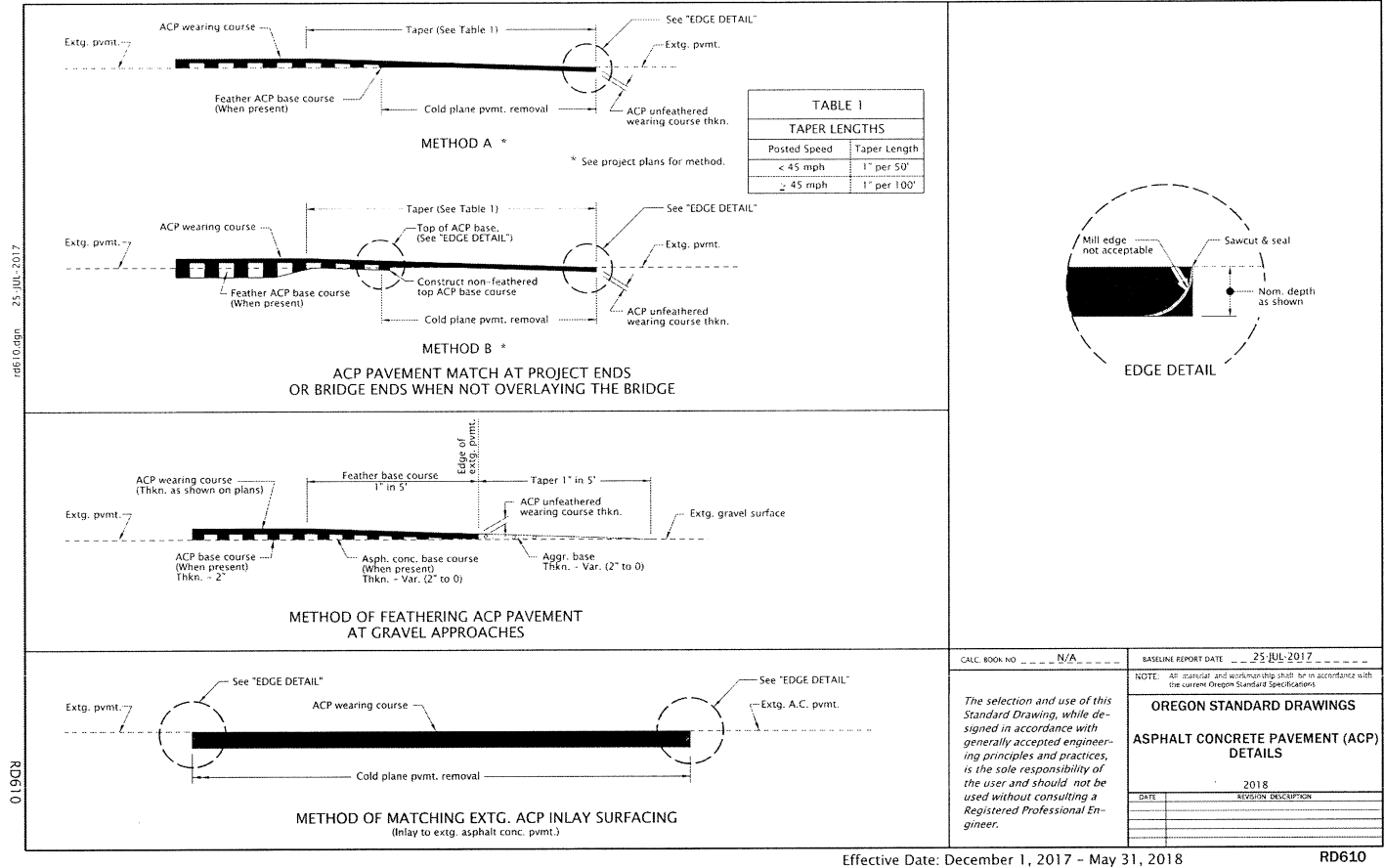

CONSTRUCTION DETAILS

TUALATIN RIVER (SW PETES MOUNTAIN RD)
BRIDGE APPROACH REPAIR PROJECT

CLACKAMAS COUNTY
DEPT. OF TRANSPORTATION AND DEVELOPMENT
150 BEAVERCREEK ROAD
OREGON CITY, OR 97045

DIRECTOR
DAN JOHNSON

DESIGNED BY: JH
DRAFTED BY: JH
CHECKED BY: DTD

REVISIONS

NO.	DATE:	DESCRIPTION

Sheet No. 2B-2

PROJECT NO.: CI-22259
DATE: APRIL 2018

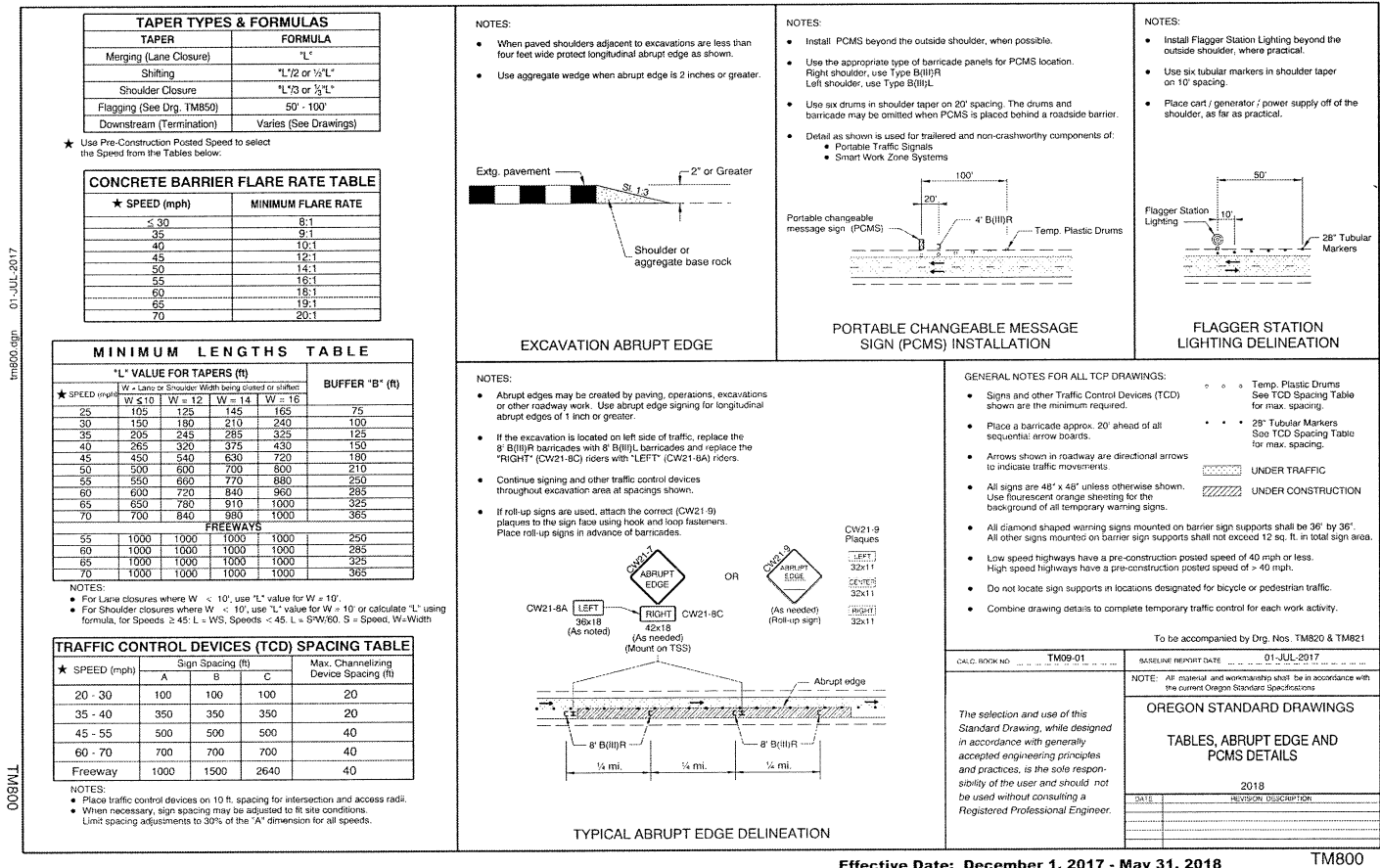
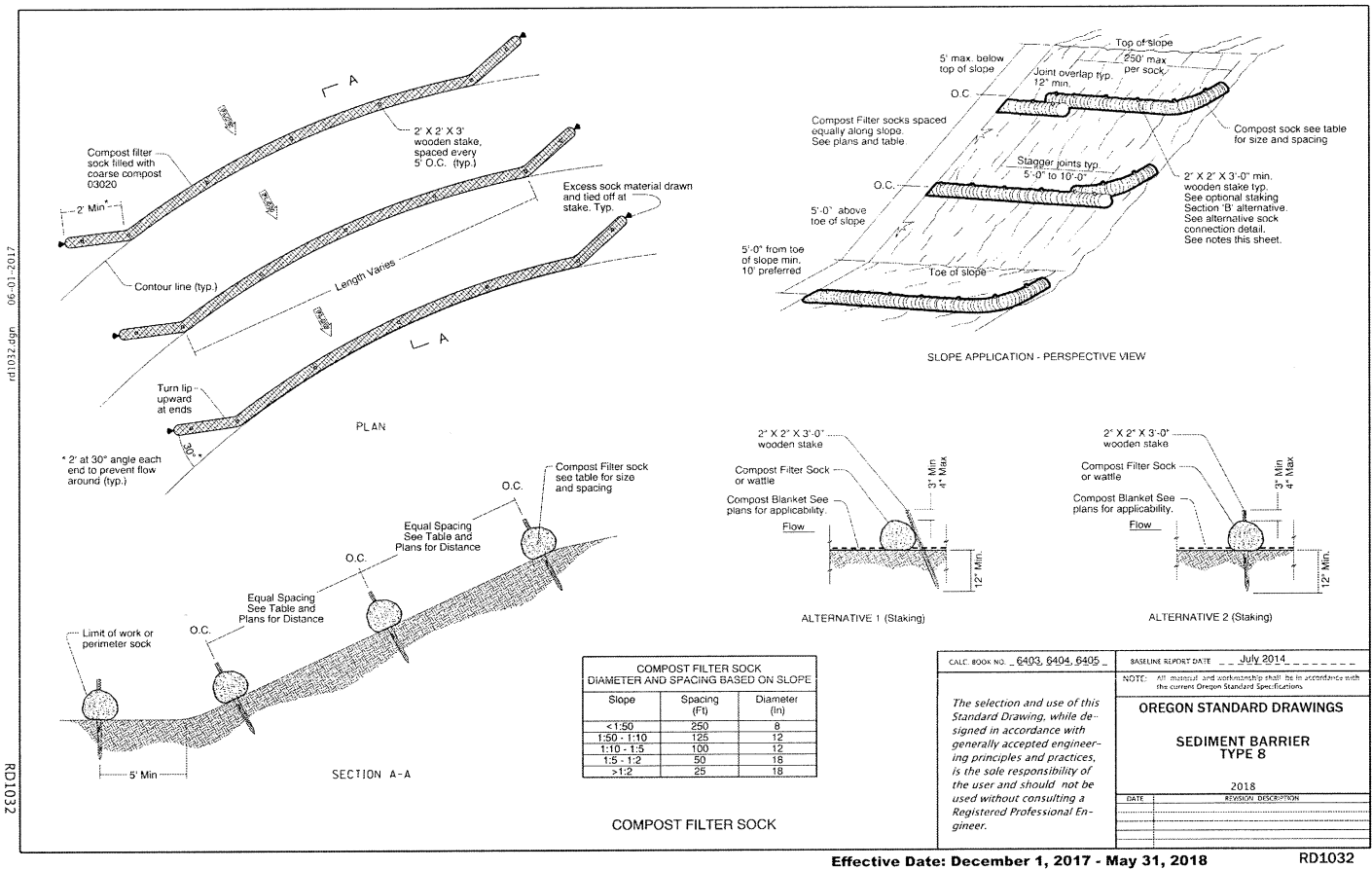

CLACKAMAS COUNTY
DEPT. OF TRANSPORTATION
AND DEVELOPMENT
150 BEAVERCREEK ROAD
OREGON CITY, OR 97045

CLACKAMAS COUNTY

DAN JOHNSON
DIRECTOR

DESIGNED BY: JH
DRAFTED BY: JH
CHECKED BY: JH
DTD

REVISIONS

NO DATE: 2B-3

Sheet No. 2B-3

CONSTRUCTION DETAILS

TUALATIN RIVER (SW PETES MOUNTAIN RD)
BRIDGE APPROACH REPAIR PROJECT

DATE: APRIL 2018 PROJECT NO.: CI-22259

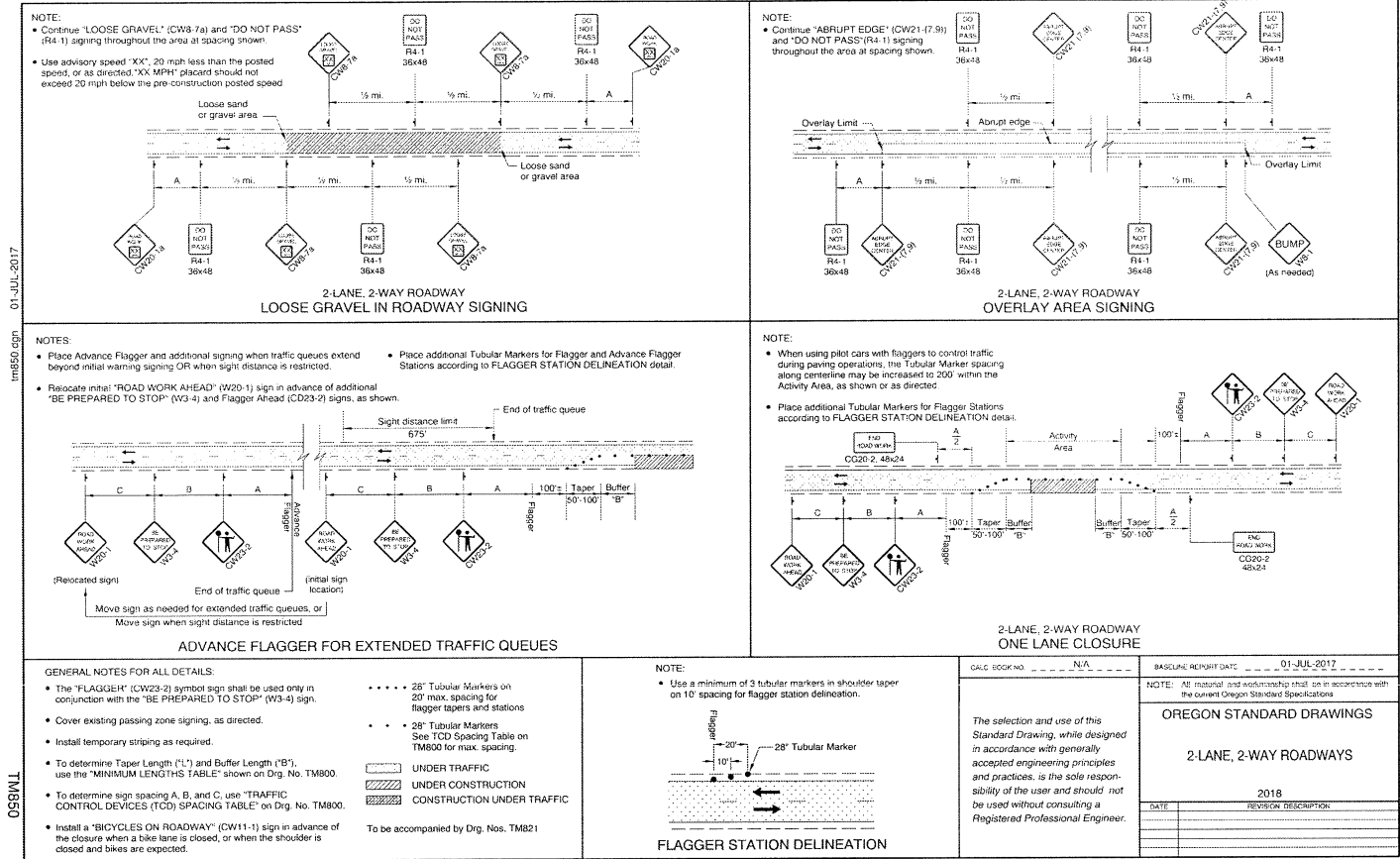

CONSTRUCTION DETAILS

TUALATIN RIVER (SW PETES MOUNTAIN RD)
BRIDGE APPROACH REPAIR PROJECT

DATE: APRIL 2018 PROJECT NO.: CI-22259

CLACKAMAS COUNTY
DEPT. OF TRANSPORTATION
AND DEVELOPMENT
150 BEAVERCREEK ROAD
OREGON CITY, OR 97045

DIRECTOR
DAN JOHNSON

DESIGNED BY: JH
DRAFTED BY: JH
CHECKED BY: DTD

REVISIONS		NO.	DATE:	



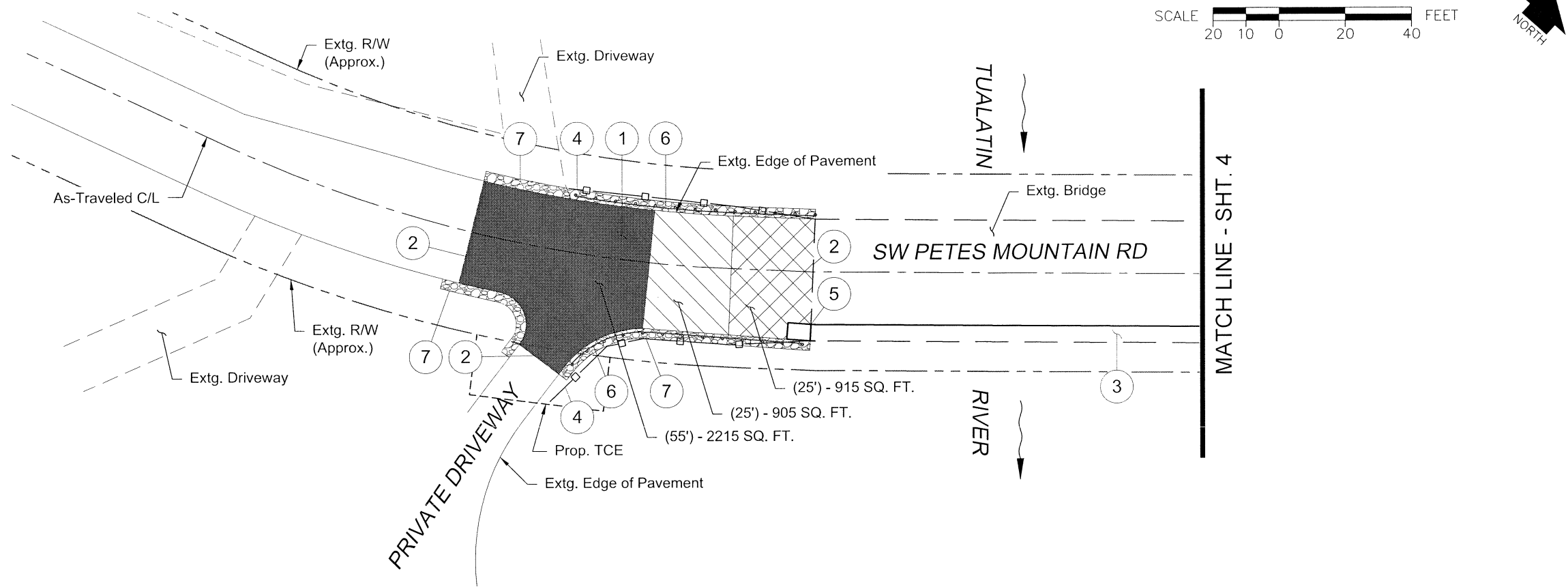

CONSTRUCTION NOTES

- 1 Cold Plane Pavement Removal
2 To 12 Inches Deep
- 2 Sawcut & Match Extg. Pavement
Install AC Pavement Match
(For Details, See Sht. 2B-2)
- 3 Preserve & Protect Extg.
Concrete Curb & Sidewalk
- 4 Install Sediment Barrier, Type 8 - 165'
(For Details, See Sht. 2B-3)
- 5 Remove Extg. AC Ramp
Install Sidewalk Ramp and Turning Space
With Truncated Dome
(For Details, See Sht. 2B-2)
- 6 Preserve & Protect Extg. Guardrail
- 7 Preparation of Shoulders
Install 3/4" - 0" Aggregate Shoulder
3'-0" Wide Aggregate Shoulder
Nom. Comp. Thkn. - 6"

LEGEND

12" +/- Cold Plane Pavement Removal
And Sawcut/Or Excavate and Replace
With 10" ACP Base Course (3 Lifts)
2" ACP Wearing Course



9" +/- Cold Plane Pavement Removal
And Sawcut/Or Excavate and Replace
With 7" ACP Base Course (3 Lifts)
2" ACP Wearing Course



2" Cold Plane Pavement Removal
And Replace With
2" ACP Wearing Course



ALIGNMENT & GENERAL CONSTRUCTION
TUALATIN RIVER (SW PETES MOUNTAIN RD)
BRIDGE APPROACH REPAIR PROJECT

DATE: APRIL 2018 PROJECT NO.: CI-22259

CLACKAMAS COUNTY
DEPT. OF TRANSPORTATION
AND DEVELOPMENT
150 BEAVERCREEK ROAD
OREGON CITY, OR 97045

DIRECTOR
DAN JOHNSON

DESIGNED BY: JH
DRAFTED BY: JH
CHECKED BY: DTD

REVISIONS

NO	DATE	DESCRIPTION
1		
2		
3		
4		
5		
6		
7		

Sheet No. **3**

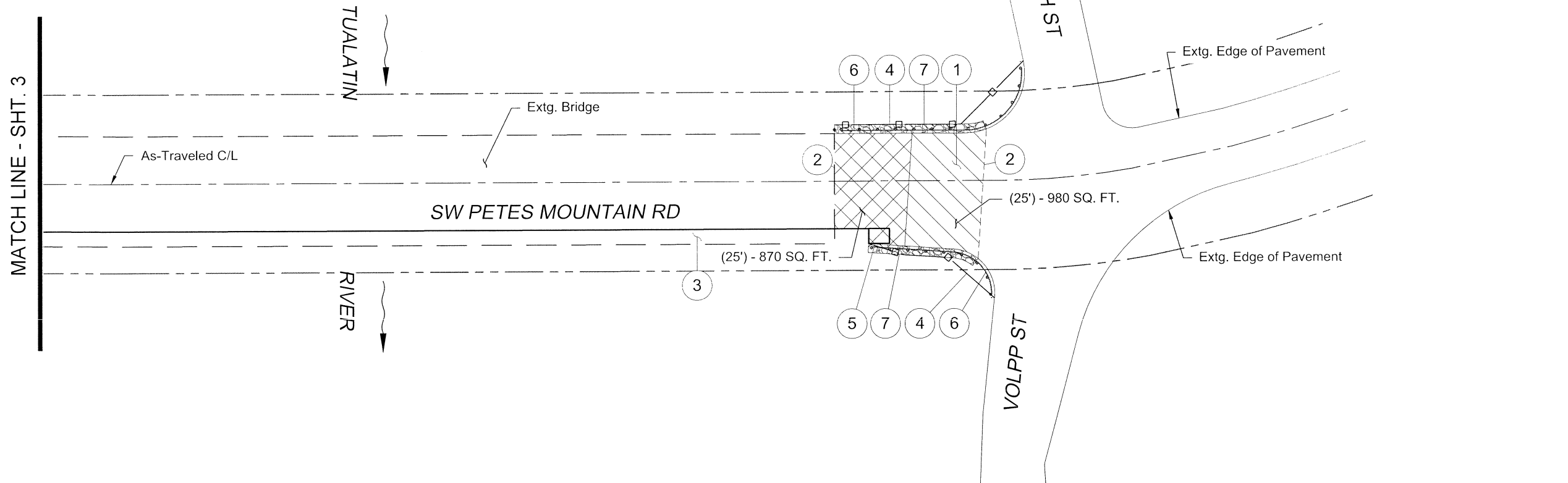

CONSTRUCTION NOTES

- 1 Cold Plane Pavement Removal
2 To 12 Inches Deep
- 2 Sawcut & Match Extg. Pavement
Install AC Pavement Match
(For Details, See Sht. 2B-2)
- 3 Preserve & Protect Extg.
Concrete Curb & Sidewalk
- 4 Install Sediment Barrier, Type 8 - 120'
(For Details, See Sht. 2B-3)
- 5 Remove Extg. AC Ramp
Install Sidewalk Ramp and Turning Space
With Truncated Dome
(For Details, See Sht. 2B-2)
- 6 Preserve & Protect Extg. Guardrail
- 7 Preparation of Shoulders
Install 3/4" - 0" Aggregate Shoulder
3'-0" Wide Aggregate Shoulder
Nom. Comp. Thkn. - 6"

LEGEND

- 12" +/- Cold Plane Pavement Removal
And Sawcut/Or Excavate and Replace
With 10" ACP Base Course (3 Lifts)
2" ACP Wearing Course
- 9" +/- Cold Plane Pavement Removal
And Sawcut/Or Excavate and Replace
With 7" ACP Base Course (3 Lifts)
2" ACP Wearing Course



ALIGNMENT & GENERAL CONSTRUCTION

TUALATIN RIVER (SW PETES MOUNTAIN RD)
BRIDGE APPROACH REPAIR PROJECT

DATE: APRIL 2018 PROJECT NO.: CI-22259

CLACKAMAS COUNTY
DEPT. OF TRANSPORTATION
AND DEVELOPMENT
150 BEAVERCREEK ROAD
OREGON CITY, OR 97045

DIRECTOR
DAN JOHNSON

DESIGNED BY: JH
DRAFTED BY: JH
CHECKED BY: DTD

NO. DATE:

REVISIONS

Sheet No. 4

MATCH LINE - SEE ABOVE

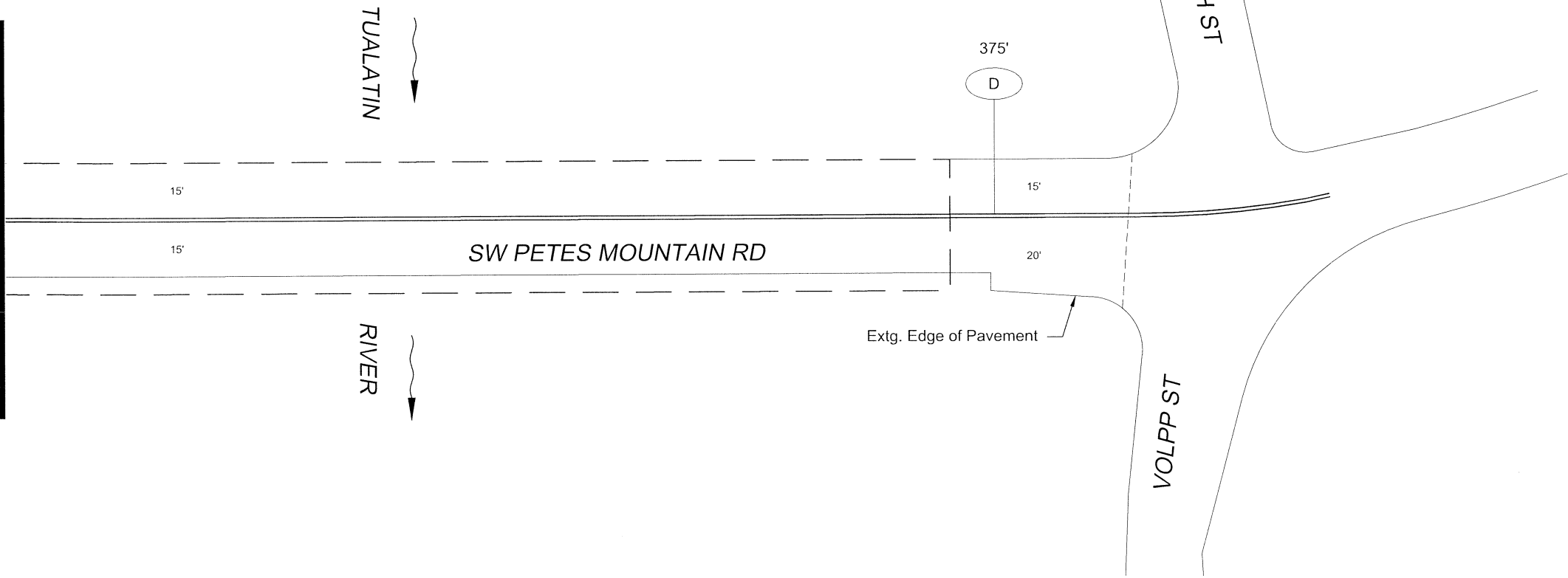

- W Install 4" White Line
- D Install Double No-Pass Two 4" Yellow Lines
- D R-20 Install Double No-Pass Positioning Guide Reflectors (Bi-Directional Recessed) With Two 4" Yellow Lines

Notes:
See Shts. SS-3 Thru SS-5 For Striping Details.
All existing signs shall be preserved and protected.

SCALE 20 10 0 20 40 FEET

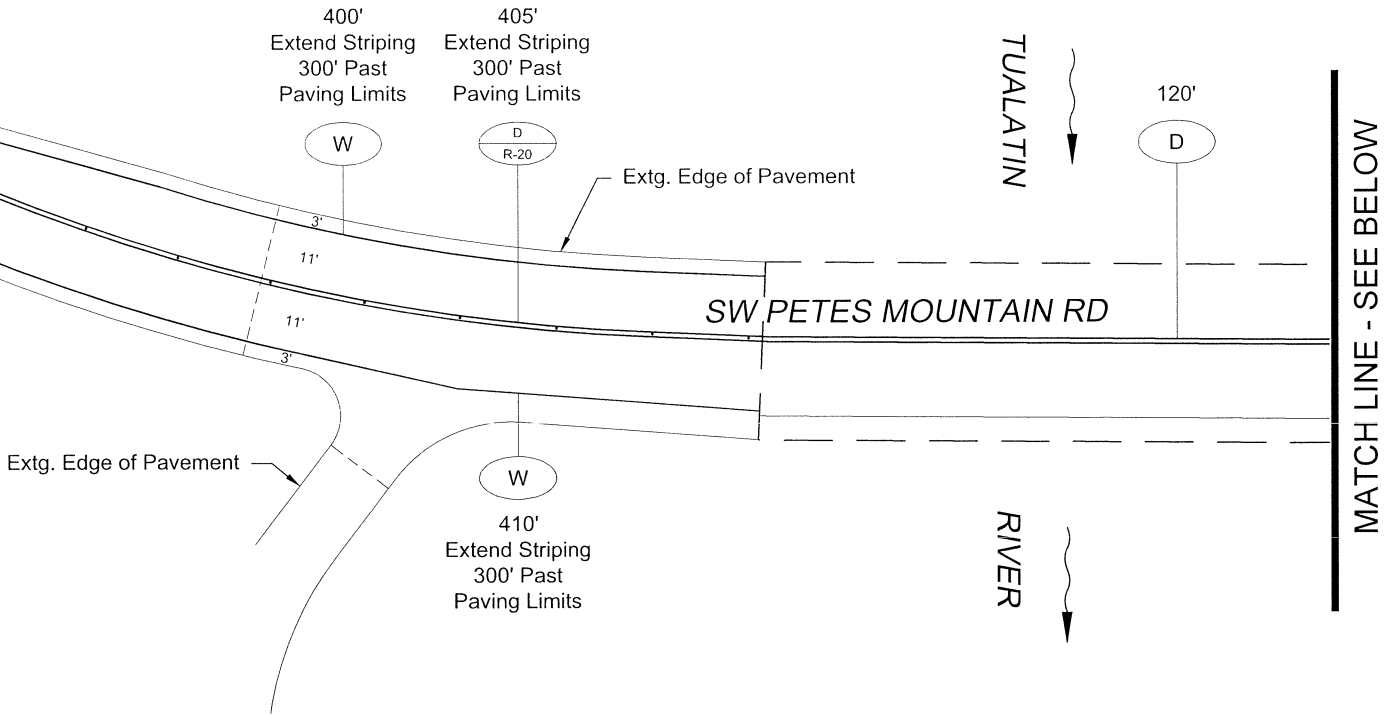

MATCH LINE - SEE BELOW



REVISIONS

NO	DATE	DESIGNED BY	DRAFTED BY	CHECKED BY	DTD
1		JH	JH		
2					
3					
4					
5					

CLACKAMAS COUNTY
DEPT. OF TRANSPORTATION
AND DEVELOPMENT
150 BEAVERCREEK ROAD
OREGON CITY, OR 97045

CLACKAMAS COUNTY

DIRECTOR
DAN JOHNSON

PERMANENT STRIPING PLAN
TUALATIN RIVER (SW PETES MOUNTAIN RD)
BRIDGE APPROACH REPAIR PROJECT

DATE: APRIL 2018 PROJECT NO.: CI-22259

tm500.dgn 07-03-2017

TM500

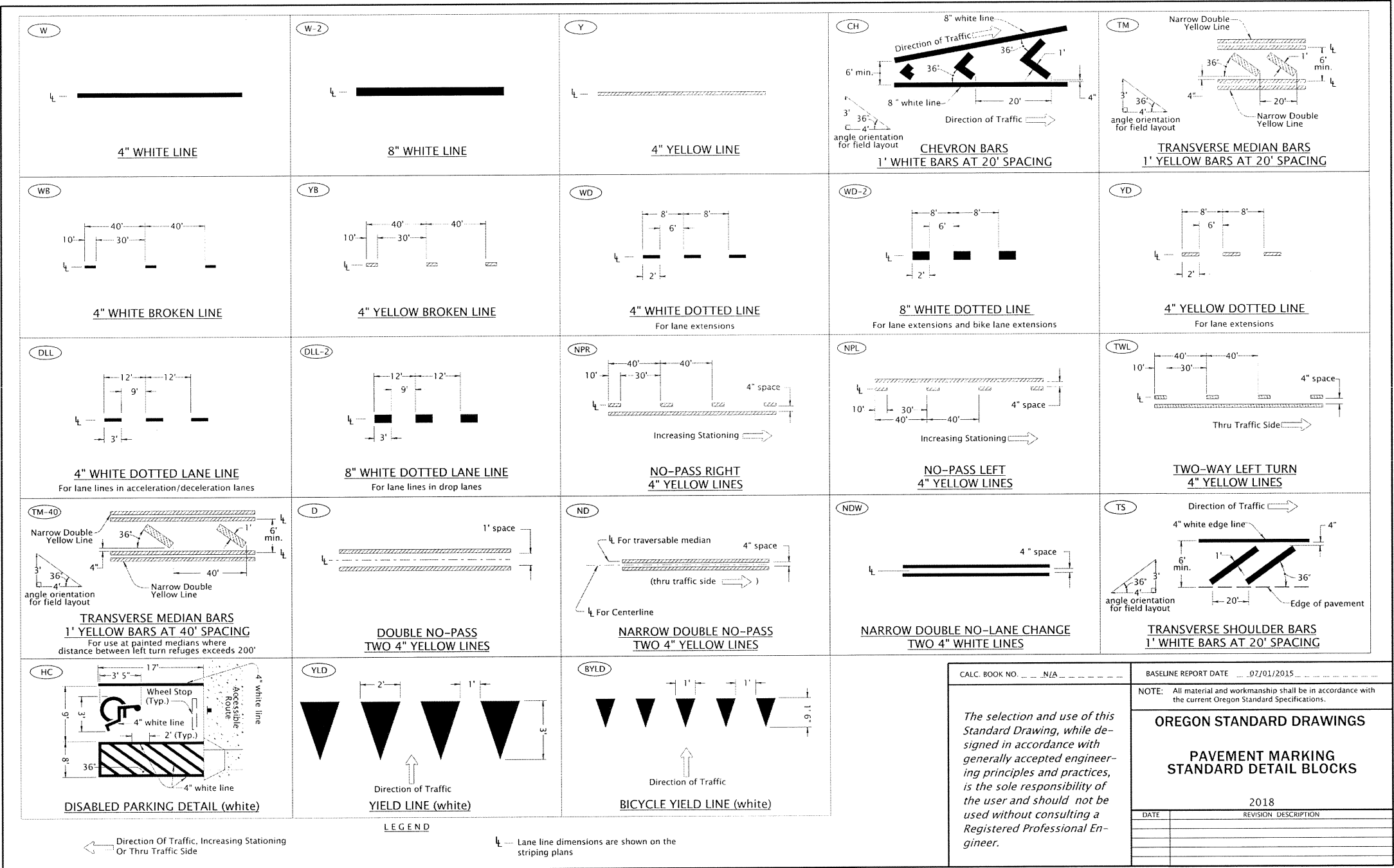

Effective Date: December 01, 2017 - May 31, 2018

TM500



REVISIONS	DESIGNED BY:	JH
	DRAFTED BY:	JH
	CHECKED BY:	DTD
	NO DATE:	
Sheet No. SS-2		

CLACKAMAS COUNTY
DEPT. OF TRANSPORTATION
AND DEVELOPMENT
150 BEAVERCREEK ROAD
OREGON CITY, OR 97045

DAN JOHNSON
DIRECTOR

PERMANENT STRIPING DETAILS

TUALATIN RIVER (SW PETES MOUNTAIN RD)
BRIDGE APPROACH REPAIR PROJECT

DATE: APRIL 2018 PROJECT NO.: CI-22259

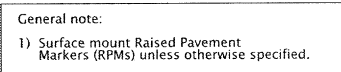

- ← Direction Of Travel, Increasing Stationing or Thru Traffic Side
- └ Lane line dimensions are shown on the striping plans
- ▬ Mono-directional crystal white marker reflects white to the left in this symbol
- ▬ Bi-directional yellow marker reflects yellow both left and right in this symbol

CALC. BOOK NO. N/A	BASELINE REPORT DATE07/01/2015.....	
<p><i>The selection and use of this Standard Drawing, while designed in accordance with generally accepted engineering principles and practices, is the sole responsibility of the user and should not be used without consulting a Registered Professional Engineer.</i></p>	<p>NOTE: All material and workmanship shall be in accordance with the current Oregon Standard Specifications.</p>	
	<p>OREGON STANDARD DRAWINGS</p>	
	<p>PAVEMENT MARKING STANDARD DETAIL BLOCKS</p>	
	<p>2018</p>	
	DATE	REVISION DESCRIPTION

TM502

DESIGNED BY: JH
DRAFTED BY: JH
CHECKED BY: DTD

REVISIONS

NO.	DATE:
-----	-------

Sheet No. **SS-3**

PERMANENT STRIPING DETAILS

CLACKAMAS COUNTY
DEPT. OF TRANSPORTATION
AND DEVELOPMENT
150 BEAVERCREEK ROAD
OREGON CITY OR 97045



CLACKAMAS
COUNTY

DAN JOHNSON
DIRECTOR

DATE: APRIL 2018	PROJECT NO.: CI-22259
------------------	-----------------------



tm517.dgn 07-03-2017

TM517

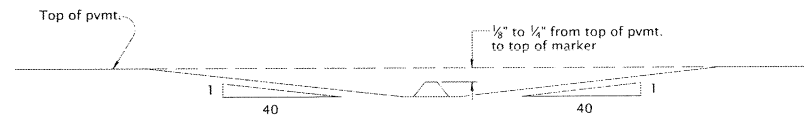
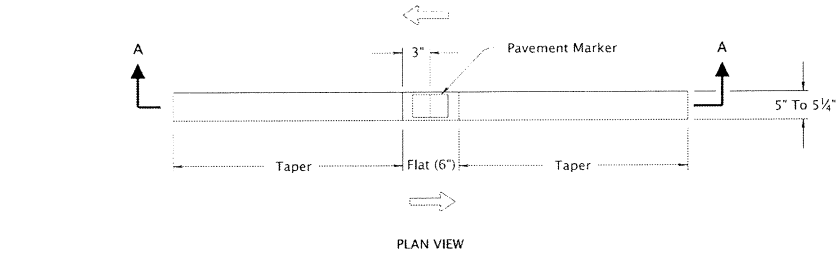

SECTION A - A

BI-DIRECTIONAL RECESSED PAVEMENT MARKER DETAIL

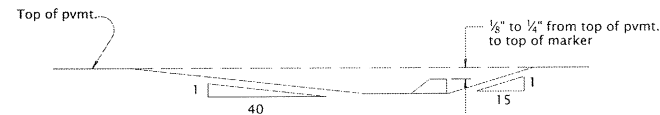
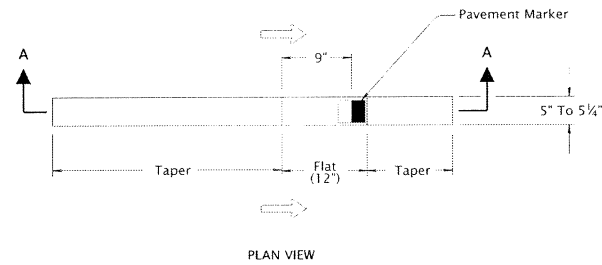

SECTION A - A

MONO-DIRECTIONAL RECESSED PAVEMENT MARKER DETAIL

To be accompanied by Standard Dwg. Nos. TM502 and TM515

CALC. BOOK NO. ... N/A ...	BASELINE REPORT DATE ... 07/01/2015 ...
NOTE: All material and workmanship shall be in accordance with the current Oregon Standard Specifications.	
OREGON STANDARD DRAWINGS	
RECESSED PAVEMENT MARKERS	
2018	
DATE	REVISION DESCRIPTION

The selection and use of this Standard Drawing, while designed in accordance with generally accepted engineering principles and practices, is the sole responsibility of the user and should not be used without consulting a Registered Professional Engineer.

LEGEND

- ← Direction of Travel
- Bi-directional yellow marker reflects yellow both left and right in this symbol
- Mono-directional crystal white marker reflects white to the left in this symbol

Effective Date: December 01, 2017 - May 31, 2018

TM517



REVISIONS

NO.	DATE:			

Sheet No. **SS-4**

CLACKAMAS COUNTY
DEPT. OF TRANSPORTATION
AND DEVELOPMENT
150 BEAVERCREEK ROAD
OREGON CITY, OR 97045

DAN JOHNSON
DIRECTOR

DESIGNED BY:	JH
DRAFTED BY:	JH
CHECKED BY:	DTD

PERMANENT STRIPING DETAILS
TUALATIN RIVER (SW PETES MOUNTAIN RD)
BRIDGE APPROACH REPAIR PROJECT

DATE: APRIL 2018 PROJECT NO.: CI-22259

TM530.dgn 1-3-2017

OC5W1

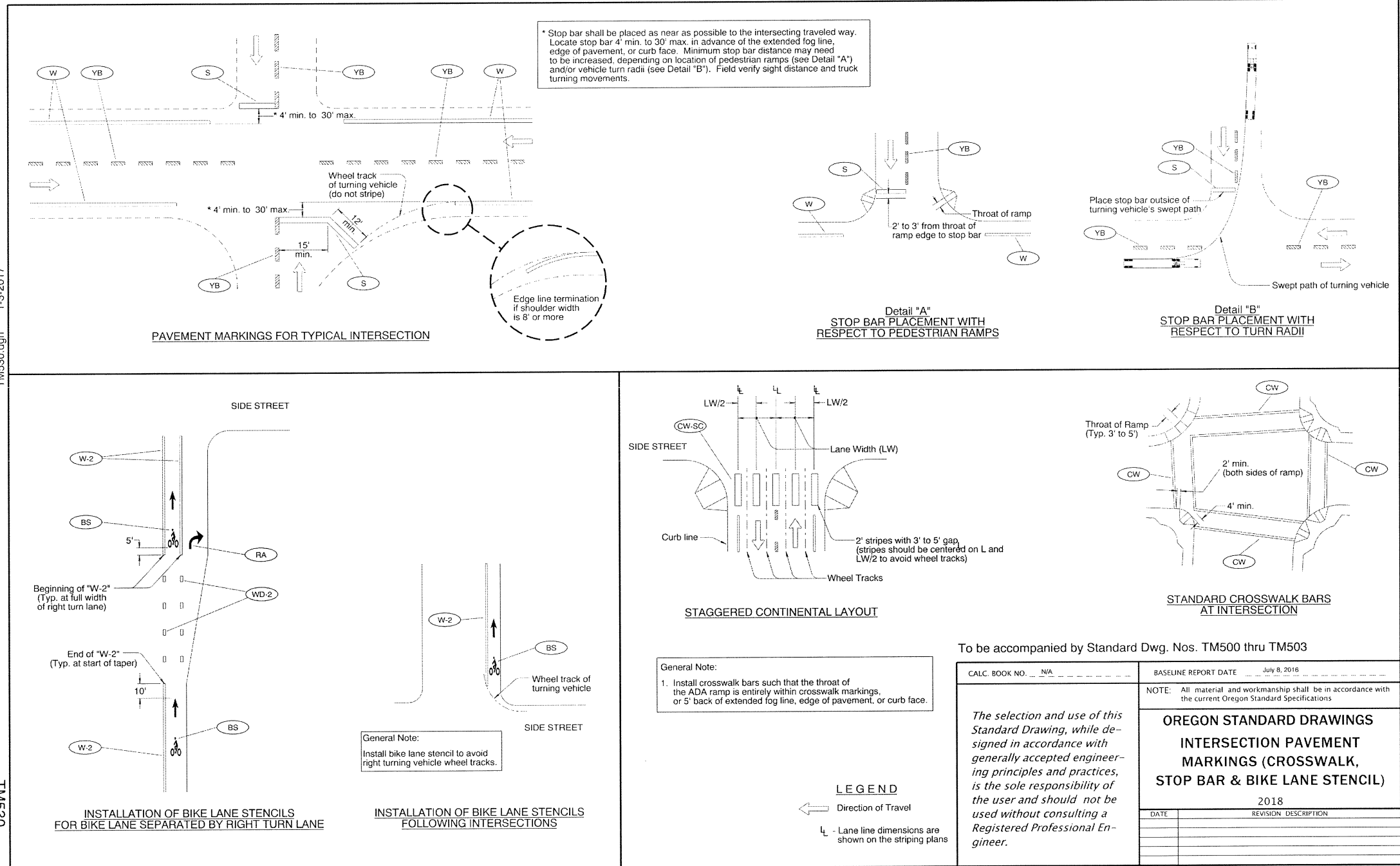

F:\mkg\Traffic\Standard Drawings\2017_July_Update\plotfile\TM200s_500s.dgn :: Default 6/22/2017 1:40:27 PM hwyr20m

Effective Date: December 1, 2017 - May 31, 2018

TM530



PERMANENT STRIPING DETAILS

TUALATIN RIVER (SW PETES MOUNTAIN RD)
BRIDGE APPROACH REPAIR PROJECT

DATE: APRIL 2018 PROJECT NO.: CI-22259

CLACKAMAS COUNTY
DEPT. OF TRANSPORTATION
AND DEVELOPMENT
150 BEAVERCREEK ROAD
OREGON CITY, OR 97045

DIRECTOR
DAN JOHNSON

DESIGNED BY: JH

DRAFTED BY: JH

CHECKED BY: JH

DTD

REVISIONS

NO. DATE:

Sheet No. SS-5